



SUZUKI ***V5125***

PARTS CATALOGUE

2000

.....
RON NG
Parts Manager



INFORMATION
ILLUSTRATION INDEX

1

ENGINE
TRANSMISSION

2

ELECTRICAL

3

BODY

4

PARTS NUMBER INDEX

5

9587C 49860

FIG.1

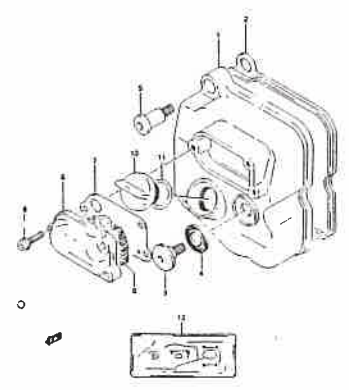

FIG.2

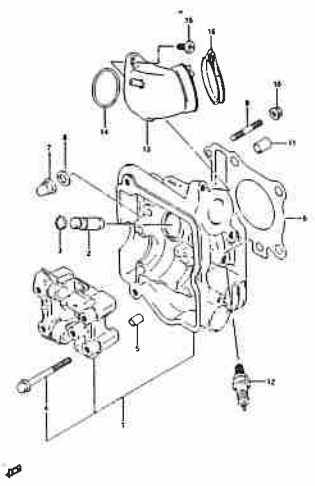

FIG.3

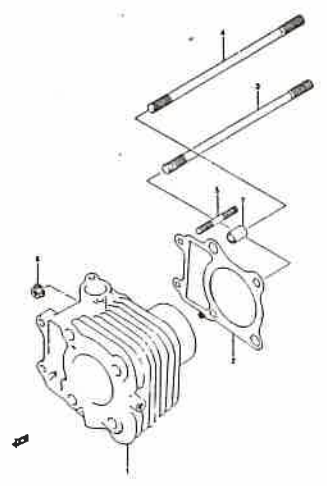

FIG.4

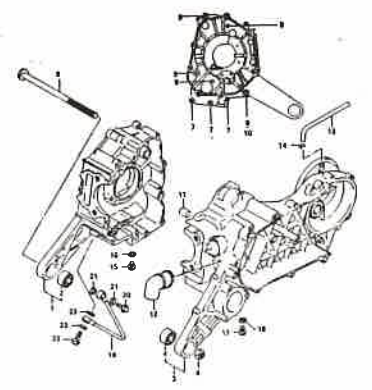

FIG.5

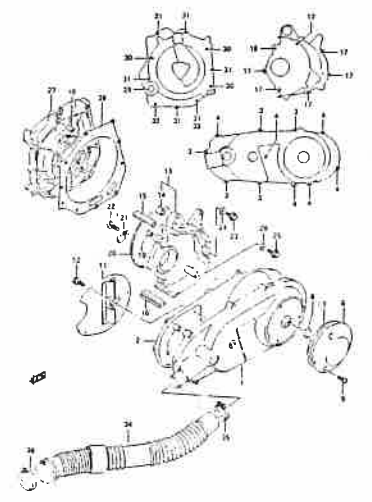

FIG.6

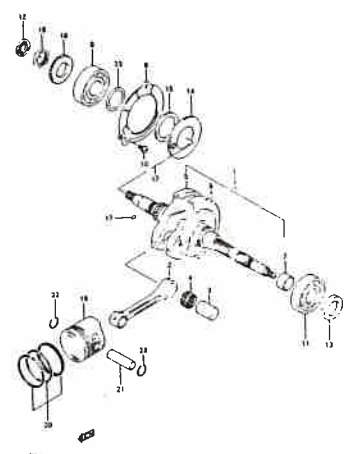

FIG.7

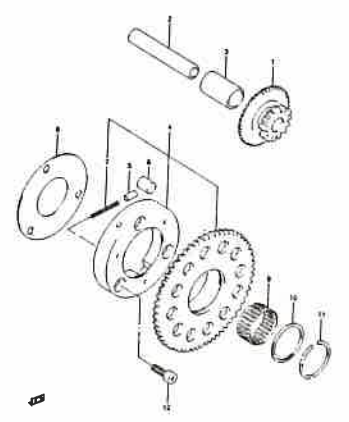

FIG.8

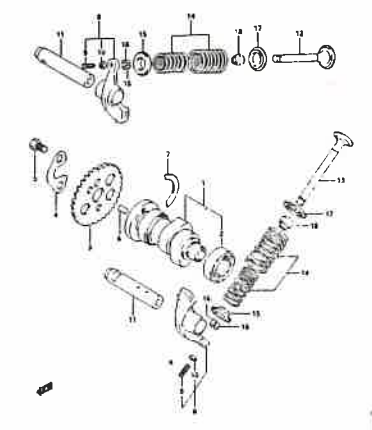

FIG.9

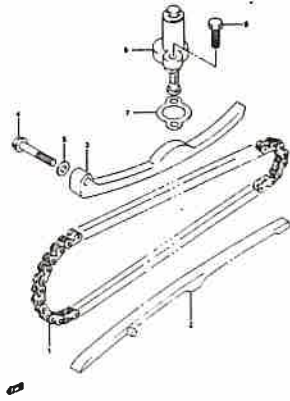

FIG.10

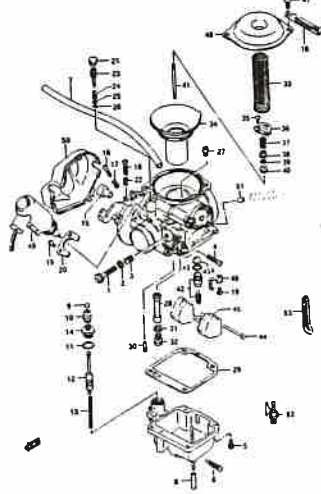

FIG.11

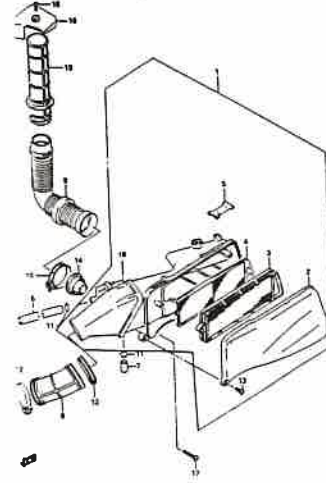

FIG.12

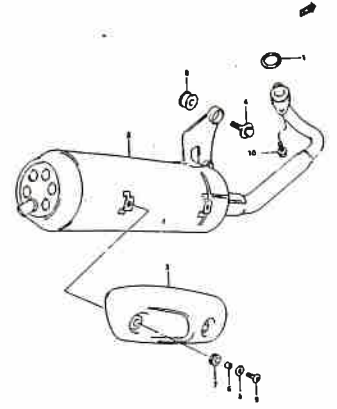

FIG.13

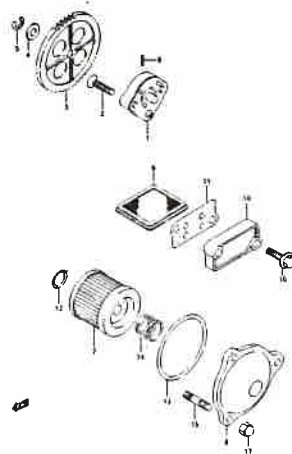

FIG.14

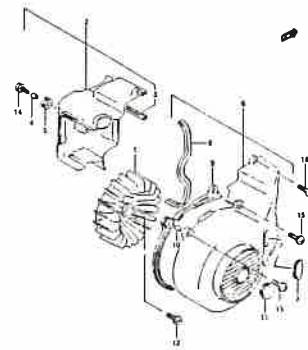

FIG.15

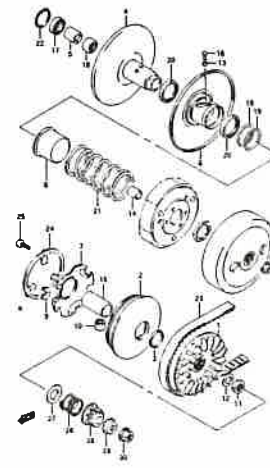

FIG.16

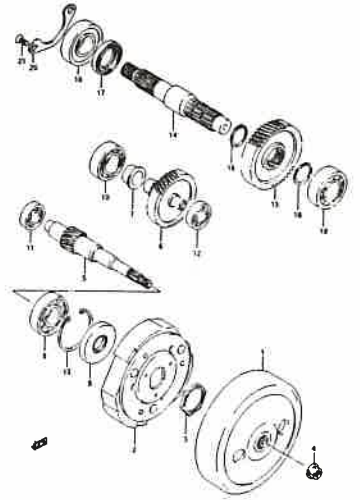

FIG.17

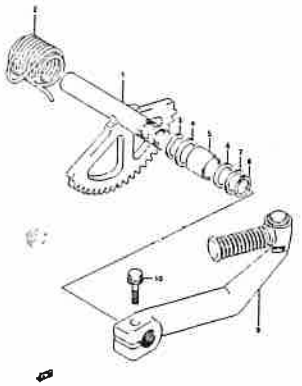

FIG.18

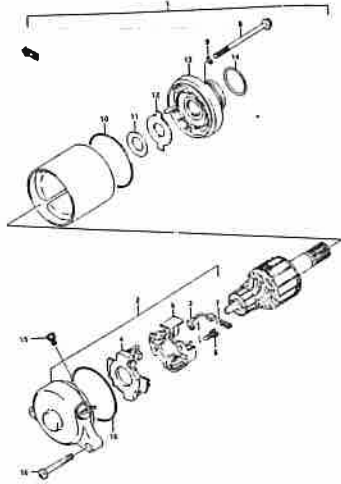

FIG.19

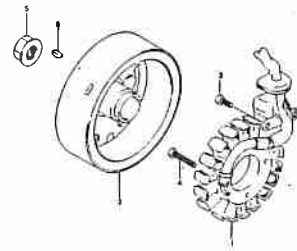

FIG.20

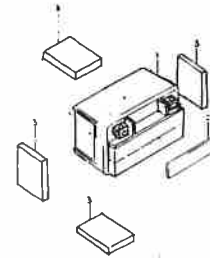

FIG.21

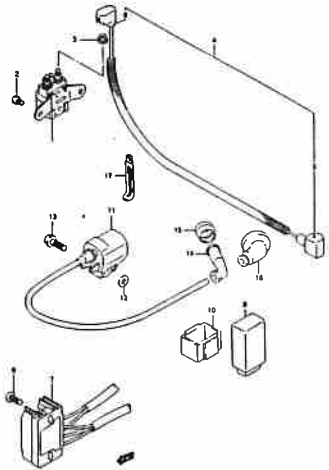

FIG.22

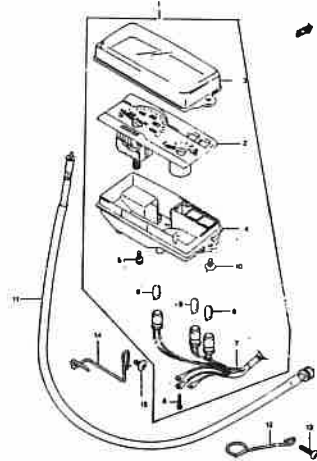

FIG.23

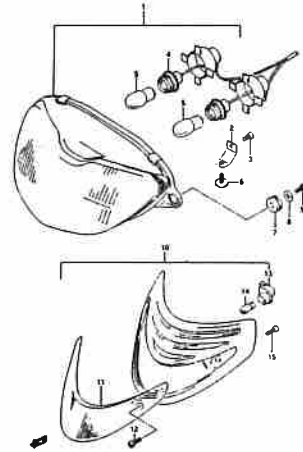

FIG.24

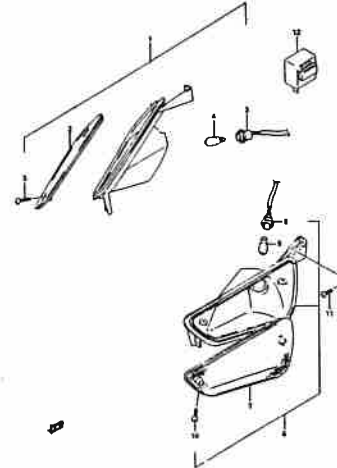

FIG.25

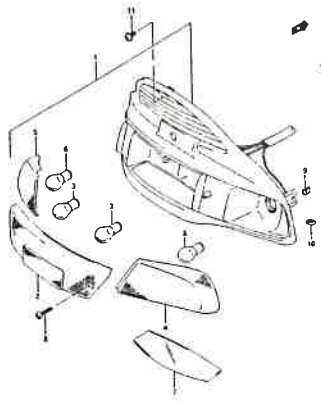

FIG.26

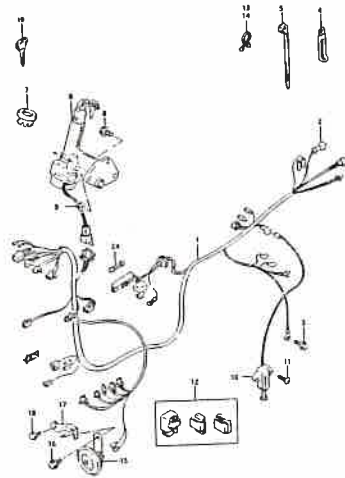

FIG.27

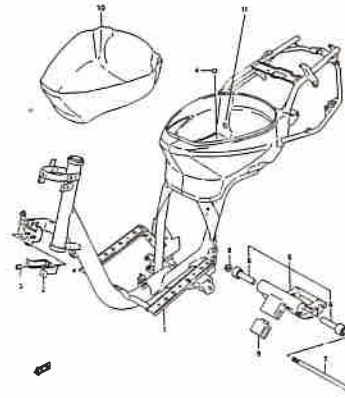

FIG.28

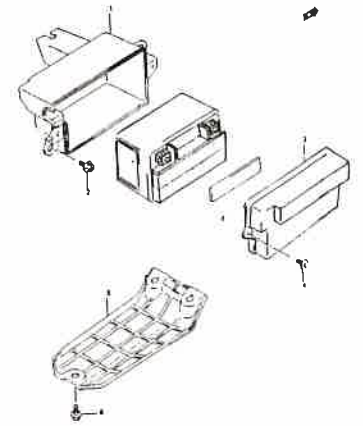

FIG.29

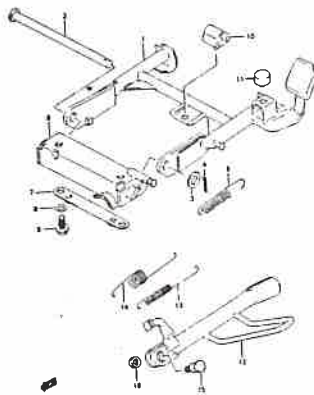

FIG.30

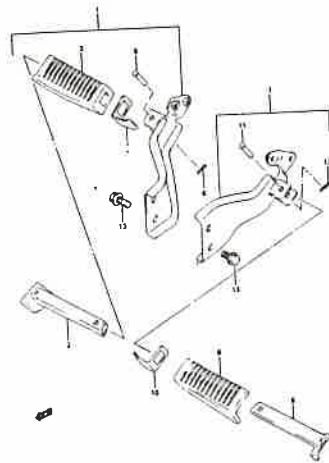

FIG.31

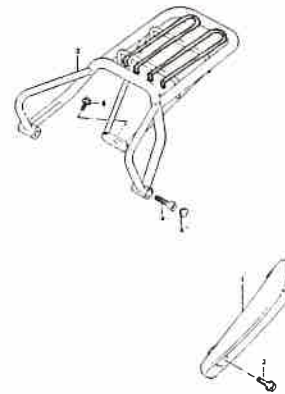

FIG.32

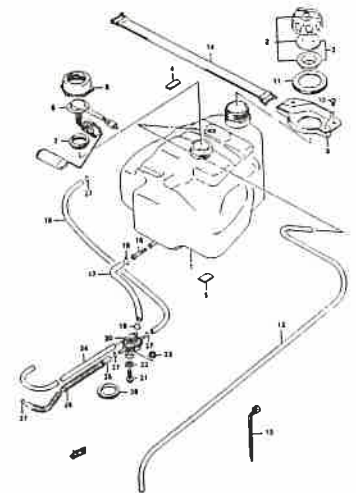

FIG.33

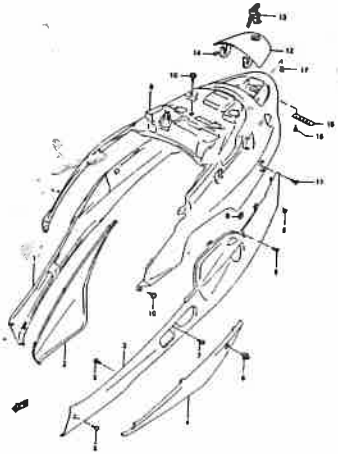

FIG.34

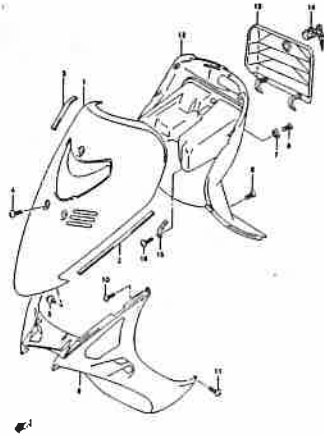

FIG.35

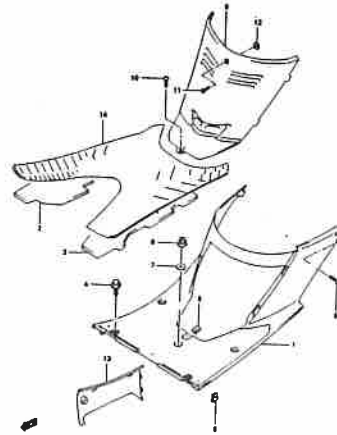

FIG.36

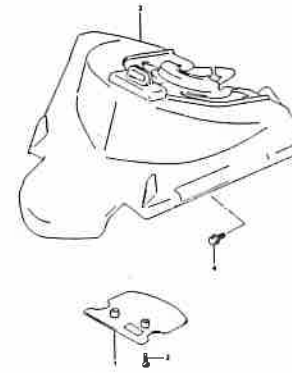

FIG.37

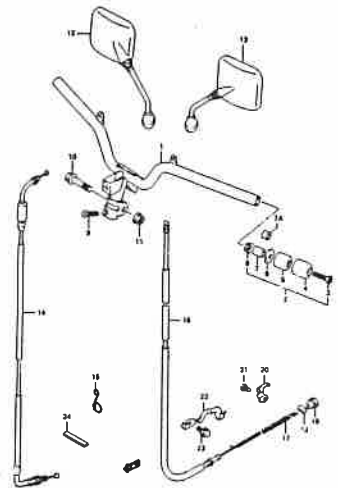

FIG.38

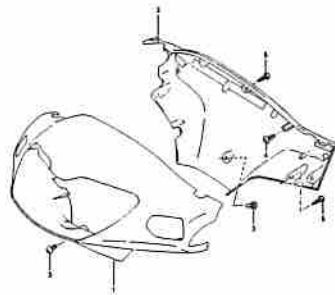

FIG.39

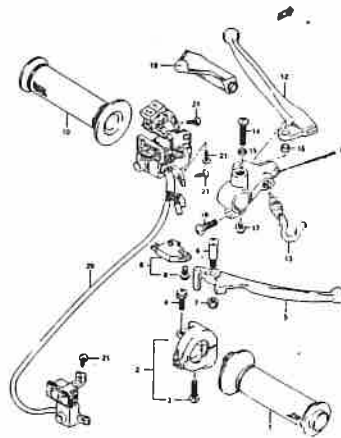

FIG.40

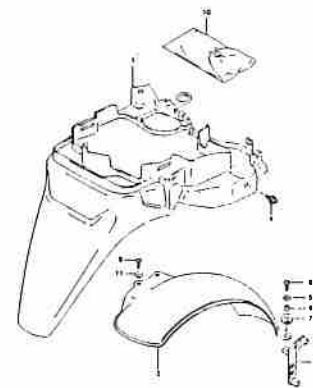

FIG.41

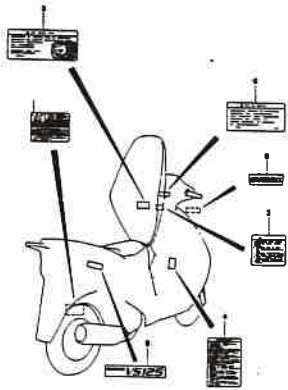

FIG.42

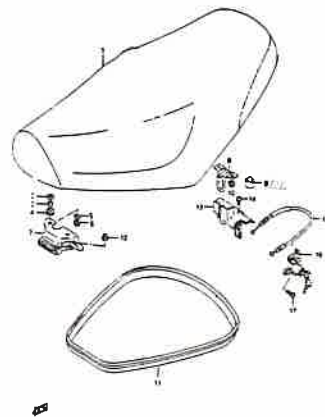

FIG.43

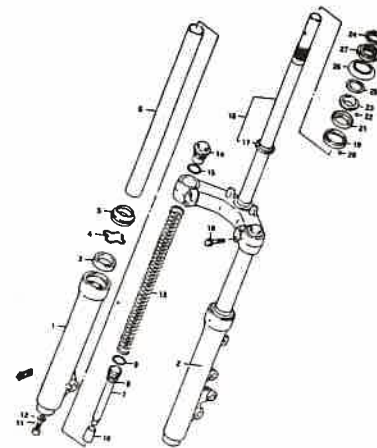

FIG.44

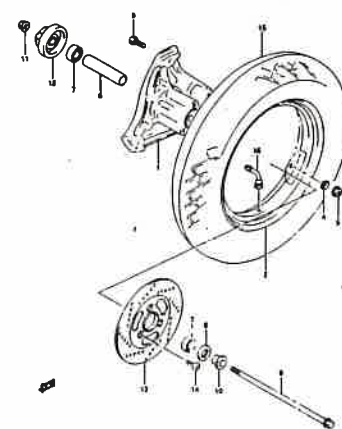

FIG.45

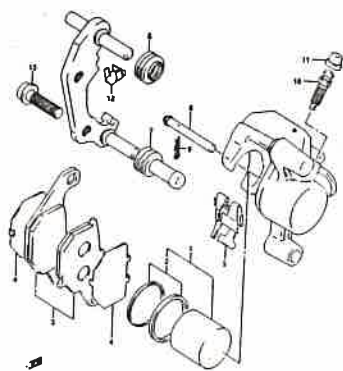

FIG.46

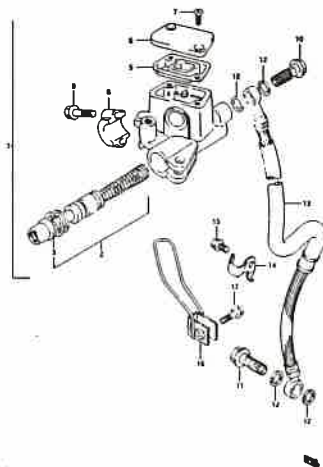

FIG.47

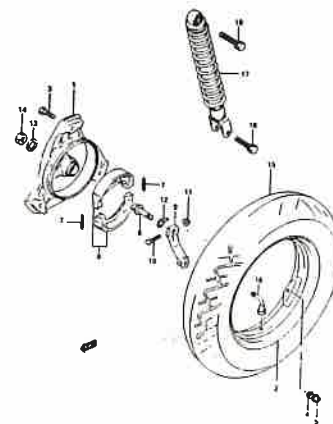
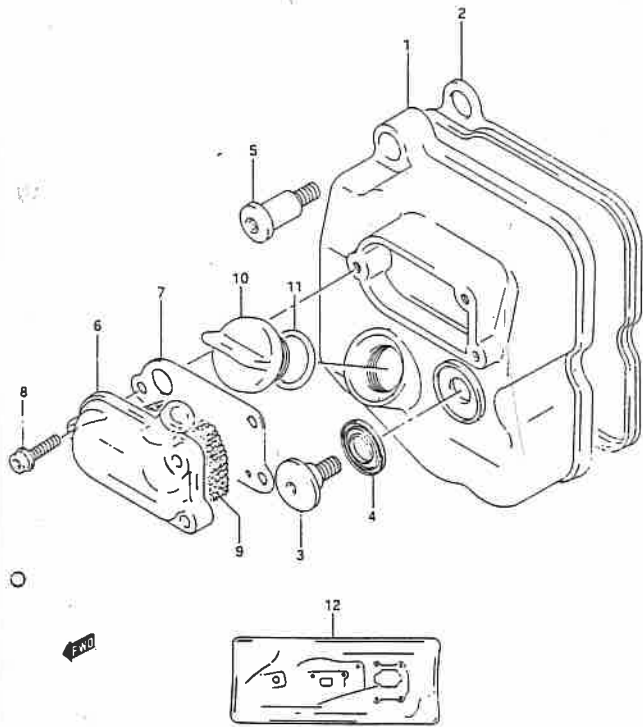

FIG. 1

FIG. 1 (B-2) CYLINDER HEAD COVER

REF. NO.	PART NO.	DESCRIPTION	Q'TY	REMARKS
1	11171-20E10	COVER CYLINDER HEAD	1	
2	11173-20E00	GASKET, cylinder head cover	1	
3	09106-07015	BOLT (7X18.5)	1	
4	09161-11008	WASHER	1	Δ 11191-27E20
5	09106-07017	BOLT (7X31)	2	
6	11176-20E01	COVER, breather	1	
7	11177-20E00	GASKET, breather cover	1	
8	07120-05203	BOLT	3	
9	11186-20E00	SEPARATOR, oil breather	1	
10	09259-20008	PLUG	1	
11	09280-17003	O RING (D: 3.1, ID: 16.8)	1	
12	11401-20841	GASKET SET	1	



2

2

FIG. 2

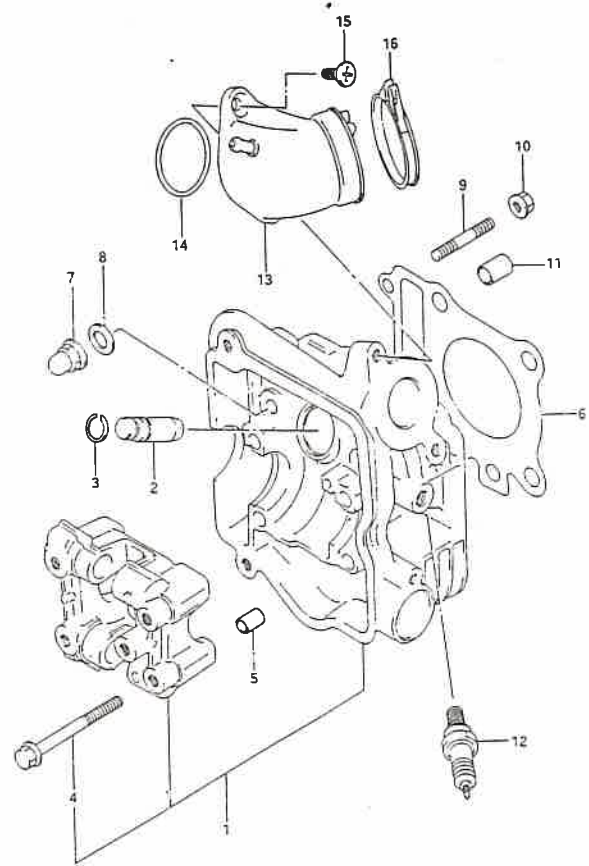

FWD

FIG. 2 (B-3) CYLINDER HEAD

REF. NO.	PART NO.	DESCRIPTION	Q'TY	REMARKS
1	11100-20E20	HEAD ASSY, cylinder	1	
2	11115-20E70	.GUIDE, valve	2	
3	09381-10004	.SNAP RING	2	
4	09103-06102	.BOLT (6x55)	4	
5	09206-08001	.PIN (8x11)	2	
6	11141-20E00	GASKET, cylinder head	1	
7	09159-08049	NUT	4	
8	09168-08021	GASKET (8.5x17x2.3)	4	
9	01421-06253	STUD BOLT	2	
10	08316-10063	NUT	2	
11	04211-11169	PIN	2	
12-1	09482-00516	SPARK PLUG (NGK CR7E)	1	
12-2	09482-00456	SPARK PLUG (NGK CR8E)	1	OPT
13	13110-20E02	PIPE, intake	1	
14	09280-32006	O RING (D: 2. 4, ID: 31. 7)	1	
15	02122-06163	SCREW	2	
16	09402-46208	CLAMP	1	

FIG. 3

FIG. 3 (B-4) CYLINDER

ARKS

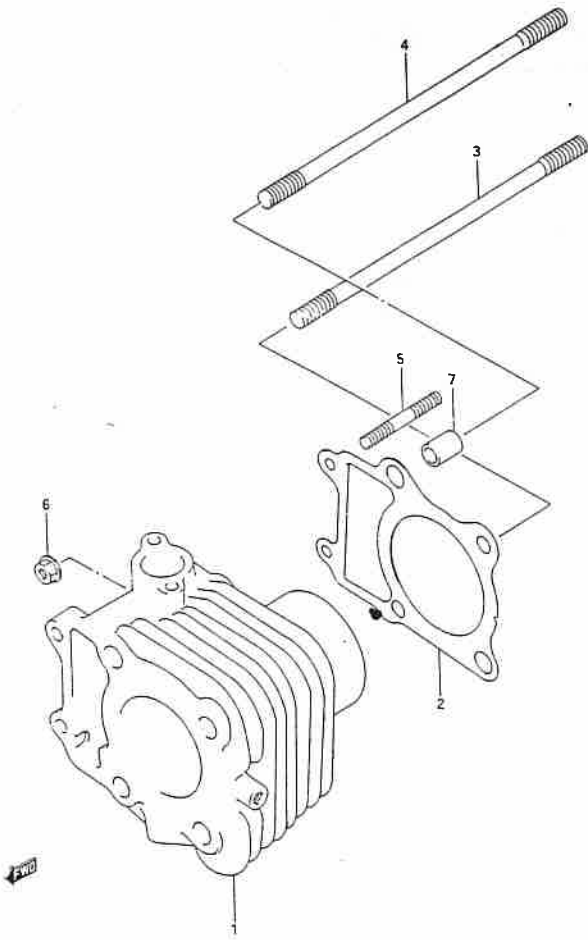

REF. NO.	PART NO.	DESCRIPTION	QTY	REMARKS
1	11210-20E20-0F0	CYLINDER	1	Δ 20E21
2	11241-20E01	GASKET, cylinder	1	
3	09108-08163	STUD BOLT (8x135)	3	
4	09108-08222	STUD BOLT (8x142)	1	
5	01421-06253	STUD BOLT	2	
6	08316-10063	NUT	2	
7	04211-11169	PIN	2	

2

2

FIG. 4

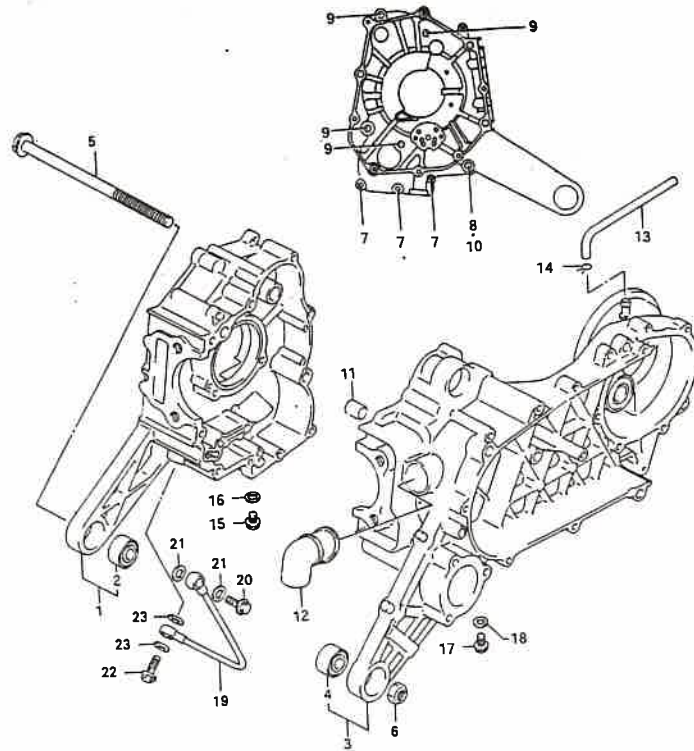

FIG. 4 (B-5) CRANKCASE

REF. NO.	PART NO.	DESCRIPTION	QTY	REMARKS
1	11310-20820	CRANKCASE SET, RH	1	
2	09319-12051	.BUSH (12x30, 1x22)	1	
3	11320-20820	CRANKCASE SET, LH	1	engine # side
4	09319-12051	.BUSH (12x30, 1x22)	1	
5	09103-12046	BOLT (12x204)	1	
6	08310-00123	NUT	1	
7	02112-06503	SCREW	3	
8	07120-08903	BOLT	1	
9	07130-08553	BOLT	4	
10	09168-08016	GASKET	1	
11	04211-13189	KNOCK PIN	2	
12	11325-20E00	TUBE, crankcase	1	
13	09343-07150	HOSE	1	
14	09401-11403	CLIP	1	
15	01500-10163	PLUG	1	
16	09168-10002	GASKET (10x14x3.6)	1	
17	01550-08123	BOLT	1	
18	09168-08015	GASKET (8.2x14x1.6)	1	
19	11280-20E00	PIPE, oil	1	
20	09360-08011	BOLT (8x25)	1	
21	09168-08008	GASKET (8.2x14x1)	2	
22	09360-10032	UNION BOLT	1	
23	09168-10007	GASKET (10.1x16x1)	2	

FIG. 5

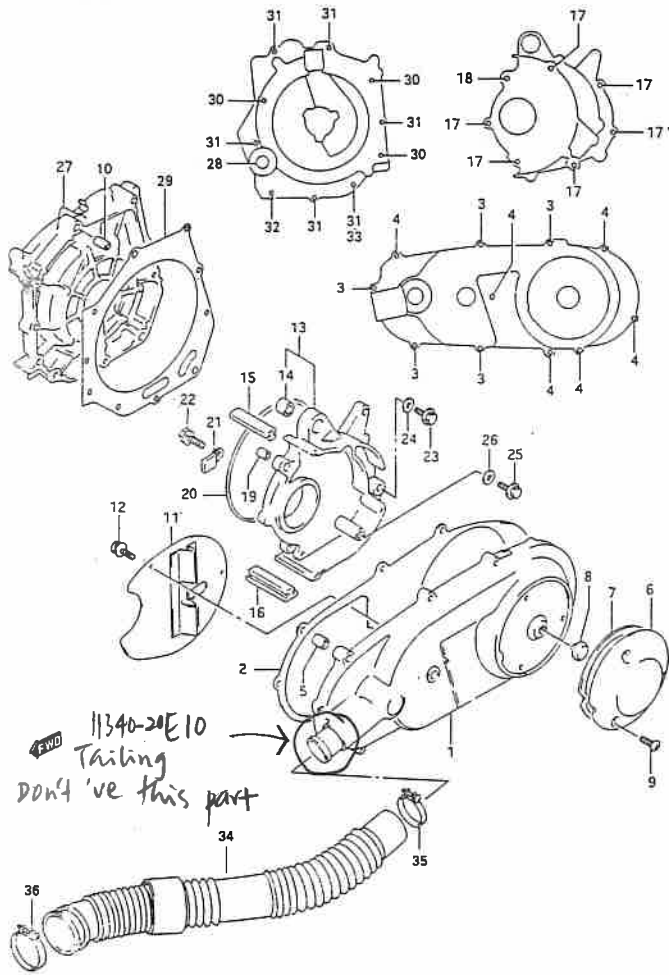

FIG. 5 (B-6) CRANKCASE COVER

REF. NO.	PART NO.	DESCRIPTION	Q'TY	REMARKS
1	11340-20E00	COVER, clutch	1	△ 11340-20E20 Price ↑
2	11482-20E10	GASKET, clutch cover	1	
3	02112-06253	SCREW	5	
4	02112-06403	SCREW	6	
5	04211-11169	PIN	2	
6	11383-20E00	CAP, clutch cover	1	
7	11389-09D00	CUSHION, clutch cover cap	1	
8	09321-10007	CUSHION	1	AN UD = Abolish
9	02112-05123	SCREW	3	
10	04211-11169	PIN	2	
11	11346-20E40	PLATE, clutch cover, air intake	1	
12	09125-05121	SCREW	3	
13	11430-20811	GEAR BOX COVER SET	1	
14	09319-10032	.BUSH	1	
15	11485-20E00	CUSHION, gear box cover upper	1	
16	11486-20E00	CUSHION, gear box cover lower	1	
17	07120-06253	BOLT	6	
18	07120-06353	BOLT	1	
19	09206-11004	PIN	2	
20	09280-00024	O RING (D: 1.8, ID: 134.4)	1	
21	11393-20E00	MAGNETO, gear box	1	
22	01570-06123	BOLT	1	
23	01550-08123	BOLT	1	
24	09168-08008	GASKET (8.2x14x1)	1	
25	01550-06123	BOLT	1	
26	09168-06004	GASKET (6.2x11x1.2)	1	

2

2

FIG. 5

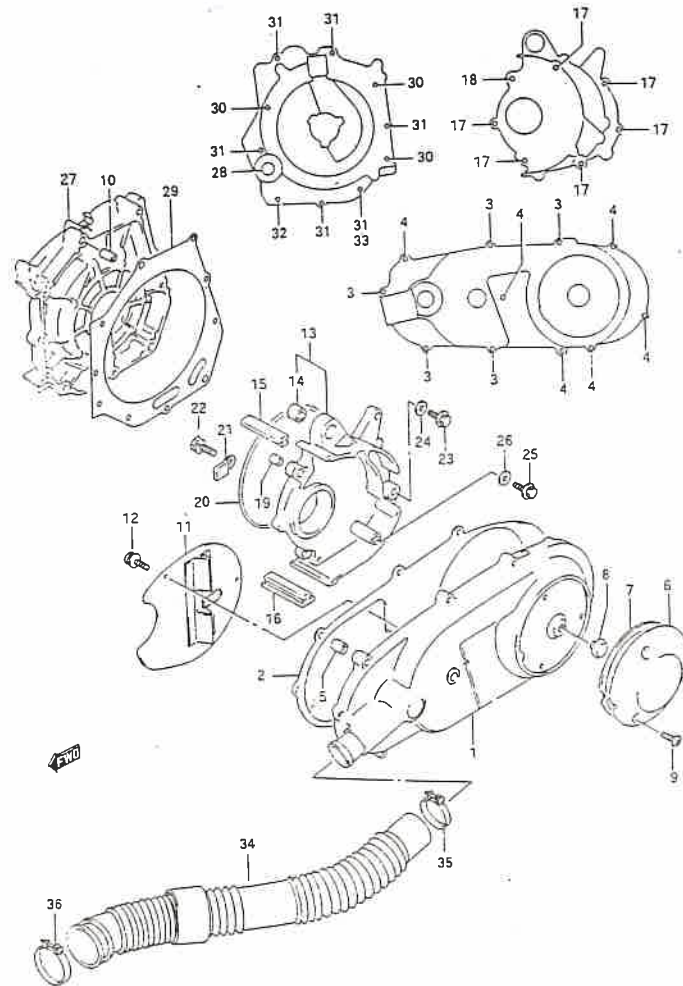

VS 125

FIG. 5 (B-7) CRANKCASE COVER

REF. NO.	PART NO.	DESCRIPTION	QTY	REMARKS
27	11350-20E10	COVER, crankshaft RH	1	
28	11971-33210	.LENS, oil level check	1	
29	11483-20E10	GASKET, crankshaft cover RH	1	
30	09106-08084	SCREW (8x110)	3	
31	02112-06353	SCREW	5	
32	02112-06453	SCREW	2	
33	09168-06024	GASKET	1	
34	17160-20E10	DUCT, belt cooling	1	
35	09402-38306	CLAMP	1	
36	09402-48208	CLAMP	1	

FIG. 6

FIG. 6 (B-8) CRANKSHAFT

ARKS

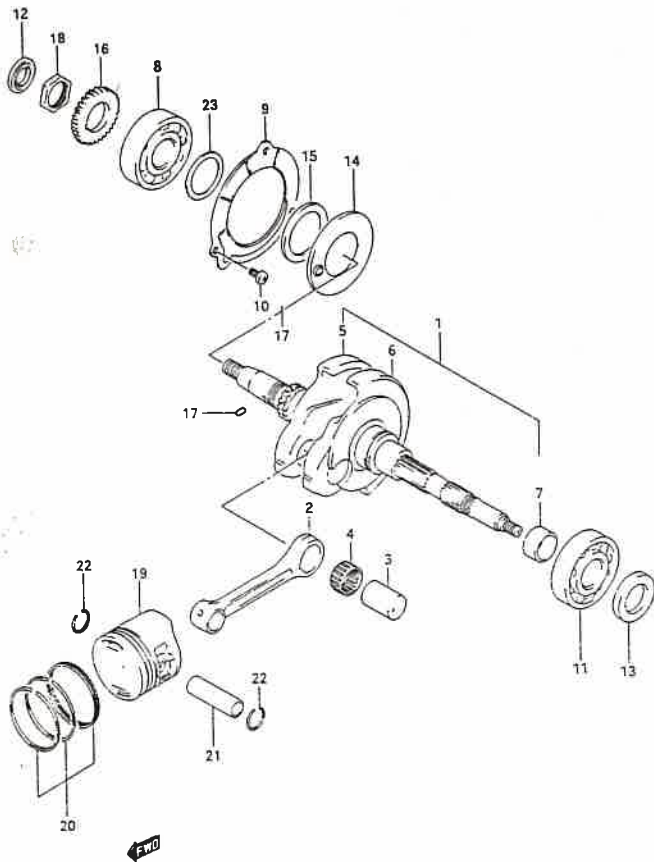

REF. NO.	PART NO.	DESCRIPTION	Q'TY	REMARKS
1	12200-20E04	CRANKSHAFT ASSY	1	
2	12161-20E10-0B0	.ROD, connecting	1	Connecting rod Kit
3	12211-20E02	.PIN, crank	1	
4	09263-28027-0B0	.BEARING (28x36x15.8)	1	
5	12221-20E11	.CRANKSHAFT, RH	1	
6	12260-20810	.CRANKSHAFT, LH	1	
7	09180-19013	..SPACER (19x25x11.9)	1	
8	09262-32011	BEARING, RH (65x32x16)	1	
9	12521-20E10	PLATE, oil reserve	1	
10	09125-06092	SCREW	3	
11	09262-25118	BEARING, LH (62x25x16)	1	
12	09283-20055	OIL SEAL, RH (25x42x6)	1	25x28x5 (Small)
13	09283-25095	OIL SEAL, LH (25x42x6)	1	
14	12510-20E10	PLATE, crankshaft oil guide	1	
15	12359-20E00	RETAINER, oil guide plate	1	
16	16321-20E00	GEAR, oil pump drive	1	
17	04221-04069	PIN	1	
18	09140-22008	NUT	1	
19-1	12111-20E03-0F0	PISTON	1	
19-2	12111-20E03-050	PISTON	1	
19-3	12111-20E03-100	PISTON	1	
20-1	12140-20E10	RING SET, piston	1	
20-2	12140-20E10-050	RING SET, piston	1	
20-3	12140-20E10-100	RING SET, piston	1	
21	12151-20E10,	PIN, piston	1	
22	09381-14001	SNAP RING	2	

2

2

FIG. 6

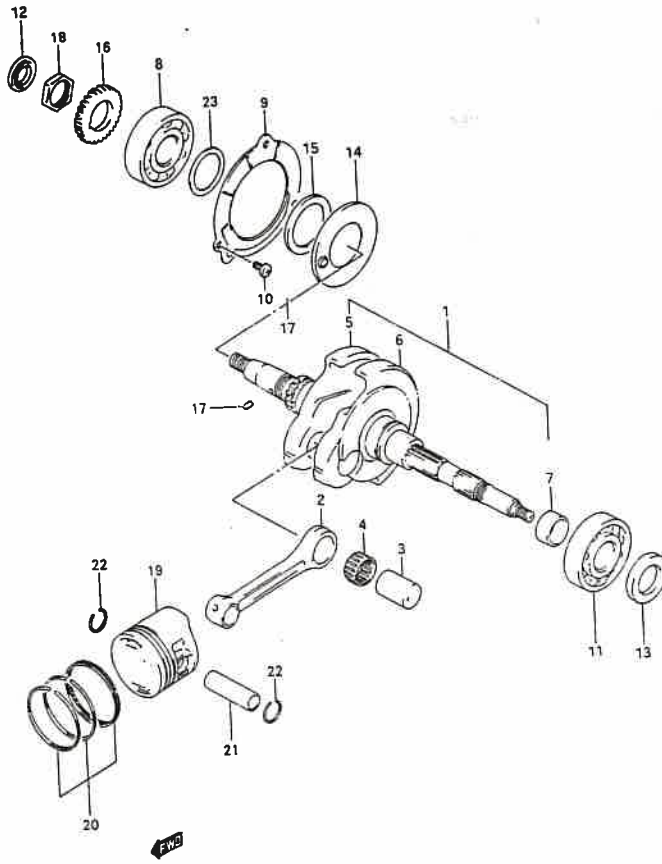
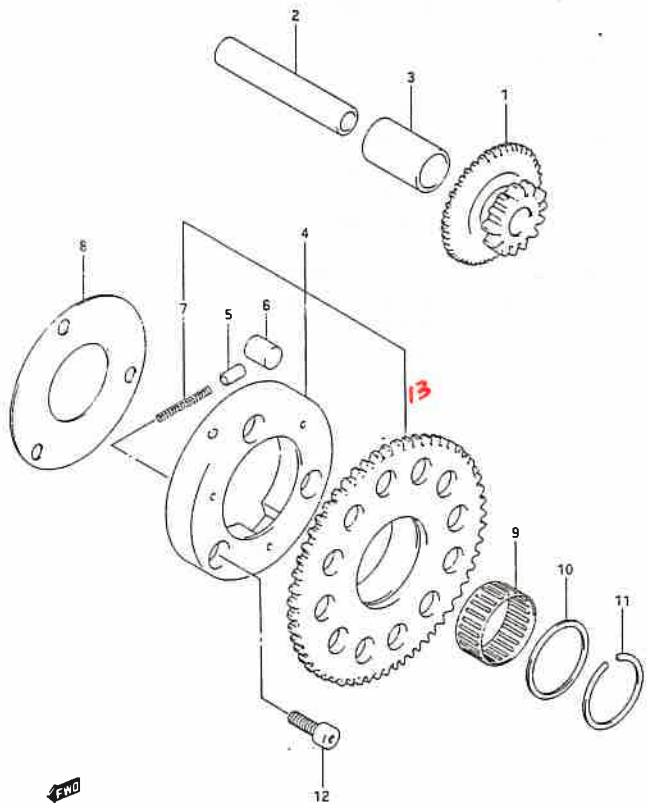

FIG. 6 (B-9) CRANKSHAFT

REF. NO.	PART NO.	DESCRIPTION	QTY	REMARKS
23-1	09181-32016	SHIM (32x40x0.6)	1	
23-2	09181-32017	SHIM (32x40x0.65)	1	
23-3	09181-32018	SHIM (32x40x0.7)	1	
23-4	09181-32019	SHIM (32x40x0.75)	1	
23-5	09181-32020	SHIM (32x40x0.8)	1	
23-6	09181-32021	SHIM (32x40x0.85)	1	
23-7	09181-32022	SHIM (32x40x0.9)	1	
23-8	09181-32023	SHIM (32x40x0.95)	1	
23-9	09181-32024	SHIM (32x40x1)	1	
23-10	09181-32025	SHIM (32x40x1.05)	1	
23-11	09181-32026	SHIM (32x40x1.10)	1	
23-12	09181-32027	SHIM (32x40x1.15)	1	
23-13	09181-32028	SHIM (32x40x1.20)	1	
23-14	09181-32029	SHIM (32x40x1.25)	1	
23-15	09181-32030	SHIM (32x40x1.30)	1	
23-16	09181-32031	SHIM (32x40x1.35)	1	
23-17	09181-32032	SHIM (32x40x1.40)	1	
23-18	09181-32033	SHIM (32x40x1.45)	1	

FIG. 7

FIG. 7 (B-10) STARTER CLUTCH



REF. NO.	PART NO.	DESCRIPTION	Q'TY	REMARKS
1	12611-20E00	GEAR, starter idle (NT: 44/15)	1	
2	09206-13016	PIN (7.4x13x72)	1	
3	09180-13009	SPACER (13x19x32.8)	1	
4	12600-20821	CLUTCH SET, starter	1	Δ 12600-20822
5	12633-05300	PIECE, starter clutch roller push	3	* ANISO = 05310
6	09261-10003	ROLLER	3	
7	09440-03004	SPRING	3	* ANISO = 03013
8	12649-20E02	SHIM, starter clutch hub	1	
9	09263-32008	BEARING	1	
10	09181-32102	SHIM	1	
11	09380-32002	SNAP RING	1	
12	07130-06163	BOLT	3	
13	12620-20E10	GEAR comp, starter	1	

2

FIG. 8

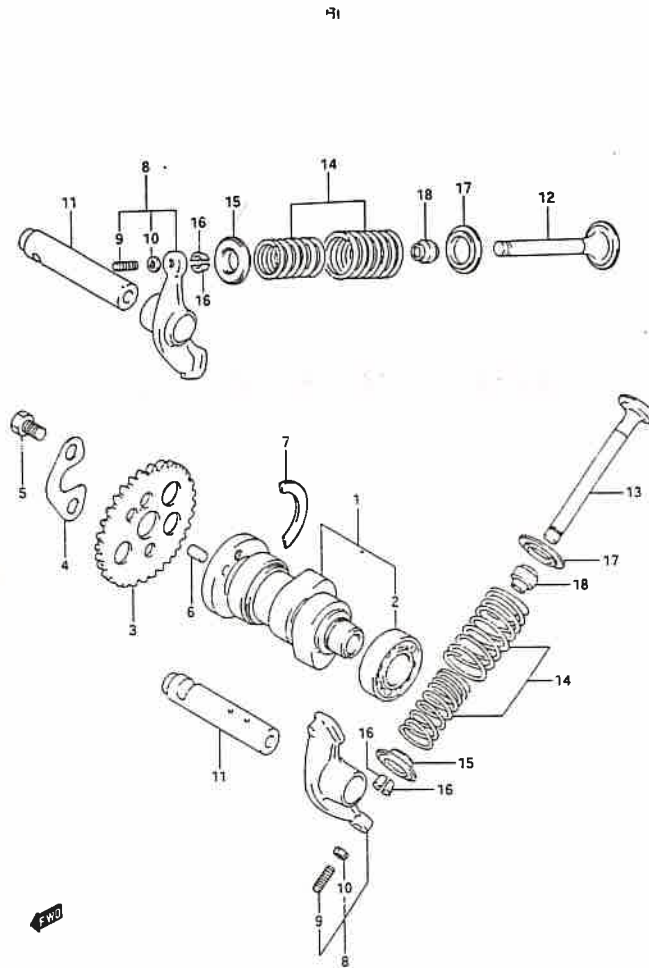
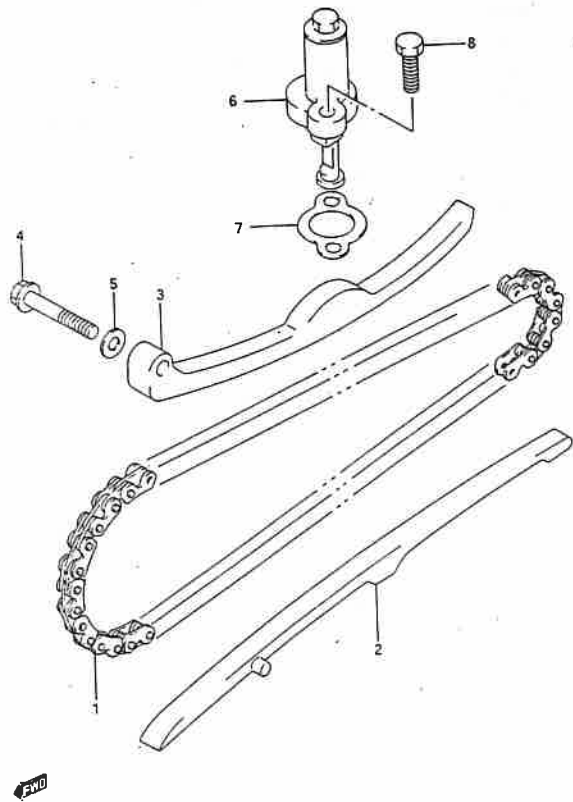

FIG. 8 (B-11) CAM SHAFT/VALVE

REF. NO.	PART NO.	DESCRIPTION	Q'TY	AW(BOX) REMARKS
1	12710-20E50	SHAFT, cam	1	<-20E707
2	09262-15029	.BEARING	1	
3	12741-20E00	SPROCKET, cam shaft	1	
4	12747-30A01	WASHER, sprocket	1	
5	09111-06041	BOLT	2	<-060327
6	09261-05005	ROLLER	1	
7	09390-32001	C RING (ID: 24, OD: 36, T: 1.6)	1	
8	12840-20E00	ARM, valve rocker	2	
9	12842-49201	.SCREW, tappet adjusting	2	
10	12843-27A00	.NUT, tappet adjusting	2	
11	12861-20E00	SHAFT, valve rocker arm	2	
12	12911-20E00	VALVE, intake	1	
13	12912-20E00	VALVE, exhaust	1	
14	12920-30A01	SPRING SET, valve	2	<-20E00>
15	12931-09400	RETAINER, valve spring	2	
16	12932-27A00	RETAINER, valve	4	
17	12933-39E00	SEAT, valve spring	2	
18	09289-05011	OIL SEAL	2	

FIG. 9

FIG. 9 (B-12) CAM CHAIN



REF. NO.	PART NO.	DESCRIPTION	QTY	REMARKS
1	12760-20E00 A 06 L3	CHAIN, cam shaft drive (94LE) (13)	1	can use UP15 - 4680
2	12771-20E00	GUIDE, cam chain	1	
3	12811-20E00	TENSIONER, cam chain	1	
4	12812-30A00	BOLT, cam chain tensioner	1	
5	09168-06004	GASKET (6.2x11x1.2)	1	
6	12830-20E00	ADJUSTER ASSY, tensioner	1	
7	12837-19B10	GASKET, tensioner adjuster	1	
8	01500-06203	BOLT	2	

ANIX
REMARKS

2

2

FIG. 10

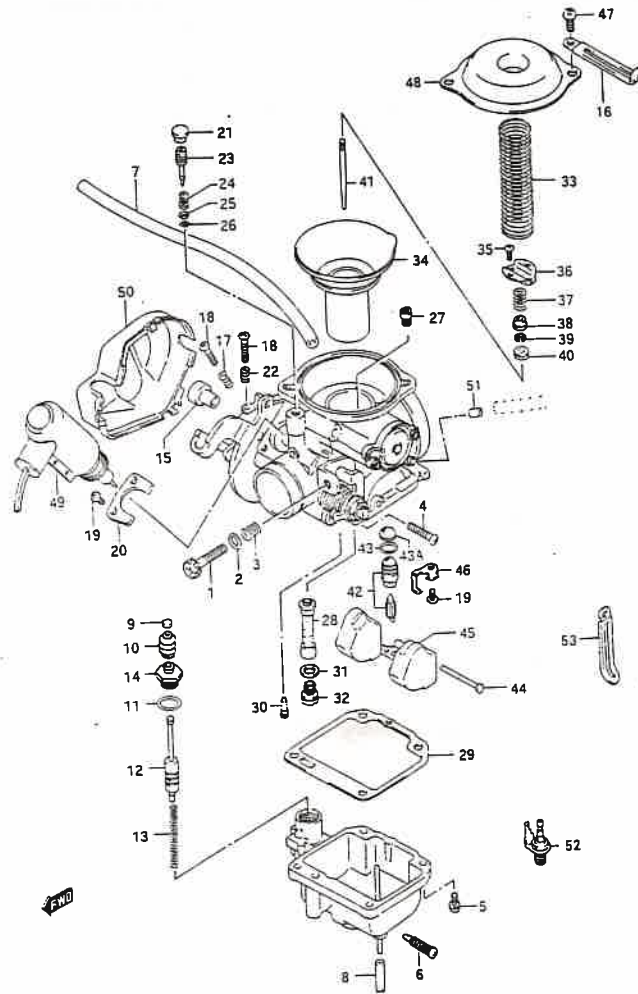

FIG. 10 (C-2) CARBURETOR

REF. NO.	PART NO.	DESCRIPTION	QTY	REMARKS
	13200-20EG0	CARBURETOR ASSY	1	
1	13267-20E20	.ADJUST SCREW	1	
2	13386-09410	.WASHER	1	
3	13268-37420	.SPRING	1	
4	02112-05107	.SCREW	2	
5	13601-04148	.SCREW	4	
6	13247-28A00	.SCREW, drain	1	
7	09352-30503-600	.HOSE (3x5x600)	1	L:600-200
8	13684-34A10	.HOSE	1	
9	13495-09400	.CAP	1	
10	13495-18E00	.CAP	1	
11	09280-08014	.O RING	1	
12	13493-20E20	.PLUNGER	1	
13	13222-60A10	.SPRING	1	
14	13496-20E20	.GUIDE HOLDER	1	
15	13674-20E20	.FILTER ASSY	1	
16	09404-06432	.CLAMP	1	
17	13434-30650	.SPRING	1	
18	02112-03163	.SCREW	2	
19	02112-04063	.SCREW	3	
20	13421-20E20	.PLATE	1	
21	13357-36A00	.PLUG	1	AMISO = ABOLISH
22	13494-09410	.SPRING	1	
23	13279-45400	.SCREW, PILOT (1 7/8)	1	
24	13268-47070	.SPRING	1	
25	13291-29900	.WASHER	1	
26	13295-29900	.O RING	1	
27	09491-23015	.JET, MAIN (#117.5)	1	
28	09494-00904	.NEEDLE JET (P-O)	1	

FIG. 10

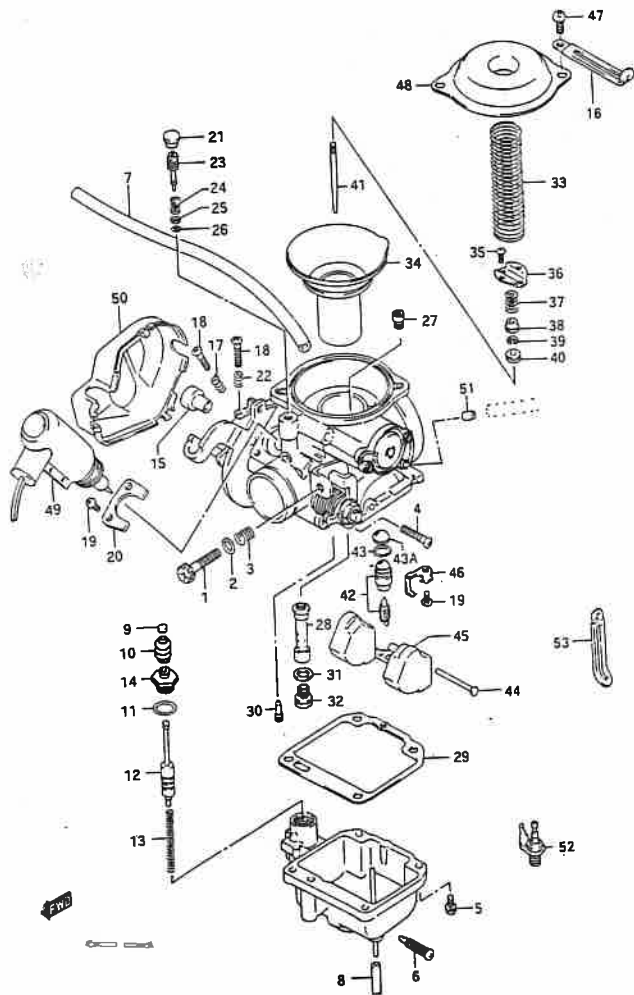

FIG. 10 (C-3) CARBURETOR

REF. NO.	PART NO.	DESCRIPTION	Q'TY	REMARKS
29	13251-20E20	.GASKET, float	1	
30	09492-35008	.JET, pilot (35)	1	
31	13382-03110	.WASHER	1	
32	09491-97003	.JET, main (97.5)	1	
33	13503-20E20	.SPRING	1	
34	13500-20E20	.DIAPHRAGM ASSY	1	
35	02112-03083	.SCREW	2	
36	13389-20E20	.DISK PLATE	1	
37	13388-20E20	.SPRING	1	
38	13382-20E20	.RING	1	
39	13394-10010	.CLIP, NEEDLE	1	
40	13387-20E20	.RING	1	
41	13383-20E20	.JET NEEDLE	1	
42	13370-20E20	.NEEDLE VALVE ASSY	1	
43	13374-44080	.O RING	1	
43A	13376-84110	.FILTER	1	
44	13254-92311	.PIN, float	1	
45	13250-05300	.FLOAT	1	
46	13373-11400	.PLATE	1	
47	02112-05087	.SCREW	2	
48	13502-20E20	.COVER, diaphragm	1	
49	13430-20E90	.THERMO ELEMENT ASSY	1	
50	13488-20E20	.COVER	1	
51	13131-20E00	JET, boost hose	1	
52	13650-25E01	HEATER ASSY, carburetor (15W)	1	OPT
53	09404-06429	CLAMP, carb overflow hose	1	

2

FIG. 11

2

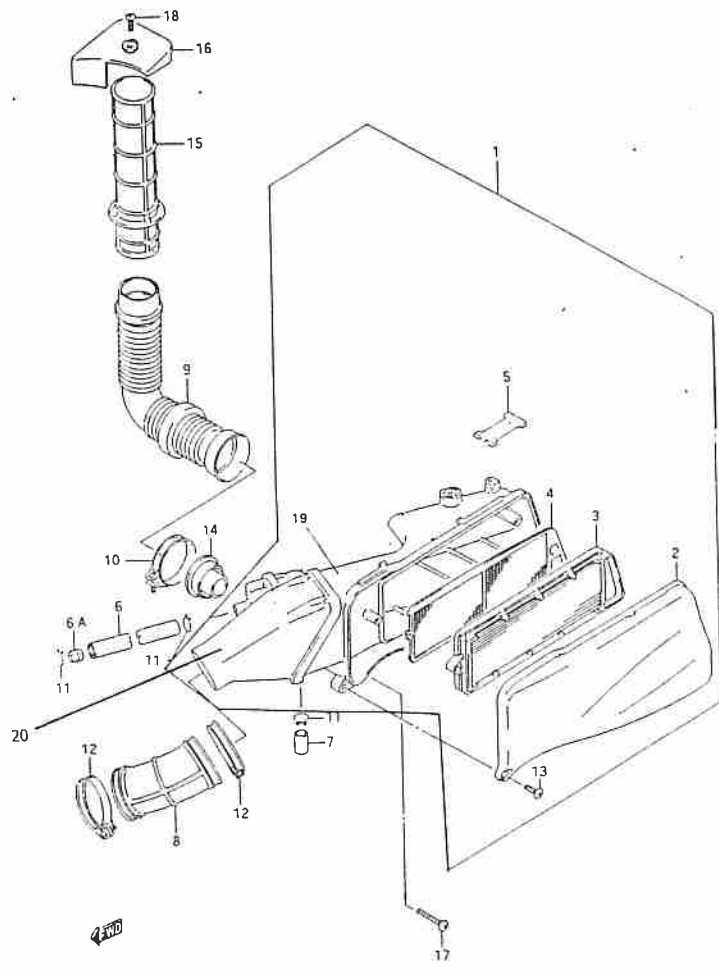

FIG. 11 (C-4) AIR CLEANER

REF. NO.	PART NO.	DESCRIPTION	QTY
1	13700M20E00	CLEANER ASSY, air	1
2	13740M20E00	.CAP, air cleaner	1
3	13780-20E00	.FILTER, air cleaner	1
4	13810-20E00	.TRAP, frame	1
5	13821M39C00	.SLIDER	3
6	13850-20E00	.TUBE, breather	1
6A	13859-14D40	.JET, breather	1
7	13859-41B10	.PLUG	1
8	13881-20E00	.TUBE, outlet	1
9	13890-20E00	.TUBE, inlet no. 1	1
10	09402-48208	.CLAMP	1
11	09401-14301	.CLIP	3
12	09402-58208	.CLAMP	2
13	02142-05163	.SCREW	3
14	13893-20E00	.ORIFICE, inlet tube	1
15	13892-20E00	TUBE, inlet no. 2	1
16	13981M20E00	COVER, air cleaner inlet	1
17	02112-06303	SCREW	2
18	03541-06163	SCREW	1
19	13721M20E99A	Case Comp. Sub. Air Cleaner	1
20	13722M20E01	DIFFUSER, AIR CLEANER	1

AM150
REMARKS

<delete 7

<03542 - >

AM150X
Prefiler
13786-20E00
Tube, drain
13780-20E00

FIG. 12

FIG. 12 (C-5) MUFFLER

REF. NO.	PART NO.	DESCRIPTION	Q'TY	REMARKS
1	14181-37D10	GASKET, exhaust pipe	1	
2	14305-20E30	MUFFLER	1	
3	14780M20E00	COVER, muffler	1	
4	09118-08147	BOLT (8x35)	2	
5	09160-06028	WASHER (6.5x18x1)	2	
6	09180M06306	SPACER (6.4x9x5)	2	
7	09320M08051	CUSHION*	2	
8	09320M12058	CUSHION	2	
9	09139-06091	SCREW (6x10)	2	
10	07120-08203	BOLT	2	

2

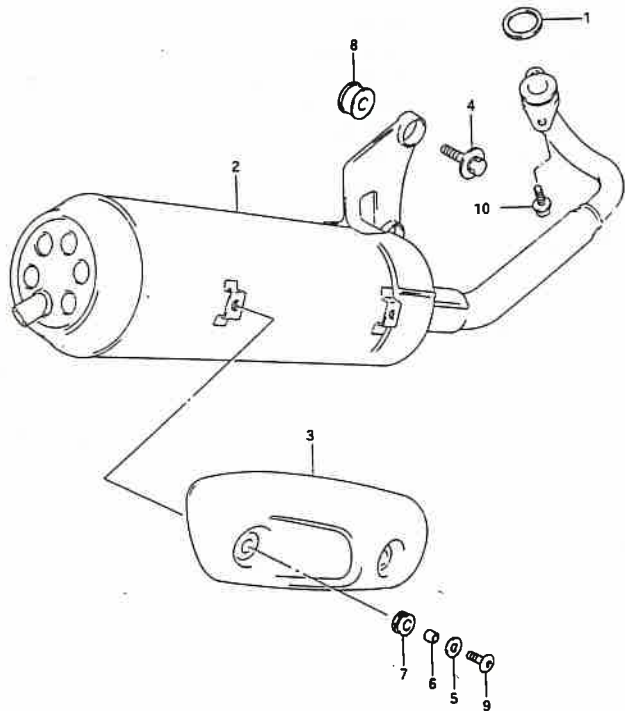

REMARKS

17

2-7

200
air
E20

2

FIG. 13

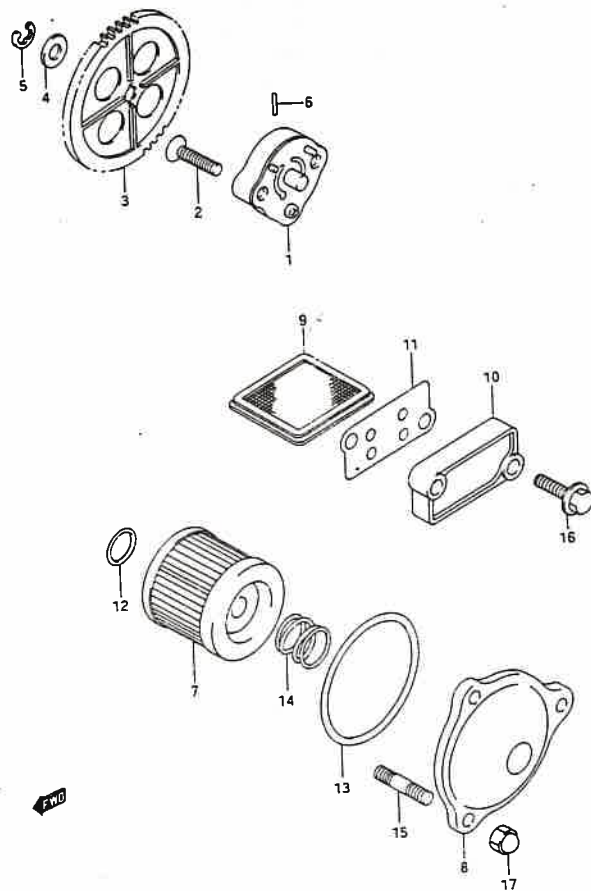

VS 125

FIG. 13 (C-6) OIL PUMP

REF. NO.	PART NO.	DESCRIPTION	QTY	REMARKS
1	16410-20E00	PUMP, oil	1	ANISOX
2	02122-06253	SCREW	2	
3	16331-20E00	GEAR, oil pump driven	1	
4	16422-20E00	WASHER	1	
5	16423-20E00	CIRCLIP	1	
6	16421-20E00	PIN	1	
7	16510-05240	FILTER, engine oil	1	
8	16512-18900	CAP, oil filter	1	
9	16520-09402	STRAINER, engine oil	1	
10	16523-20E00	CAP, oil strainer	1	(~) 20E(0)
11	16524-20E00	GASKET, oil strainer cap	1	(~) 20E(0)
12	09280-13004	O RING (D: 1.9, ID: 13)	1	
13	09280-54001	O RING (D: 2.4, ID: 52.6)	1	
14	09440-18002	SPRING	1	
15	01421-06123	STUD BOLT	3	< delete >
16	01550-06253	BOLT	2	
17	08313-10063	NUT	3	< delete >

new

01547-06163
01550-08123
09168-08015

FIG. 14

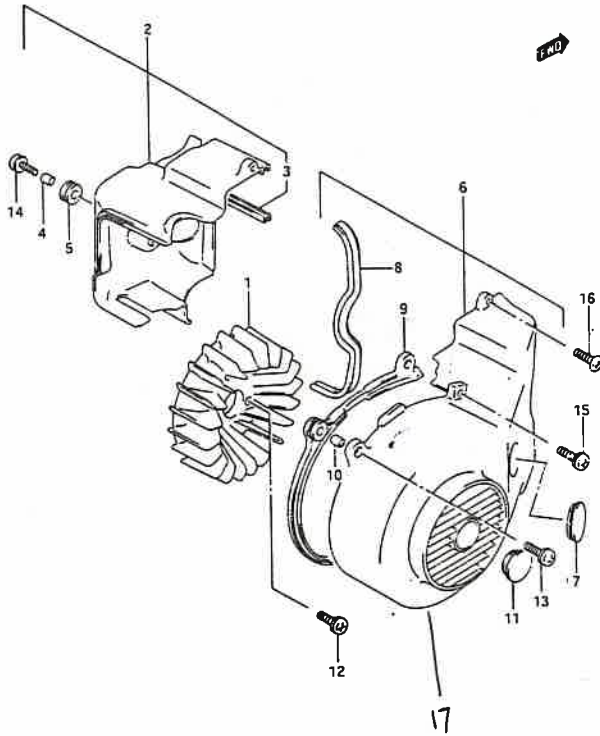

FIG. 14 (C-7) COOLING FAN

REF. NO.	PART NO.	DESCRIPTION	Q'TY	REMARKS
1	17110-20E00	FAN, cooling	1	
2	17120-20E10	COWLING, cylinder	1	(20E11)
3	17122-20E00	.MOLD, cylinder cowling	1	
4	09180-06263	.SPACER (6.1x9x9)	1	
5	09320-09016	.CUSHION	1	
6	17130-20E00	COWLING ASSY, fan	1	
7	09250-30003	.CAP	1	
8	17132-20E00	.MOLD, fan cowling	1	
9	17133-20E00	.DAMPER, fan cowling	1	
10	17134-20E00	.SPACER	2	
11	17136-20E00	.PLUG, cowling fan	1	
12	02112-16163	SCREW	3	
13	02112-16253	SCREW	3	
14	02112-16203	SCREW	1	
15	02112-16303	SCREW	1	
16	03541-06203	SCREW	1	
17	17131-20E00	COWLING comp, fan	1	

ANL50X

2

<01550-06163>

<03542-06203>

2

FIG. 15

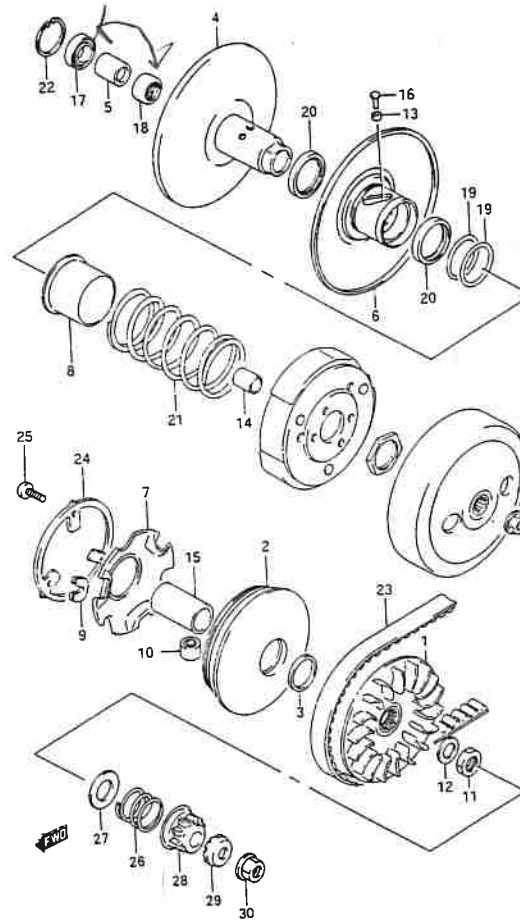

VS 125

FIG. 15 (C-8) TRANSMISSION (1)

REF. N°.	PART NO.	DESCRIPTION	QTY
1	21110-11E02	FACE, fixed drive	1
2	21120-11E12	FACE, movable drive	1
3	21124-11E00	SEAL, movable drive face oil	1
4	21210-20E20	FACE, fixed driven	1
5	21213-41D03	SPACER, fixed driven face	1
6	21240-20E01	FACE, movable driven	1
7	21431-20E20	PLATE, movable drive	1
8	21471-03A03	SHEET, movable driven face	1
9	21481-11E00	DAMPER, movable driven plate	3
10	21650-04C10	ROLLER, movable drive	6
11	09140-16005 (Zn)	NUT $\Delta 21141C$	1
12	09164-16005	WASHER	1
13	09180-05042	SPACER (5x8x3.5)	3
14	09180-12129	SPACER (12x17x19)	1
15	21125-20E00	SPACER	1
16	09201-05006	PIN	3
17	09262-15028	BEARING (15x28x7)	1
18	09263-17042	BEARING (17x25x16.7)	1
19	09280-41005	O RING (D: 4.6, ID: 41.9)	2
20	09284-34002	OIL SEAL	2
21	21243-20E00	SPRING, movable driven	1
22	08331-41286	CIRCLIP	1
23	27601-20E10	V BELT, drive	1
24	21122-20E01	COVER, movable drive	1
25	02142-04103	SCREW	3
26	09440-30009	SPRING	1
27	08221-25353	WASHER, gear spring	1
28	26280-11E20	GEAR, kick starter driven	1
29	26282-11E01	STARTER, kick	1
30	08316-10103	NUT	1

<All change>

ANIX
REMARKS

<20E00>
<20E00>
<delete>
<20E30>
<delete>
<20E20>
<20E30>
<20E00>
<20E00>
<20E00>
<41D21> <20E00>
<deleted>



FIG. 16

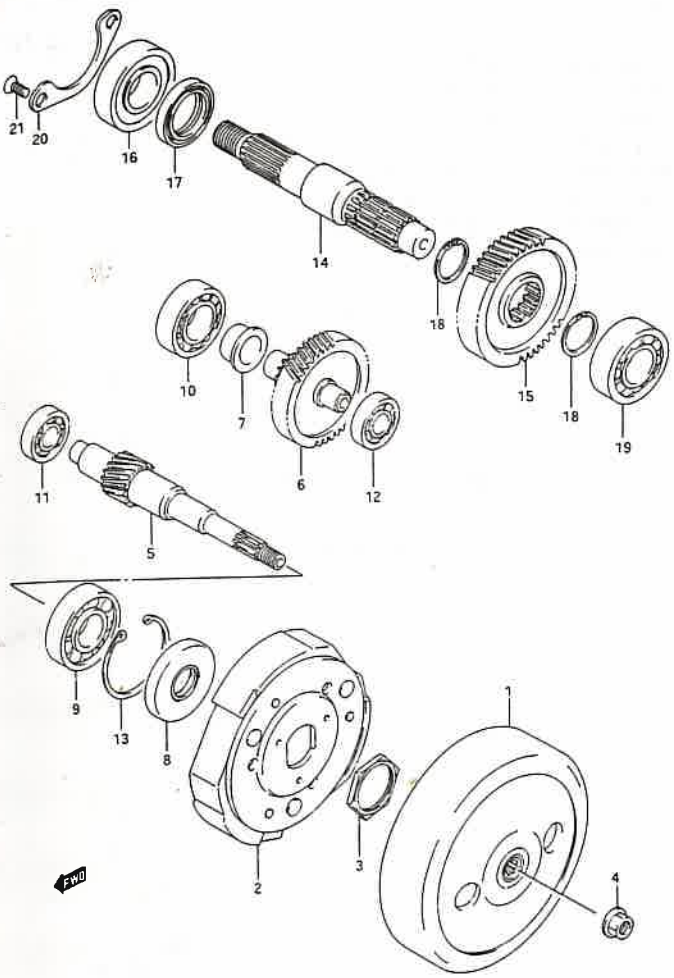

FIG. 16 (C-9) TRANSMISSION (2)

REF. NO.	PART NO.	DESCRIPTION	Q'TY	REMARKS
1	21220-20E01	HOUSING, clutch	1	
2	21501-20E01	CLUTCH ASSY, shoe	1	
3	09140-28004	NUT	1	
4	08316-10103	NUT	1	
5	24131-20E04	SHAFT, drive (NT: 17)	1	
6	24150-20E00	SHAFT, idle (NT: 45/15)	1	
7	24152-20E00	SPACER, idle shaft RH	1	
8	09283-20054	OIL SEAL (20x47x6)	1	
9	09262-20069	BEARING	1	
10	09262-20106	BEARING (20x42x12)	1	
11	08113-62017	BEARING, RH	1	
12	08113-62017	BEARING, LH	1	
13	08331-41478	CIRCLIP	1	
14	24141-11E10	SHAFT, rear axle	1	
15	24371-20E00	GEAR, final driven (NT: 47)	1	
16	09262-22027	BEARING (22x50x14)	1	
17	09283-27010	OIL SEAL (27x40x6)	1	
18	08331-31226	CIRCLIP	2	
19	08110-62030	BEARING	1	
20	24751-11E00	RETAINER, axle shaft bearing	1	
21	02122-06163	SCREW	2	

2

FIG. 17

2

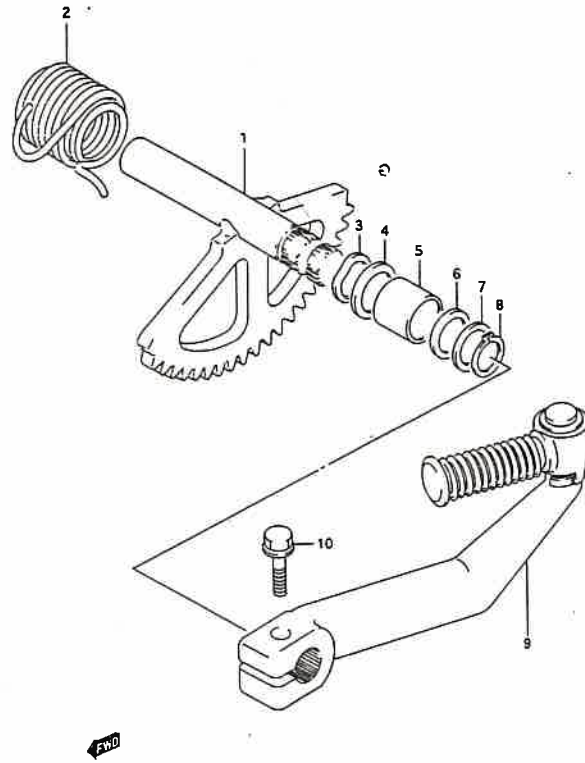

FIG. 17 (C-10) KICK STARTER

REF. NO.	PART NO.	DESCRIPTION	QTY	REMARKS
1	26210-11E00	SHAFT, kick starter	1	
2	09448-30016	SPRING	1	26212C20E00W
3	09164-14012	WASHER, wave (14.5x20x0.3)	1	
4	09181-14195	WASHER (14x24x1)	1	
5	09300-14011	BUSH	1	
6	09161-14010	WASHER (14x22x0.8)	1	
7	09160-14053	WASHER (14.5x22x0.8)	1	
8	08331-31146	CIRCLIP, kick shaft	1	
9	26300M04C03	LEVER ASSY, kick starter	1	
10	01500-08203	BOLT	1	

FIG. 18

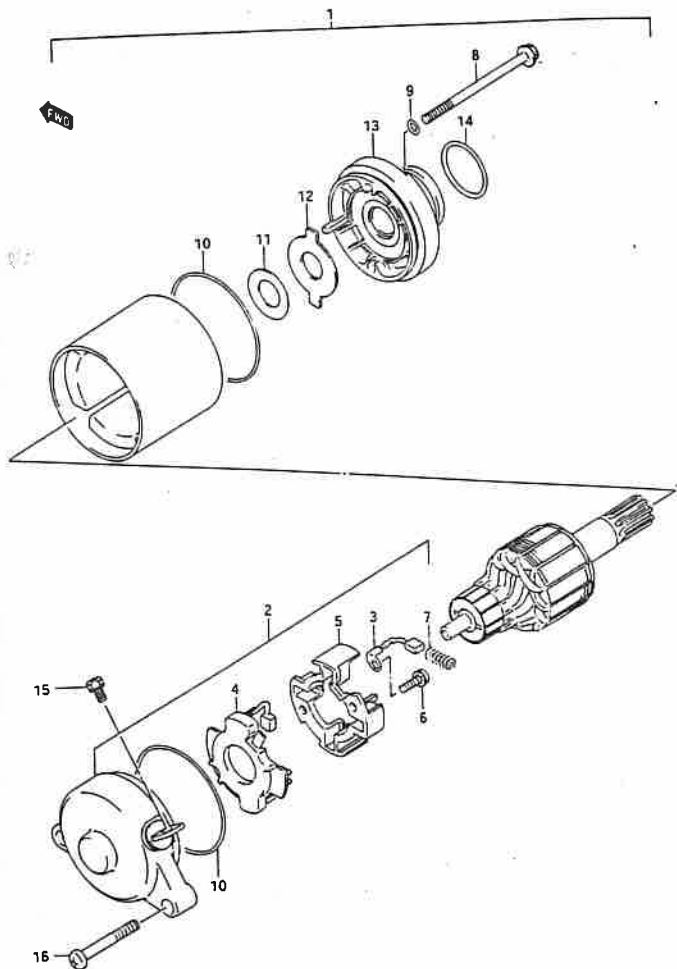

FIG. 18 (D-2) STARTING MOTOR

REF. NO.	PART NO.	DESCRIPTION	Q'TY	REMARKS
1	31100-20E00	STARTER ASSY	1	
2	31175-20E00	.FRAME ASSY, commutator end	1	
3	31132-32C10	.BRUSH	2	
4	31130-32C20	.BRUSH SUB ASSY, starter	1	
5	31133-32C10	.HOLDER, brush	1	
6	02112-34123	.SCREW	2	
7	31135-32C10	.SPRING	4	
8	31281-20E00	.BOLT	2	
9	31156-38300	.O RING	2	
10	31264-32C10	.O RING	2	
11	31361-38300	.SHIM; NO. 3	1	
12	31361-32C10	.PLATE, lock	1	
13	31150-06C00	.BRACKET	1	
14	09280-24003	.O RING (D:3, ID: 24.5)	1	
15	09137-05004	SCREW (5x8)	1	
16	02112-06253	SCREW	2	

2

FIG. 19

3

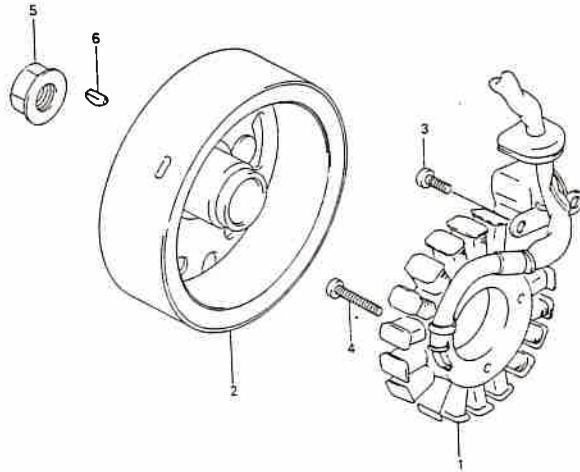

FIG. 19 (D-3) MAGNETO

REF. NO.	PART NO.	DESCRIPTION	Q'TY	REMARKS
1	32101-20E20	STATOR ASSY	1	
2	32102-20E20	ROTOR	1	
3	02112-05103	SCREW	2	
4	02112-05203	SCREW	3	
5	08316-10123	NUT	1	
6	08341-31039	KEY	1	

REMARKS

FIG. 20

FIG. 20 (D-4) BATTERY

REF. NO.	PART NO.	DESCRIPTION	Q'TY	REMARKS
1	33610M44 D50-DRY	BATTERY ASSY (12V, 4AH)	1	(DRY CELL) YTX5L-BS
2	33652M29100	PROTECTOR, Battery	1	
3	33652M31C00	PROTECTOR, Battery	4	

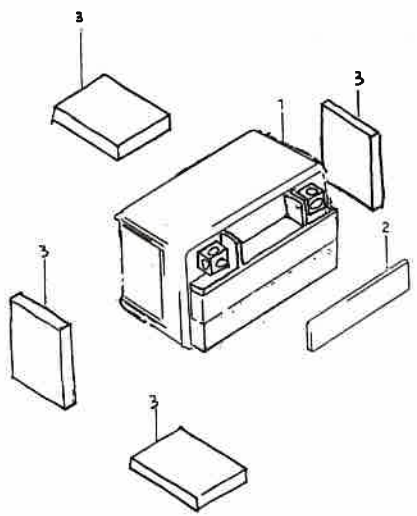

3

FIG. 21

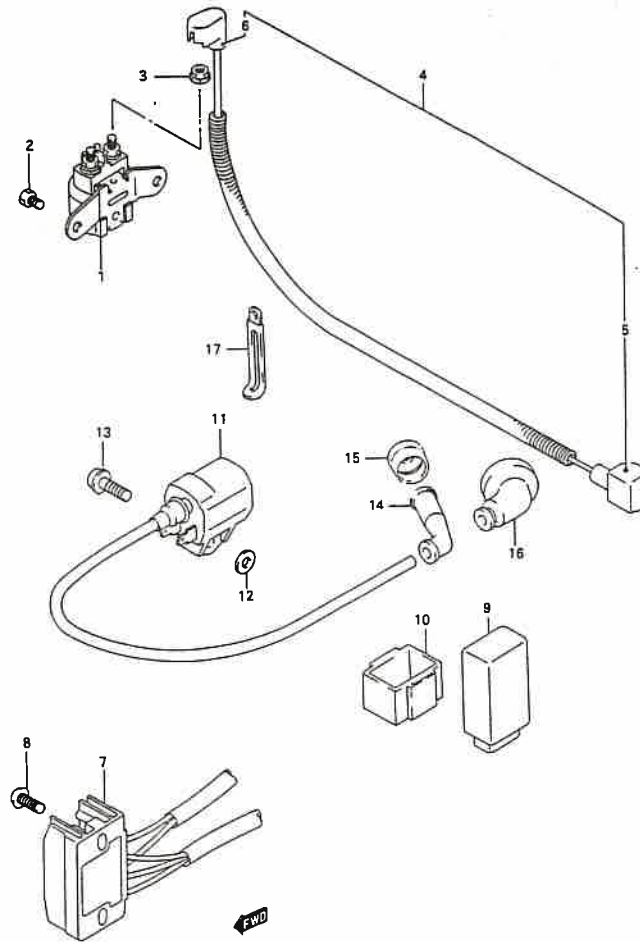

3

FIG. 21 (D-5) ELECTRICAL

REF. NO.	PART NO.	DESCRIPTION	QTY	REMARKS
1	31800-49100	RELAY ASSY, starting motor	1	
2	09128-06004	SCREW (6x10)	2	
3	08361-35068	NUT	2	
4	33810M20E00	WIRE, starter motor	1	
5	31861M06C00	.CAP, starter motor terminal	1	
6	31861M10D00	.CAP, starter relay	1	
7	32800-22D00	RECTIFIER ASSY	1	Δ 2>D10
8	02142-06203	SCREW	2	
9	32900-20EA0	CDI UNIT	1	
10	32980M20E00	HOLDER, CDI unit	1	
11	33410-20E01	COIL ASSY, ignition	1	
12	08322-01063	WASHER	1	
13	02112-16303	SCREW	1	
14	33510-20E00	CAP, spark plug	1	
15	33541-47D00	SEAL, spark plug	1	
16	33542-20E10	SEAL, high tension cord	1	
17	09404-06432	CLAMP, ignition coil	1	L: 65

FIG. 22

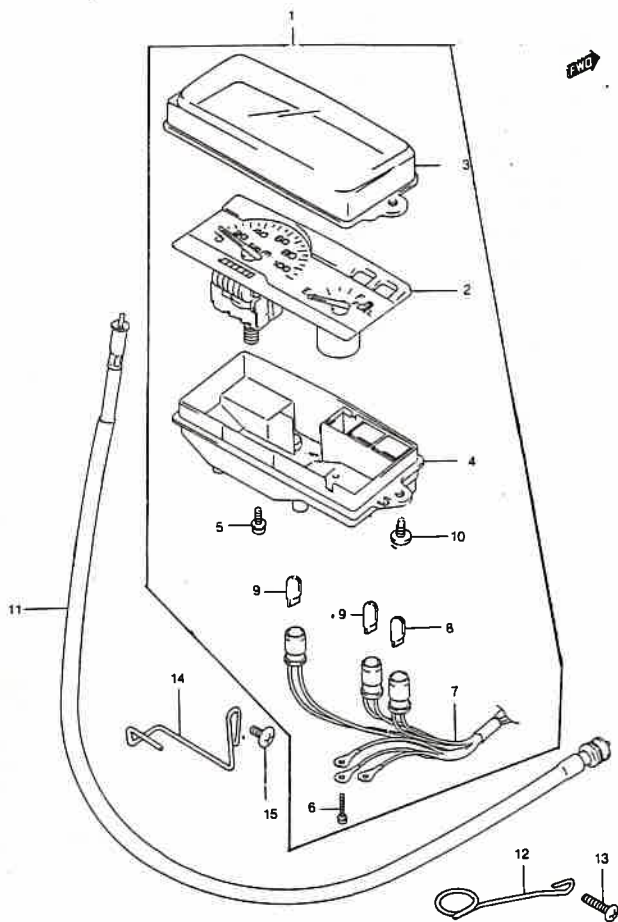

FIG. 22 (D-6) SPEEDOMETER

REF. NO.	PART NO.	DESCRIPTION	Q'TY	REMARKS
1	34100M20E41	SPEEDOMETER ASSY	1	
2	34100M20E40 34100M20E40	SPEEDOMETER/FUEL METER	1	
3	34150M39C01	HOOD, meter	1	
4	34111M20E30	CASE, lower	1	
5	02112M74103	SCREW	2	
6	34383M09400	SCREW	3	
7	34173M20E00	CORD ASSY	1	
8	09471M12028	BULB (12V, 3.4W)	1	
9	09471M12077	BULB (12V, 1.7W)	2	
10	03541-05163	SCREW	3	
11	34910M20E10	CABLE ASSY SPEEDOMETER	1	
12	34938M20E00	GUIDE, meter cable	1	
13	02142-05203	SCREW	1	
14	34938M20E10	GUIDE, meter cable	1	
15	02142-06103	SCREW	1	

3

FIG. 23

3

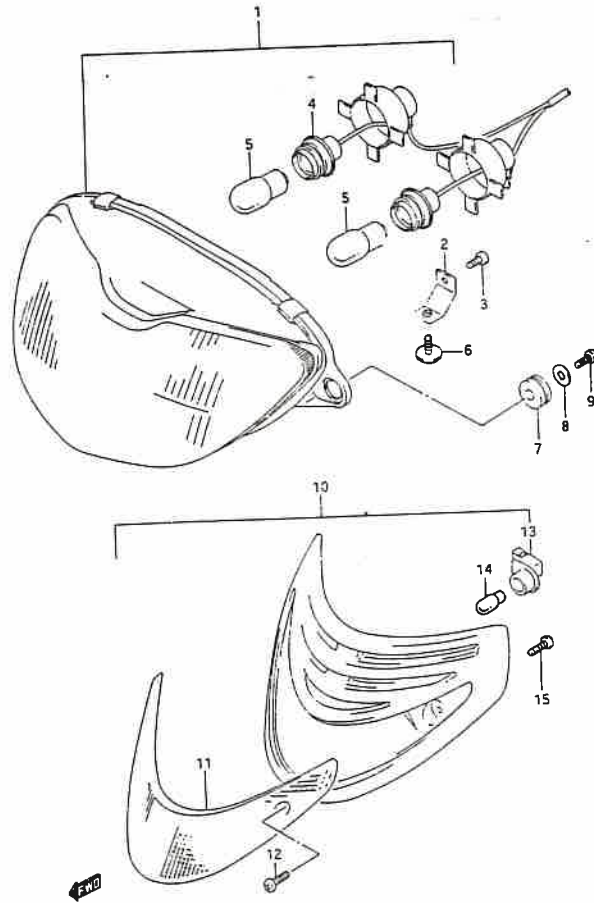

FIG. 23 (D-7) HEADLAMP

REF. NO.	PART NO.	DESCRIPTION	QTY	REMARKS
1	35100-20E00-999	HEADLAMP ASSY	1	
2	35159-20E00	.PLATE	1	
3	03511-05123	.SCREW	1	
4	35171-20E00	.SOCKET	1	
5	09471-12168	.BULB (12V, 30/30W)	2	63-10 B6F6
6	09136/05051	SCREW	1	
7	09320-07015	CUSHION	2	
8	09160-05037	WASHER	2	
9	03541-04123	SCREW	2	
10	36110-20E00	LAMP ASSY, front position	1	
11	36112-20E00	.LENS, front position	1	
12	03212-04169	.SCREW	2	
13	36258-70C30	.SOCKET	1	
14	09471-12081	.BULB (12V, 5W)	1	
15	03541-04163	SCREW	2	

FIG. 24

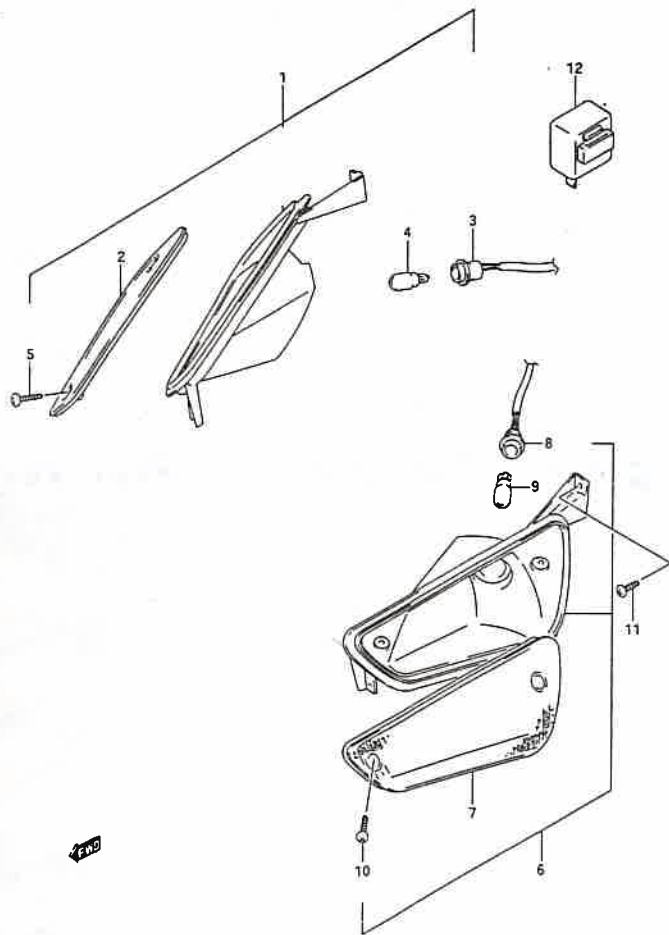

FIG. 24 (D-8) FRONT TURN LAMP

REF. NO.	PART NO.	DESCRIPTION	Q'TY	REMARKS
1	35601-20E20	LAMP ASSY, front turn RH	1	
2	35612-20E20	.LENS, RH	1	
3	35638-20E20	.SOCKET ASSY, RH	1	
4	09471-12114	.BULB (12V, 10W)	1	
5	03211-04163	.SCREW	2	
6	35602-20E20	LAMP ASSY, front turn LH	1	
7	35632-20E20	.LENS, LH	1	
8	35638-20E20	.SOCKET ASSY, LH	1	
9	09471-12114	.BULB (12V, 10W)	1	
10	03211-04163	.SCREW	2	
11	03511-14163	SCREW	6	
12	38610-31X50	RELAY ASSY, turn signal	1	

3

EMARKS

FIG. 25

3

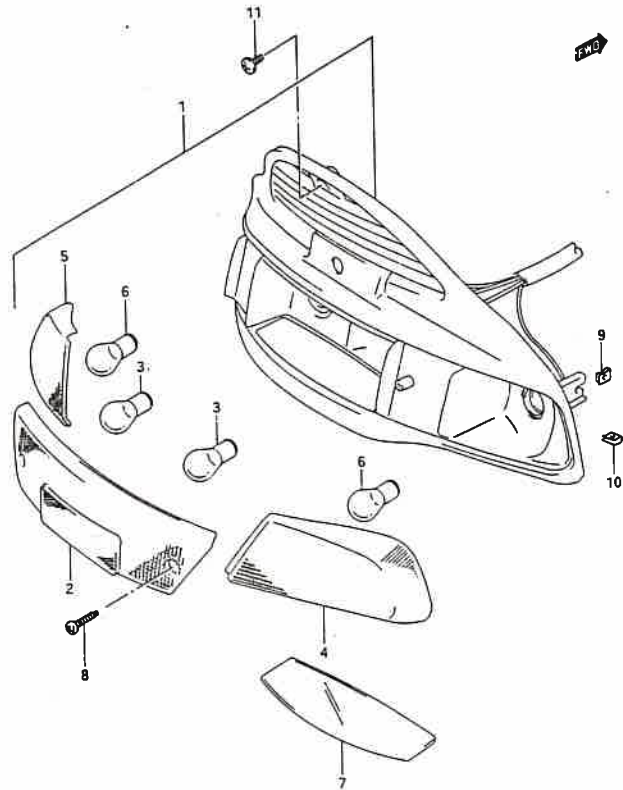

FIG. 25 (D-9) TAIL LAMP

REF. NO.	PART NO.	DESCRIPTION	QTY <New>	REMARKS
1	35710-20E20	LAMP ASSY, rear combination	1	Δ 35710T22E00-000
2	35712-20E00	.LENS, rear combination	1	Δ 35712T22E00-000
3	09471-12128	.BULB (12V, 21/5W)	2	
4	35652-20E00	.LENS, rear turn RH	1	
5	35672-20E00	.LENS, rear turn LH	1	
6	09471-12107	.BULB (12V, 10W)	2	
7	35912-20E00	.LENS, license	1	
8	03211-04203	.SCREW	2	
9	09148-05038	NUT	2	
10	09148-05020	NUT	2	
11	03241-05163	SCREW	1	

35730T22E01 BRKT comp. Lamp vr 1

24.00 Δ 35712T22E00 Rear Lens

FIG. 26

FIG. 26 (D-10) WIRING HARNESS

REMARKS

22-500-000
22-500-000

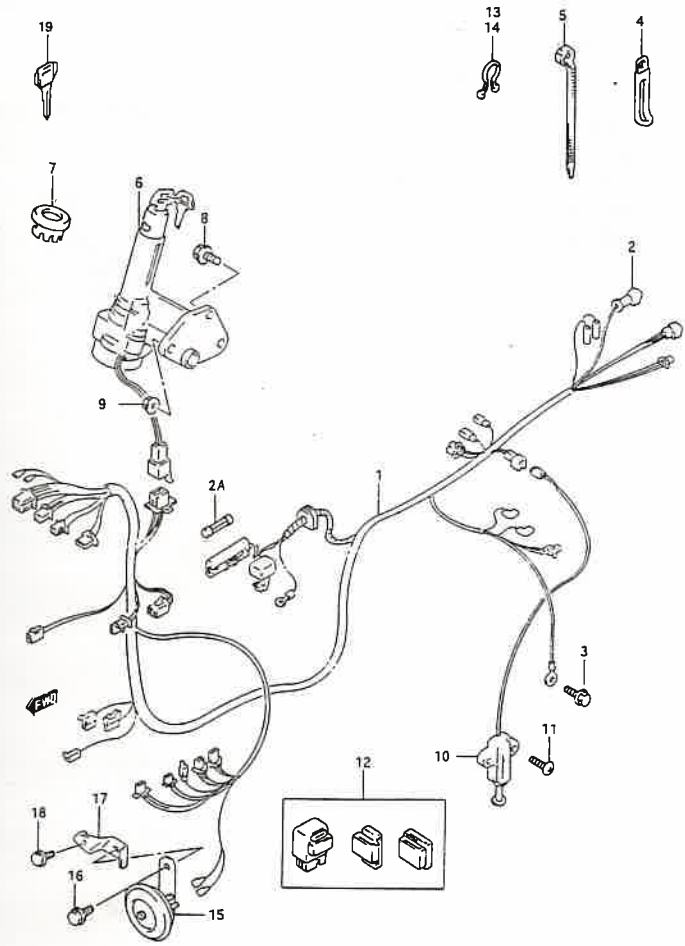

REF. NO.	PART NO.	DESCRIPTION	QTY	REMARKS
1	36610M20E61	HARNESS, wiring	1	
2	31861M31500	.CAP, terminal	1	
2A	09481M15001	.FUSE (15A) —	1	
3	01550-06107	BOLT	1	
4	09404-06432	CLAMP (L:65)	1	
5-1	09407-14403	CLAMP (L:125)	2	
5-2	09407-25401	CLAMP (L:235)	2	
6	37100-20E01	LOCK ASSY, steering	1	
7	37155M29C00	CAP, steering lock	1	
8	01550M06203	SCREW	2	
9	08316-10063	NUT	1	
10	37840-20E00	SWITCH ASSY, side stand	1	
11	02142-06203	SCREW	2	
12	38740-24X50	RELAY ASSY, side stand	1	
13	09408-00012	CLIP	1	
14	09408-00021	CLIP (D: 16)	1	
15	38500-20E10	HORN ASSY	1	
16	01550-08123	BOLT	1	
17	38590M20E00	BRACKET, horn	1	
18	01550-06123	BOLT	1	
19	37146-03A00	KEY, brank type C	1	OPT
20	37146-03A10	KEY, brank type D	1	OPT
21	37146-03A20	KEY, brank type E	1	OPT
22	37146-03A30	KEY, brank type F	1	OPT

3

15

FIG. 27

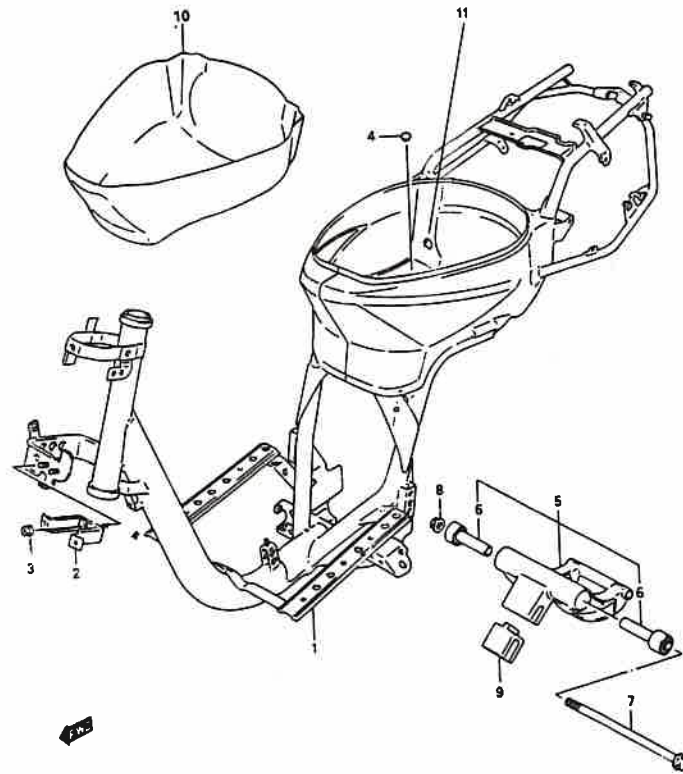

4

FIG. 27 (E-2) FRAME

REF. NO.	PART NO.	DESCRIPTION	QTY	REMARKS
1	41100M20E01-019	FRAME (BLACK)	1	
2	AG100 41150M29C03	BRACKET, front leg lower	1	Tekskill wstki mark
3	08316-10063	NUT	2	
4	09250M07001	PLUG	1	
5	41180-20840	BRACKET SET, crankcase	1	
6	09319-12049	.BUSH (12x34, 1x90)	2	Δ09319C12049W00
7	09103-12046	BOLT (12x204)	1	
8	08319-31126	NUT	1	
9	41185-41D00	CUSHION, swing stop	1	
10	92210M20E01	COVER, helmet	1	
11	09250M20E99A	PLUG, frame rear	1	

FIG. 28

REMARKS

cf mark

9w000

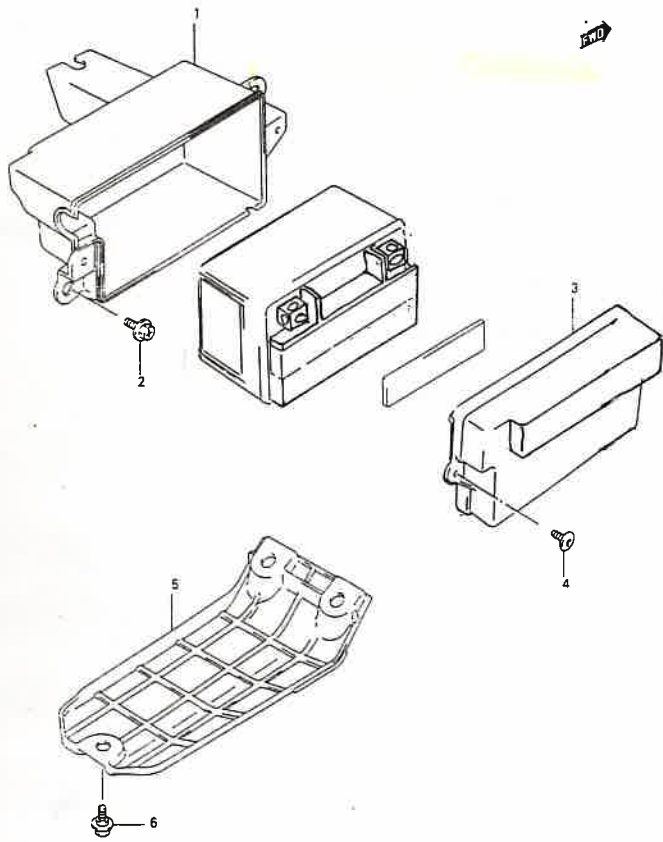
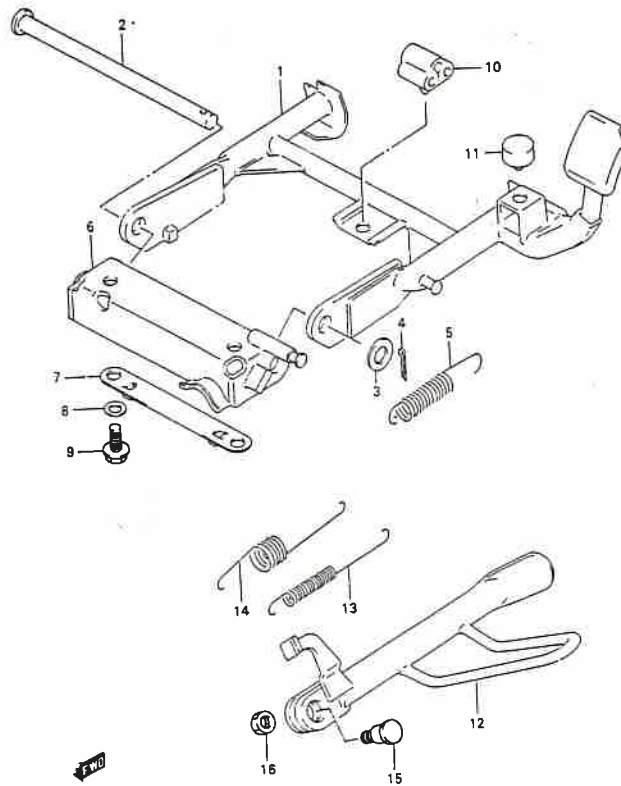

FIG. 28 (E-3) BATTERY HOLDER

REF. NO.	PART NO.	DESCRIPTION	Q'TY	REMARKS
1	41541M20E00A	HOLDER, battery	1	
2	09111-06066	BOLT	2	
3	41542M20E00A	CAP, battery holder	1	
4	01804M06165	SCREW	2	
5	41545M20E00	GUARD, battery holder	1	
6	09111-06066	BOLT	3	

4

FIG. 29



4

FIG. 29 (E-4) STAND

REF. NO.	PART NO.	DESCRIPTION	QTY	REMARKS
1	42100M20E00	STAND, center	1	
2	42211-20E01	SHAFT, center stand	1	
3	08322-01123	WASHER	1	
4	04111-30208	COTTER PIN	1	
5	09443M17023	SPRING	1	
6	42270M20E01	BRACKET, center stand	1	
7	42191M20E00	PLATE, bracket	1	
8	09164-08020	WASHER	2	
9	09103-08342	BOLT	2	
10	09321M10029	CUSHION	1	
11	09321M10012	CUSHION	1	
12	42310M20E10A	STAND, prop	1	AN/50 ~M20E00
13	09443M12036	SPRING, inner	1	
14	09443M21005	SPRING, outer	1	
15	09111-10014	BOLT	1	
16	09159-10097	NUT	1	

FIG. 30

REMARKS

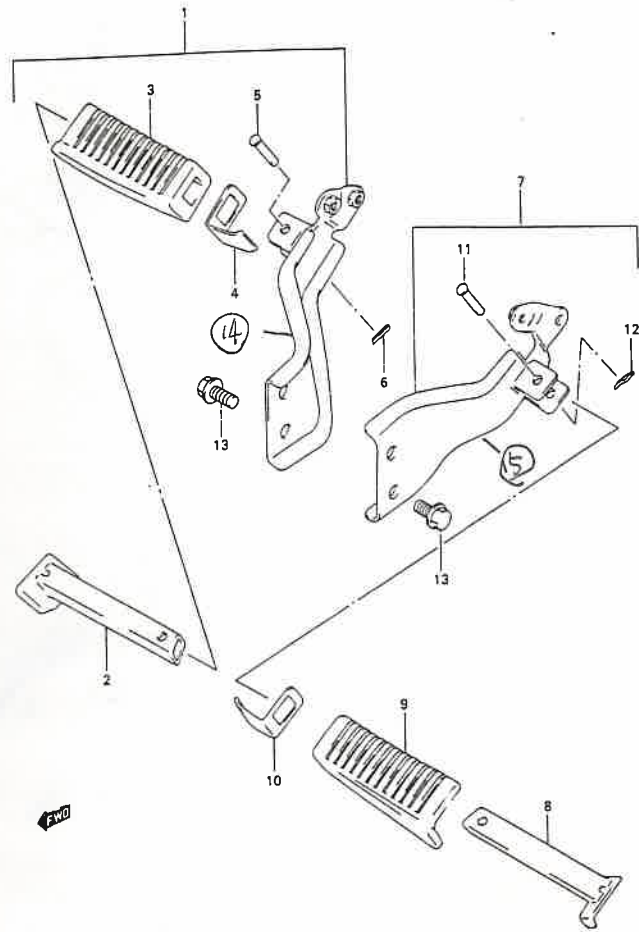

FIG. 30 (E-5) FOOTREST

REF. NO.	PART NO.	DESCRIPTION	QTY	REMARKS
1	43600M20E00	FOOTREST ASSY, pillion RH	1	
2	43610M20E00	.BAR, RH	1	
3	43618M20E00	.RUBBER, RH	1	
4	43631M20E00	.WASHER, RH	1	= 43731M20E00
5	09200-06057	.PIN	1	} Same:
6	04111-25158	.COTTER PIN	1	
7	43700M20E00	FOOTREST ASSY, pillion LH	1	
8	43710M20E00	.BAR, LH	1	
9	43718M20E00	.RUBBER, LH	1	
10	43731M20E00	.WASHER, LH	1	= 43631M20E00
11	09200-06057	.PIN	1	
12	04111-25158	.COTTER PIN	1	
13	01550-08163	BOLT	4	
14.	43626M20E00	Holder, pill f/v RH	1	
15	43720M20E00	Holder, pill f/v LH	1	

4

FIG. 31

FIG. 31 (E-6) CARRIER

REF. NO.	PART NO.	DESCRIPTION	Q'TY	REMARKS
1	43980M20E00	GRIP, stand LH	1	
2	07120-08253	BOLT	2	
3	46310M20E10A	CARRIER COMP REAR	1	
4	07130-08353	.BOLT	2	OPT
5	09250-06004	.CAP	2	OPT
6	01550-06123	BOLT, rear	1	

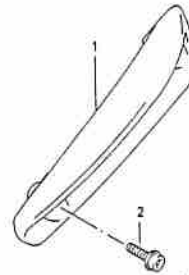
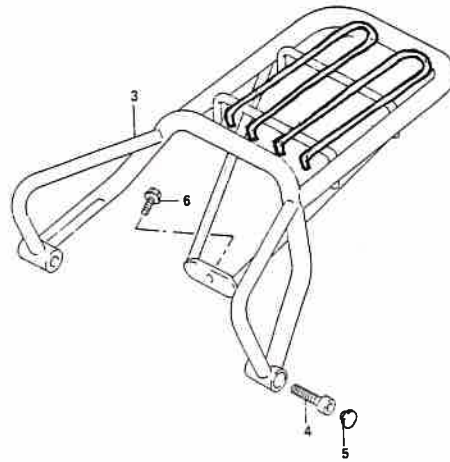

4

FIG. 32

REMARKS

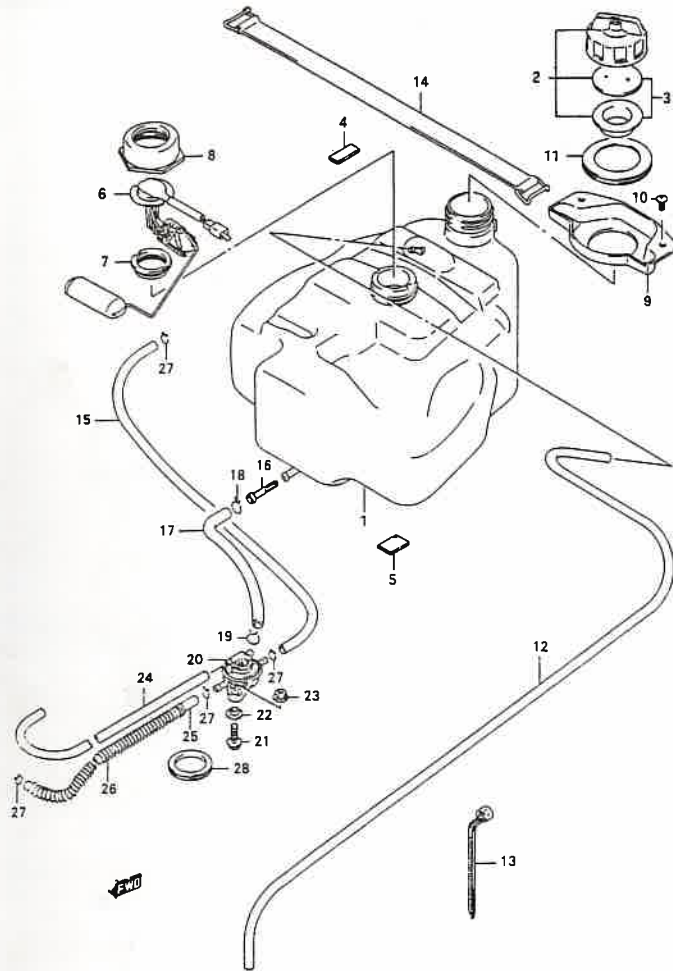

FIG. 32 (E-7) FUEL TANK

REF. NO.	PART NO.	DESCRIPTION	Q'TY	REMARKS
1	44111M20E10	TANK, fuel	1	
2	44200-39811	CAP SET, fuel tank	1	
3	44660-36810	.GASKET SET	1	
4	53145M48B00	CUSHION	2	
5	44281M29C00	CUSHION, fuel tank	5	
6	34810M20E00	GAUGE ASSY, fuel level	1	
7	34825M29C00	GASKET	1	
8	44587-29C00	CAP, fuel level gauge	1	
9	44261M20E00	TRAY, fuel drain	1	
10	02142-06103	SCREW	2	
11	44261-36C00	GROMMET, inlet	1	
12	44257-20E00	HOSE, drain	1	
13	09407-14403	CLAMP (L: 125)	2	
14	44292M20E00	BAND, fuel tank	1	
15	44236-20E00	HOSE, air vent	1	
16	44322-27001	FILTER, fuel	1	
17	44199-20E00	HOSE, inlet	1	
18	09401-11403	CLIP	1	
19	09401-10402	CLIP	1	
20	44300-11B01	COCK ASSY, fuel	1	
21	01550-06203	BOLT	1	
22	09169M06032	WASHER, fuel cock	1	
23	08316-10063	NUT	1	
24	44425-20E00	HOSE, vacuum (L: 370)	1	
25	09352-50823-600	HOSE (L:600-260)	1	
26	09440-10012	SPRING	1	
27	09401-08401	CLIP	4	
28	09308M27001	GROMMET	1	

4

FIG. 33

4

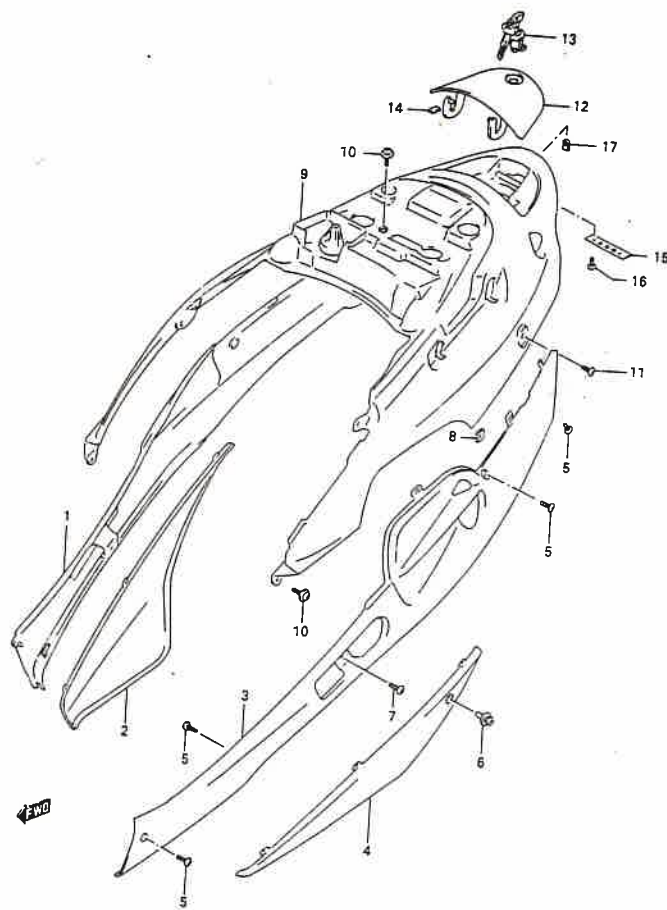

FIG. 33 (E-8) FRAME COVER

REF. NO.	PART NO.	DESCRIPTION	Q'TY	REMARKS
1	47111M20E00	COVER, side RH	1	
2	47131M20E00	COVER, side lower RH	1	
3	47211M20E00	COVER, side LH	1	
4	47231M20E10	COVER, side lower LH	1	
5	03241-05163	SCREW	7	
6	09409-06322-5PK	CLIP (BLACK)	2	
7	02142-06123	SCREW	2	
8	09148-05020	NUT	4	
9	47311M20E00	COVER, frame upper	1	
10	09136-06002	SCREW (6x12)	3	
11	03241-05163	SCREW	2	
12	47371M20E00	LID, fuel	1	
13	92100-25840	LOCK SET, upper cover lid	1	
14	47376M20E00	CUSHION, fuel lid	2	
15	47375M20E00	PLATE, fuel lid hinge	1	
16	03541-04123	SCREW	2	
17	09148-05020	NUT	1	

FIG. 34

REMARKS

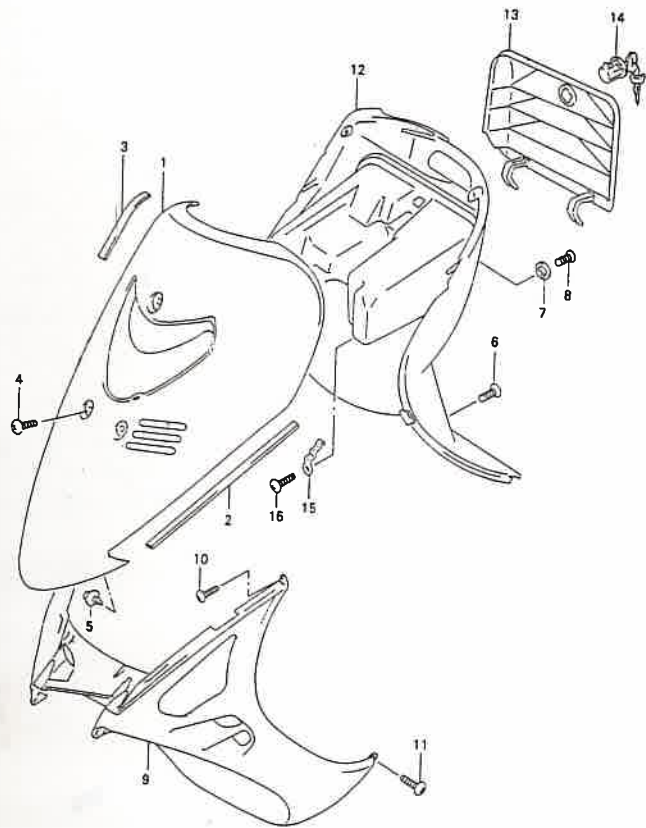
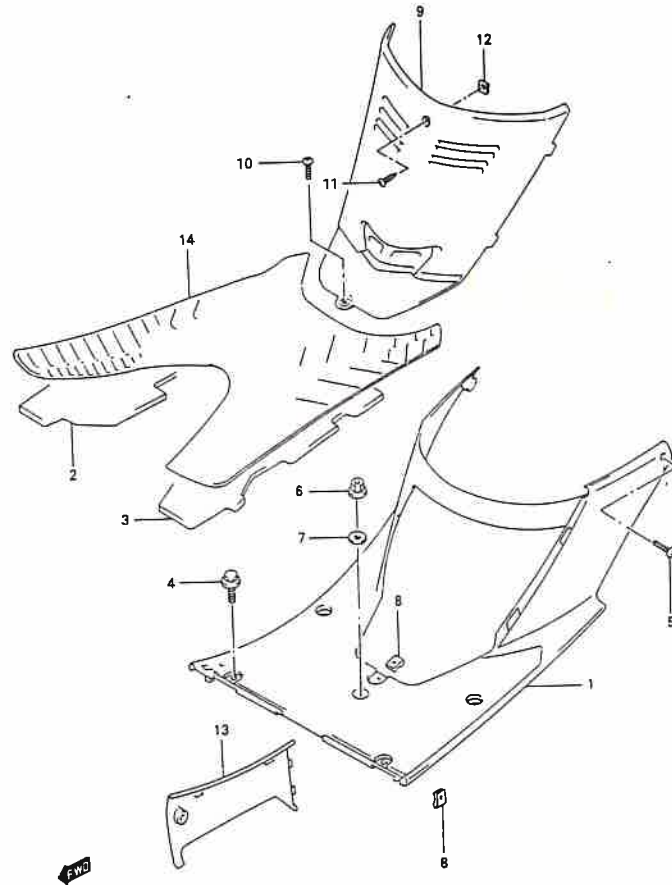

FIG. 34 (E-9) LEG SHIELD

REF. NO.	PART NO.	DESCRIPTION	QTY	REMARKS
1	48111M20E00	SHIELD, leg front	1	
2	48115M20E01	TAPE, leg shield	2	
3	48116M20E00	TAPE, leg shield, upper	2	
4	09139-06083	SCREW	3	
5	09409-06322-5PK	CLIP (BLACK)	2	
6	03541-04163	SCREW	4	
7	09169M06071	WASHER	1	
8	02142-06163	SCREW	1	
9	48137M20E00	SHIELD, leg lower	1	
10	03541-04163	SCREW	2	
11	03241-05163	SCREW	2	
12	92110M20E00	BOX, front	1	
13	92112M20E00	LID, front box	1	
14	92100-20810	LOCK SET, front box	1	
15	92113M47A00	PLATE, front box hinge	2	
16	03541-05163	SCREW	2	

4

FIG. 35



4

FIG. 35 (E-10) REAR LEG SHIELD

REF. NO.	PART NO.	DESCRIPTION	QTY	REMARK
1	48121M20E00	SHIELD, leg rear	1	
2	48125M20E00	CUSHION, leg rear RH	1	
3	48126M20E00	CUSHION, leg rear LH	1	
4	09116-06144	BOLT (6x16)	4	
5	02142-06163	SCREW	2	
6	08316-10063	NUT	1	
7	09160-08043	WASHER (8.5x18x1)	1	
8	09148-05020	NUT	4	
9	48140M20E10	LID ASSY, maintenance	1	
10	03241-05163	SCREW, lower	1	
11	03541-04123	SCREW, upper	1	
12	09148-04024	NUT	1	
13	47121M20E00	COVER, side front	1	
14	43551M20E00	MAT, floor	1	

FIG. 36

REMARKS

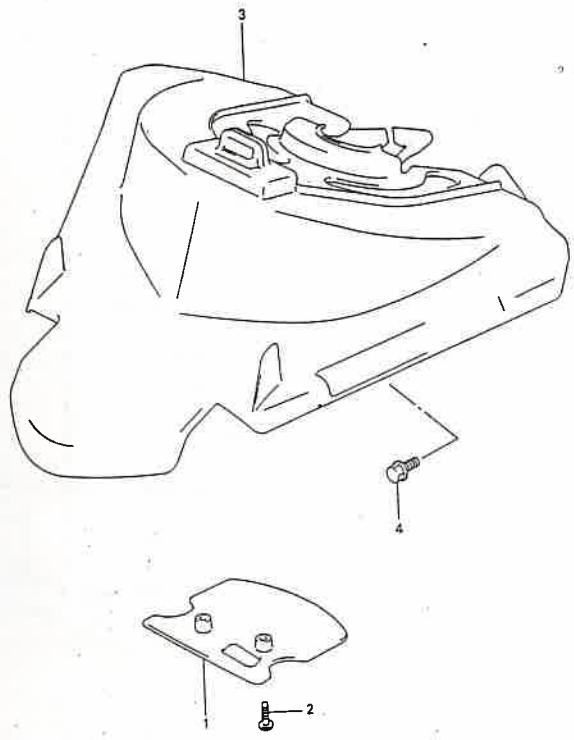

FIG. 36 (F-2) FRONT FENDER

REF. NO.	PART NO.	DESCRIPTION	Q'TY	REMARKS
1	53181M29C02	FENDER, movable front	1	
2	02142-05163	SCREW	2	
3	53182M20E00	FENDER, fixed front	1	
4	01550-06123	BOLT	1	

4

FIG. 37

FIG. 37 (F-3) HANDLEBAR

4

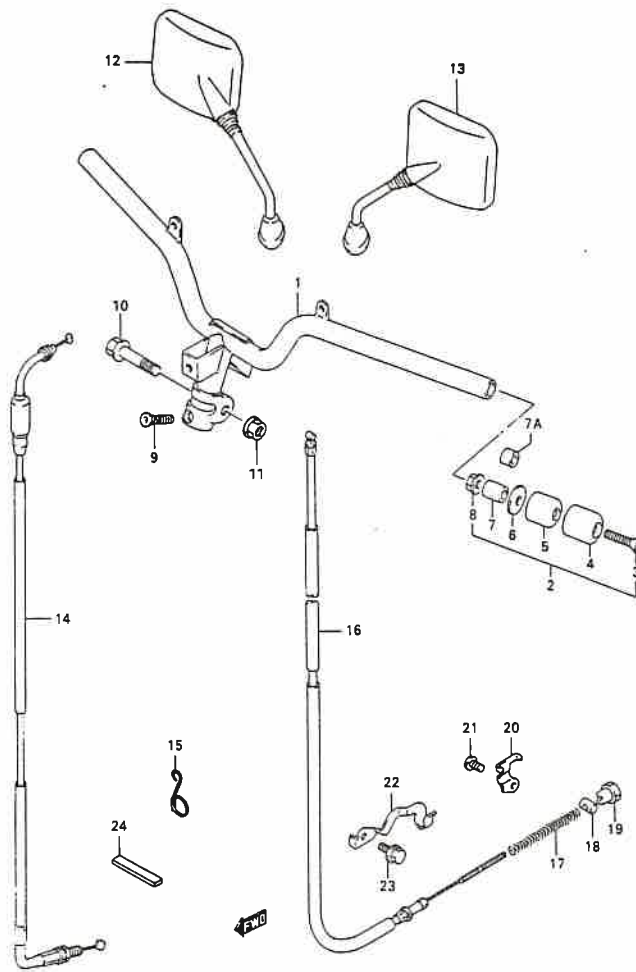

REF. NO.	PART NO.	DESCRIPTION	Q'TY	REMARKS
1	56110M20E01	HANDLEBAR	1	
2	56200-20822	BALANCER SET, handle bar	2	
3	02122-06603	.SCREW	2	
4	56274-04700	.CAP	2	
5	56271-33400	.BALANCER	2	
6	56275-34401	.SPACER	2	
7	56272M31C00	.EXPANDER ✓	2	
7A	09180-06069	.SPACER	2	
8	08316-10063	.NUT	2	
9	56123-29C00	SCREW (8x35)	1	
10	09103-10116	BOLT (10x43)	1	
11	09159-10058	NUT	1	
12	56500M20E00A	MIRROR ASSY, rear view RH	1	
13	56600M20E00A	MIRROR ASSY, rear view LH	1	
14	58300M20E10A	CABLE ASSY THROTTLE	1	
15	34938M17210	GUIDE, throttle cable	1	
16	58510M20E00A	CABLE, rear brake	1	
17	09440M07062	SPRING	1	
18	09209-10001	PIN	1	
19	09150-05101	NUT	1	
20	58575M20E00	PLATE, rear brake cable	1	
21	02112-06103	SCREW	1	
22	58621M20E00	GUIDE, rear brake cable	1	
23	01550-06123	BOLT	1	
24	47117M46400	CUSHION, throttle cable (10x60)	1	

FIG. 38

REMARKS

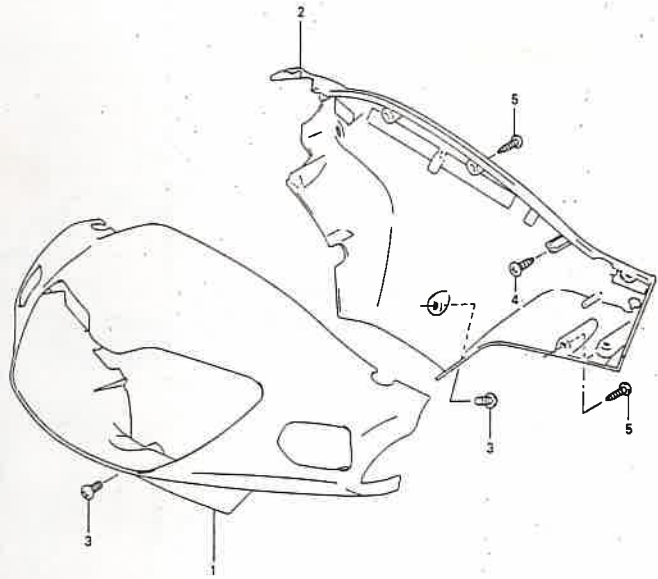

FIG. 38 (F-4) HANDLE COVER

REF. NO.	PART NO.	DESCRIPTION	Q'TY	REMARKS
1	56311M20E00	COVER, handle front	1	
2	56321M20E40	COVER, handle rear	1	
3	02142-05123	SCREW	2	
4	03511-05163	SCREW	2	
5	03541-04163	SCREW	4	

4

FIG. 39

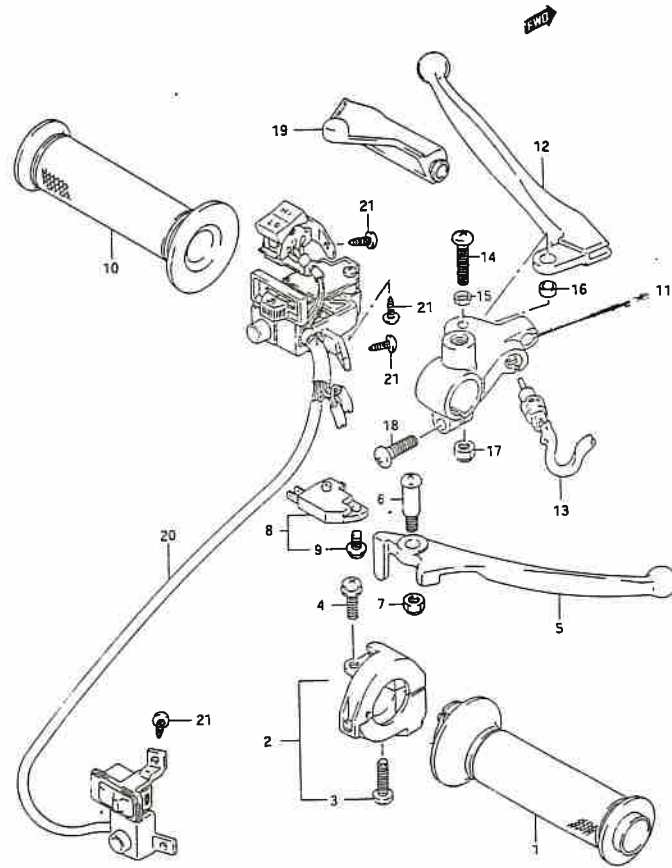

FIG. 39 (F-5) HANDLE LEVER

REF. NO.	PART NO.	DESCRIPTION	QTY	REMARKS
1	57110M29C11	GRIP, throttle	1	
2	57100-29C02	CASE ASSY, throttle	1	
3	02112-05207	.SCREW	1	
4	09136-05040	SCREW	1	
5	57421M03A11	LEVER, brake	1	
6	57431-29C00	SCREW, lever pivot	1	
7	08319-21068	NUT	1	
8	57460-17C00	SWITCH ASSY, stop	1	
9	57465-17C00	.SCREW	1	
10	57211M29C00	GRIP, LH	1	
11	57511M20E01	HOLDER LEVER	1	
12	57621M02420	.LEVER	1	
13	57470-20E00	.SWITCH ASSY	1	
14	02112-05303	.SCREW	1	
15	57336-09D00	.COLLOR	1	
16	57435-12900	.SPACER	1	
17	08319-21057	.NUT	1	
18	02112-06207	.SCREW	1	
19	57315-20E00	COVER, brake lever LH	1	
20	37200-20E30	SWITCH ASSY, handle	1	
21	03541-04123	SCREW	5	

FIG. 40

REMARKS

FIG. 40 (F-6) REAR FENDER

REF. NO.	PART NO.	DESCRIPTION	Q'TY	REMARKS
1	63111M20E00A	BODY, rear fender upper	1	
2	63211M20E00	BODY, rear fender lower	1	
3	63220M20E03	BRACKET, rear fender lower	1	
4	09111-06066	BOLT	4	
5	09160-06114	WASHER (6.5x24x1.2)	1	
6	09180-06247	SPACER (6.5x8x7)	1	
7	09320M08028	CUSHION	1	
8	02142-06163	SCREW, RH	1	
9	03541-05163	SCREW, LH	2	
10	09800-21007	TOOL ASSY	1	
11	09169-05012	WASHER	2	

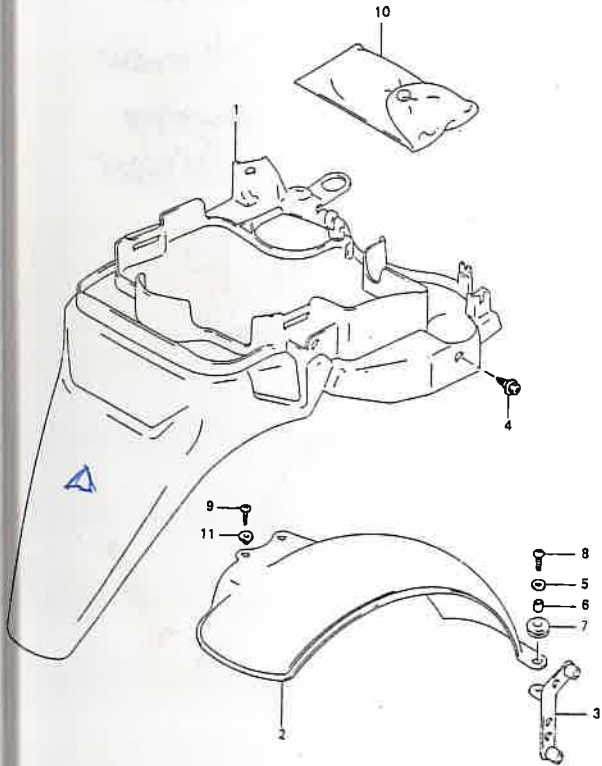

7.60



35970 401 000

Reflector

4

FIG. 41

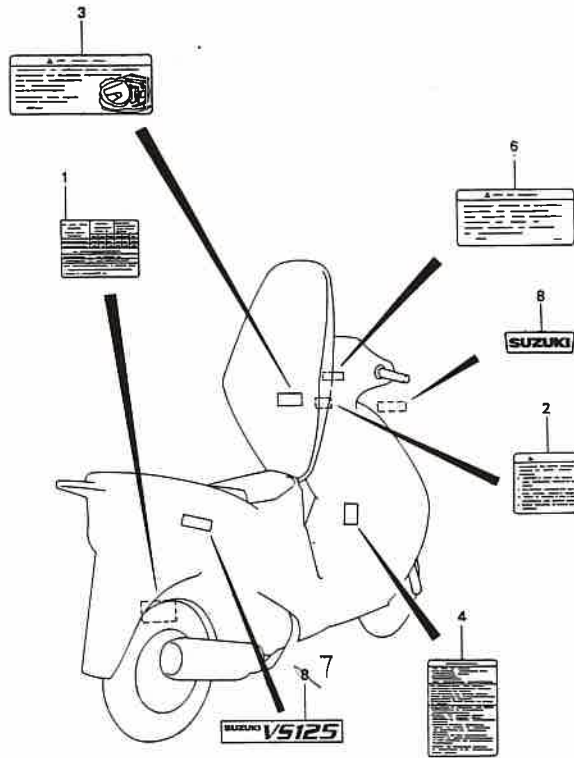

4

VS 125

FIG. 41 (F-7) LABEL

REF. NO.	PART NO.	DESCRIPTION	QTY	REMARKS
1	68332M20E99A	LABEL, tire air pressure	1	
2	68318M09E01	LABEL WARNING SAFETY	1	
3	68611M20E60	LABEL, luggage box	1	
4	68319M20E60A	LABEL, caution	1	
5	99011M20ES2-01A	MANUAL OWNER'S	1	DRAWING NOT SHOWN
6	56321M20E99A	LABEL STARTER	1	
7	68130M20E99A	EMBLEM, cover frame upper L/R	2	△20E99D
8	68190M21D99A	EMBLEM, shield leg front	1	

↓
68190M21E99E

↓ "VS125R"
△20E99E
↓ "VS150"

FIG. 42

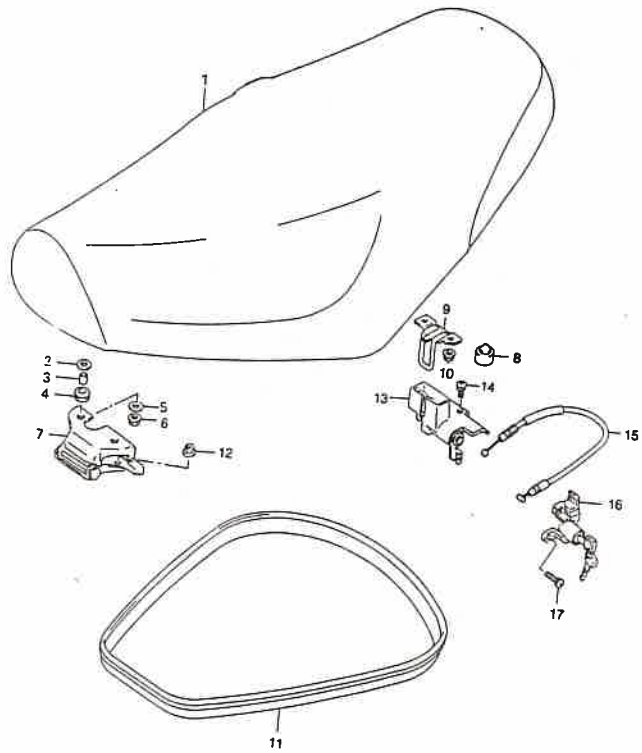

FIG. 42 (F-8) SEAT

REF. NO.	PART NO.	DESCRIPTION	Q'TY	REMARKS
1	45100M20E02	SEAT ASSY .	1	
2	08322-01067	.WASHER	1	
3	09180M06154	.SPACER	2	
4	45149M20E00	.CUSHION	2	
5	09160-06088	.WASHER	2	
6	08316-10063	.NUT	2	
7	45260M20E02	.BRACKET, front	2	
8	09321M10011	.CUSHION	1	
9	45210M20E00	.STRIKER, seat lock	2	
10	08316-10063	.NUT	1	
11	45211-20E00	MOLDING, SEAT	2	
12	08316-10063	NUT	1	
13	45700-41D10	LOCK SET, seat no. 1	2	
14	02142-06123	SCREW	1	
15	45280M20E00	CABLE, seat lock	2	
16	95700-41810	LOCK SET, seat no. 2	1	
17	02112-36163	SCREW	1	
			2	

(lower)
 * 45261M20E10A BRKT, ST fr
 * 45270M20E00A BRKT, ST
 for hinge
 (upper)

4

FIG. 43

4

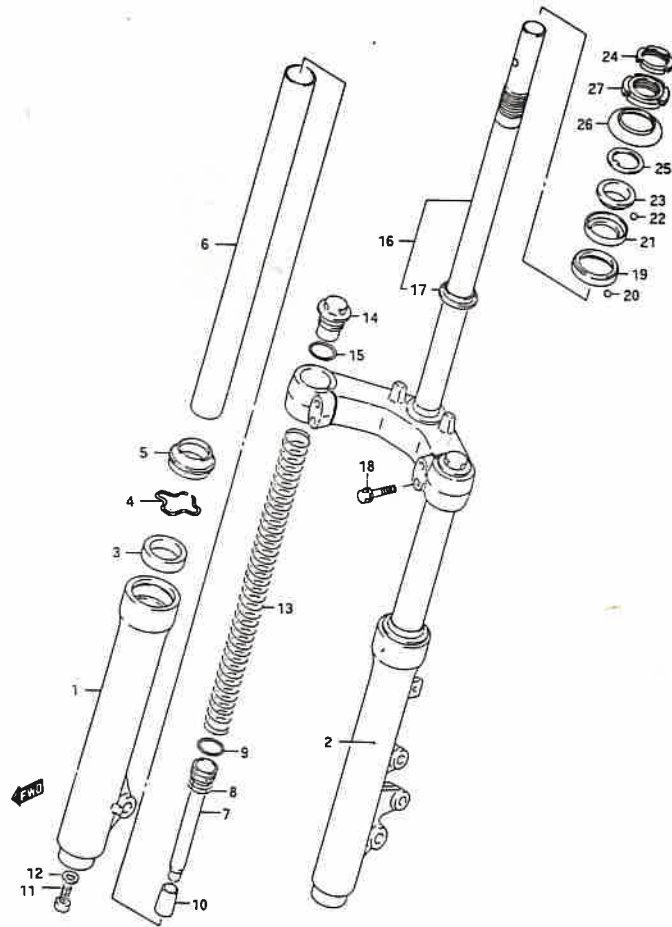

FIG. 43 (G-2) FRONT FORK

REF. NO.	PART NO.	DESCRIPTION	Q'TY	REMARKS
	51103M20E00	DAMPER ASSY RH	1	Ref. No. 1 & 3 - 15
	51104M20E00	DAMPER ASS7 LH	1	Ref. No. 2 - 15
1	51130M20E00-019	.TUBE, outer RH (Black)	1	
2	51140M20E00-019	.TUBE, outer LH (Black)	1	
3	51153M36A00	.SEAL, oil	2	
4	51156M39260	.SNAP RING	2	
5	51173M36A00	.SEAL, DUST	2	
6	51110M20E00	.TUBE, INNER	2	
7	51146M20E00	.CYLINDER	2	
8	51177M36A00	.SPRING, rebound	2	
9	51196M36A00	.RING, piston	2	
10	51195M20E00	.PIECE, oil lock	2	
11	51147M16510	.BOLT, cylinder	2	
12	51148M41310	.GASKET	2	
13	51171M20E00	.SPRING, main	2	
14	51351M39221	.CAP, fork	2	
15	09280M22001	.O RING (D: 1.4, ID: 21.8)	2	
16	51410-20E00-019	.STEM, steering (Black)	1	
17	51622-20E00	.RACE, steering outer lower	1	
18	01570-08353	.BOLT	4	
19	51612-04000	RACE, steering inner lower	1	
20	06111-06003	BALL, lower	25	
21	51611-20002	RACE, steering inner upper	1	
22	06111-06003	BALL, upper	22	
23	51621-28000	RACE, steering outer upper	1	
24	51632-02400	NUT, steering stem lock	1	
25	09166-26001	WASHER	1	
26	51643-25001	DUST SEAL, steering upper	1	
27	51631-28000	NUT, steering stem	1	

FIG. 44

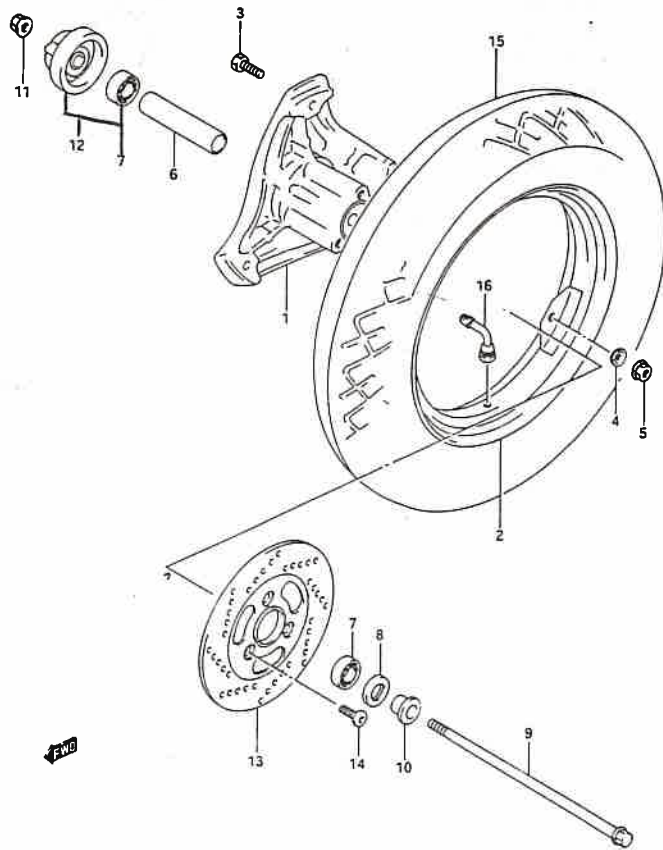
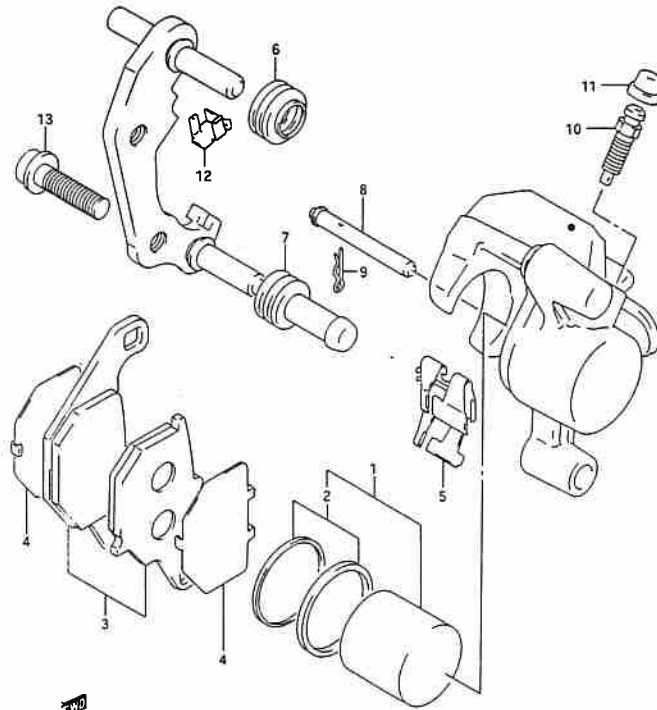

FIG. 44 (G-3) FRONT WHEEL

REF. NO.	PART NO.	DESCRIPTION	QTY	REMARKS
1	54111M20E00	HUB, front wheel	1	
2	55310M20E00	RIM, front wheel (10x2.15)	1	
3	09100-08140	BOLT (8x28)	3	
4	09164-08020	WASHER	3	
5	08319-31087	NUT	3	
6	09180M12078	SPACER (12.6x19xø1)	1	
7	08133-62017	BEARING	2	
8	09285-18002	OIL SEAL (18x32x7)	1	
9	64711-28B00	AXLE, rear	1	
10	64751-20400	SPACER, front axle LH	1	
11	08319-31128	NUT	1	
12	54600-11E00	BOX ASSY, speedometer gear	1	
13	59211-20E00	DISC, front brake	1	
14	59421-03A10	BOLT, disc	3	
15	55110M20E00	TIRE, front (3.50-10 51J) (IRC)	1	
16	43130M41D00	VALVE ASSY, wheel rim (PVR-70)	1	

4

FIG. 45



4

FIG. 45 (G-46) FRONT CALIPER

REF. NO.	PART NO.	DESCRIPTION	Q'TY	REMARKS
	59300-20E00	CALIPER ASSY, front LH	1	
1	59300-20810	.PISTON SET	1	
2	59300-20820	..SEAL SET	1	
3	59300-20830	.PAD SET	1	Δ M20830
4	59371-20E00	.SHIM	2	
5	59315-20E00	.SPRING	1	
6	59312-36500	.BOOT	1	
7	59313-36500	.INSULATOR	1	
8	69141-44B02	.PIN	1	
9	69142-45000	.CLIP	1	
10	59121-18410	.BLEEDER	1	
11	55156-66310	.CAP	1	
12	59116-20E00	.GUIDE	1	
13	07120-08303	BOLT	2	

FIG. 46

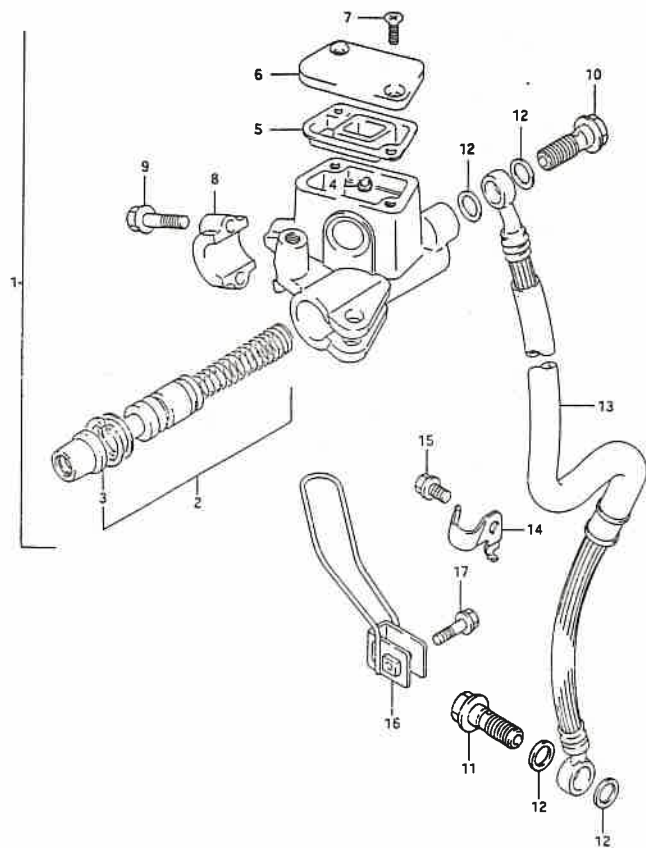

FIG. 46 (G-5) FRONT BRAKE HOSE

REF. NO.	PART NO.	DESCRIPTION	QTY	REMARKS
1	59600-36C00	CYLINDER ASSY, front master	1	
2	59600-03B10	.PISTON/CUP SET	1	
3	59666-44300	..BOOT	1	
4	59664-48B00	.PROTECTOR	1	
5	59667-03A00	.DIAPHRAGM	1	
6	59669-36C00	.CAP	1	
7	69689-49300	.SCREW	2	
8	59671-29C00	.HOLDER	1	
9	01550-06253	.BOLT	2	
10	09360-10039	BOLT, upper (10x1.00x22)	1	
11	09360-10040	BOLT, lower (10x1.25x22)	1	
12	09161-10009	WASHER (10x15x1.5)	4	
13	59480-20E00	HOSE, front brake	1	
14	59245M20E00	CLAMP, front brake hose	1	
15	01550-06103	BOLT	1	
16	59240M20E00	GUIDE, front brake hose	1	
17	01550-06203	BOLT	1	

4

FIG. 47

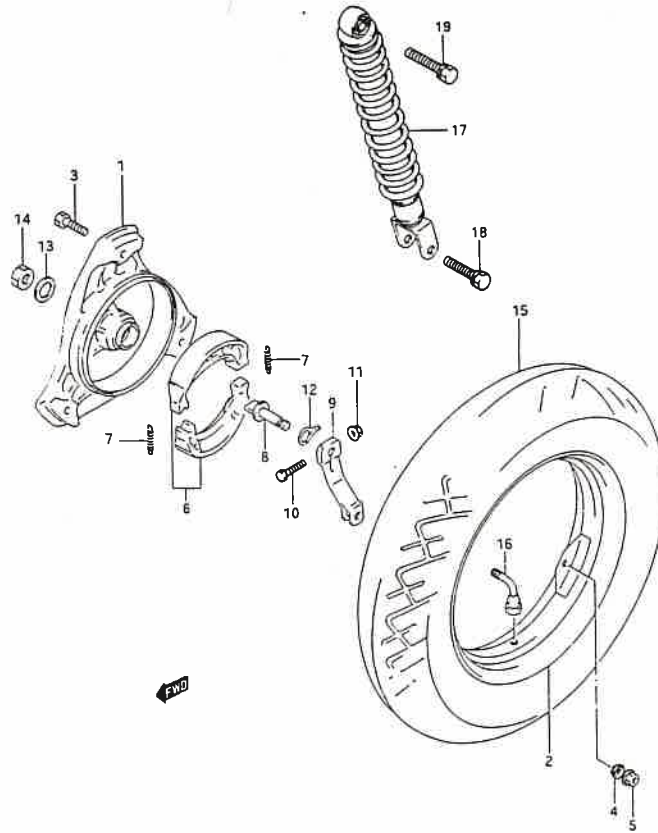

FIG. 47 (G-7) REAR WHEEL

REF. NO.	PART NO.	DESCRIPTION	QTY	REMARKS
1	64110-20E00	HUB, rear wheel	1	
2	55310M20E00	RIM, rear wheel (10x2.15)	1	
3	09100-08140	BOLT (8x28)	3	
4	09164-08020	WASHER	3	
5	08319-31087	NUT	3	
6	54400-03810	SHOE SET, brake	1	
7	55421-20E00	SPRING, brake shoe	2	
8	64441-11E01	CAM, rear brake	1	
9	64451-20E00	LEVER, rear brake cam	1	
10	09100-06139	BOLT	1	
11	08316-10063	NUT	1	
12	64492-17B02	PLATE, indicator	1	
13	09160-16039	WASHER	1	
14	08319-21168	NUT	1	
15	65110M20E00	TIRE, rear (3.50-10 51J (IRC)	1	
16	43130M41D00	VALVE ASSY, wheel rim (PVR-70)	1	
17	62100M20E00	ABSORBER ASSY, rear shock	1	
18	01570-10353	BOLT, lower	1	
19	01570-10403	BOLT, upper	1	

PART NO.	FIG. NO. REF. NO.	PART NO.	FIG. NO. REF. NO.	PART NO.	FIG. NO. REF. NO.
10000		12510-20E10	6 - 14	13382-20E20	10 - 38
		12521-20E10	6 - 9	13383-20E20	10 - 41
		12600-20E21	7 - 4	13386-09A10	10 - 2
		12611-20E00	7 - 1	13387-20E20	10 - 40
		12633-05300	7 - 5	13388-20E20	10 - 37
11100-20E20	2 - 1	12649-20E02	7 - 8*	13389-20E20	10 - 36
11115-20E70	2 - 2	12710-20E50	8 - 1	13393-10010	10 - 39
11141-20E00	2 - 6	12741-20E00	8 - 8	13421-20E20	10 - 20
11171-20E10	1 - 1	12747-30A01	8 - 3	13430-20E90	10 - 49
11173-20E10	1 - 2	12760-20E00	9 - 1	13434-30650	10 - 17
11176-20E01	1 - 6	12771-20E00	9 - 2	13488-20E20	10 - 50
11177-20E00	1 - 7	12811-20E00	9 - 3	13493-20E20	10 - 12
11186-20E20	1 - 9	12812-30A00	9 - 4	13494-09A10	10 - 22
11210-20E20 OF 20E21	3 - 1	12830-20E00	9 - 6	13495-09A00	10 - 9
11241-20E01	3 - 2	12837-19B10	9 - 7	13495-18E00	10 - 10
11280-20E00	4 - 19	12840-20E00	8 - 8	13496-20E20	10 - 14
11310-20E20	4 - 1	12842-49Z01	8 - 9	13500-20E20	10 - 34
11320-20E20	4 - 3	12843-27A00	8 - 10	13502-20E20	10 - 48
11325-20E00	4 - 12	12861-20E00	8 - 11	13503-20E20	10 - 33
11340-20E00	5 - 1	12911-20E00	8 - 12	13601-04148	10 - 5
11346-20E40	5 - 11	12912-20E00	8 - 13	13650-25E01	10 - 52
11350-20E10	5 - 27	12920-30A01	8 - 14	13674-20E20	10 - 15
11383-20E00	5 - 6	12931-09A00	8 - 15	13684-34A10	10 - 8
11389-09D00	5 - 7	12932-27A00	8 - 16	13700-20E00	11 - 1
11393-20E00	5 - 21	12933-39E00	8 - 17	13721M20E99A	11 - 19
11401-20E41	1 - 12	13110-20E02	2 - 13	13740M20E00	11 - 2
11430-20E11	5 - 13	13131-20E00	10 - 51	13780-20E00	11 - 3
11482-20E10	5 - 2	13200-20E00	10	13810-20E00	11 - 4
11483-20E10	5 - 29	13222-60A10	10 - 13	13821M39C00	11 - 5
11485-20E00	5 - 15	13247-28A00	10 - 6	13850-20E00	11 - 6
11486-20E00	5 - 16	13250-05300	10 - 45	13859-14D40	11 - 6A
11971-33210	5 - 28	13251-20E20	10 - 29	13859-41B10	11 - 7
12111-20E03-0F0	6 - 19-1	13254-92311	10 - 44	13881-20E00	11 - 8
12111-20E03-050	6 - 19-2	13267-20E20	10 - 1	13890-20E00	11 - 9
12111-20E03-100	6 - 19-3	13268-37420	10 - 3	13892-20E00	11 - 15
12140-20E10	6 - 20-1	13268-47070	10 - 24	13893-20E00	11 - 14
12140-20E10-050	6 - 20-2	13279-45400	10 - 23	13981M20E00	11 - 16
12140-20E10-100	6 - 20-3	13291-29900	10 - 25	14181-37D10	12 - 1
12151-20E10	6 - 21	13295-29900	10 - 26	14305-20E30	12 - 2
12161-20E10-0B0	6 - 2	13357-36A00	10 - 21	14780M20E00	12 - 3
12200-20E04	6 - 1	13370-20E20	10 - 42	16321-20E00	6 - 16
12211-20E02	6 - 3	13373-11400	10 - 46	16331-20E00	13 - 3
12221-20E11	6 - 5	13374-44080	10 - 43	16410-20E00	13 - 1
12260-20E10	6 - 6	13376-84110	10 - 43A	16421-20E00	13 - 6
12359-20E00	6 - 15	13382-03110	10 - 31	16422-20E00	13 - 4

PART NO.	FIG. NO. REF. NO.	PART NO.	FIG. NO. REF. NO.	PART NO.	FIG. NO. REF. NO.
16423-20E00	13 - 5	27601-20E10	15 - 23	34810M20E00	32 - 6
16510-05240	13 - 7			34825M29C00	32 - 7
16512-18900	13 - 8			34910M20E10	22 - 11
16520-09402	13 - 9			34938M17210	37 - 15
16523-20E00	13 - 10			34938M20E00	22 - 12
16524-20E00	13 - 11			34938M20E10	22 - 14
17110-20E00	14 - 1			35100-20E00-999	23 - 1
17120-20E10	14 - 2			35159-20E00	23 - 2
17122-20E00	14 - 3			35171-20E00	23 - 4
17130-20E00	14 - 6			35601-20E20	24 - 1
17132-20E00	14 - 8	31100-20E00	18 - 1	35602-20E20	24 - 6
17133-20E00	14 - 9	31130-32C20	18 - 4	35612-20E20	24 - 2
17134-20E00	14 - 10	31132-32C10	18 - 3	35638-20E20	24 - 3
17136-20E00	14 - 11	31133-32C10	18 - 5	35632-20E20	24 - 7
17160-20E10	5 - 34	31135-32C10	18 - 7	35638-20E20	24 - 8
		31150-06C00	18 - 13	35652-20E00	25 - 4
		31156-38300	18 - 9	35672-20E00	25 - 5
		31175-20E00	18 - 2	35710-20E20	25 - 1
		31264-32C10	18 - 10	35712-20E00	25 - 2
		31281-20E00	18 - 8	35912-20E00	25 - 7
21110-11E02	15 - 1	31361-32C10	18 - 12	36110-20E00	23 - 10
21120-11E12	15 - 2	31361-38300	18 - 11	36112-20E00	23 - 11
21122-20E01	15 - 24	31800-49100	21 - 1	36258-70C30	23 - 13
21124-11E00	15 - 3	31861M06C00	21 - 5	36610M20E61	26 - 1
21125-20E00	15 - 15	31861M10D00	21 - 6	37100-20E01	26 - 6
21210-20E20	15 - 4	31861M31500	26 - 2	37146-03A00	26 - 19
21213-41D03	15 - 5	32101-20E20	19 - 1	37146-03A10	26 - 20
21220-20E01	16 - 1	32102-20E20	19 - 2	37146-03A20	26 - 21
21240-20E01	15 - 6	32800-22D00	21 - 7	37146-03A30	26 - 22
21243-20E00	15 - 21	32900-20EA0	21 - 9	37155M29C00	26 - 7
21431-20E20	15 - 7	32980M20E00	21 - 10	37200-20E30	39 - 20
21471-03A03 - 13A11	15 - 8	33410-20E01	21 - 11	37840-20E00	26 - 10
21481-11E00	15 - 9	33510-20E00	21 - 14	38500-20E10	26 - 15
21501-20E01	16 - 2	33541-47D00	21 - 15	38590M20E00	26 - 17
21650-04C10	15 - 10	33542-20E10	21 - 16	38610-31X50	24 - 12
24131-20E01	16 - 5	33610M41D50	20 - 1	38740-24X50	26 - 12
24141-11E10	16 - 14	33652M29100	20 - 2		
24150-20E00	16 - 6	33652M31C00	20 - 3		
24152-20E00	16 - 7	33810M20E00	21 - 4		
24371-20E00	16 - 15	34100M20E41	22 - 1		
24751-11E00	16 - 20	34111M20E30	22 - 4		
26210-11E00	17 - 1	34210M20E40	22 - 2		
26280-11E20	15 - 28	34150M39C01	22 - 3		
26282-11E01	15 - 29	34173M20E00	22 - 7		
26300M04C03	17 - 9	34383M09400	22 - 6		

5

5

PART NO.	FIG. NO. REF. NO.	PART NO.	FIG. NO. REF. NO.	PART NO.	FIG. NO. REF. NO.
40000		45210M20E00	42 - 9	51351M39221	43 - 14
		45211-20E00	42 - 11	51410-20E00-019	43 - 16
		45260M20E02	42 - 7	51611-20002	43 - 21
		45280M20E00	42 - 15	51612-04000	43 - 19
		45700-41D10	42 - 13	51621-28000	43 - 23
41100M20E01-019	27 - 1	46310M20E10A	31 - 3	51622-20E00	43 - 17
41150M29C03	27 - 2	47111M20E00	33 - 1	51631-28000	43 - 27
41180-20840	27 - 5	47117M46400	37 - 24	51632-02400	43 - 24
41185-41D00	27 - 9	47121M20E00	35 - 13	51643-25001	43 - 26
41541M20E00A	28 - 1	47131M20E00	33 - 2	53145M48B00	32 - 4
41542M20E00A	28 - 3	47211M20E00	33 - 3	53181M29C02	36 - 1
41545M20E00	28 - 5	47231M20E10	33 - 4	53182M20E00	36 - 3
42100M20E00	29 - 1	47311M20E00	33 - 9	54111M20E00	44 - 1
42191M20E00	29 - 7	47371M20E00	33 - 12	54400-03810	47 - 6
42211-20E01	29 - 2	47375M20E00	33 - 15	54600-11E00	44 - 12
42270M20E01	29 - 6	47476M20E00	33 - 14	55110M20E00	44 - 15
42310M20E10A	29 - 12	48111M20E00	34 - 1	55156-66310	45 - 11
43130M40D00	44 - 16	48115M20E00	34 - 2	55310M20E00	44 - 2
	47 - 16	48116M20E00	34 - 3	59480-20E00	46 - 13
43551M20E00	35 - 14	48121M20E00	35 - 1	55421-20E00	47 - 7
43600M20E00	30 - 1	48125M20E00	35 - 2	56110M20E01	37 - 1
43610M20E00	30 - 2	48126M20E00	35 - 3	56123-29C00	37 - 9
43618M20E00	30 - 3	48137M20E00	34 - 9	56200-20822	37 - 2
43631M20E00	30 - 4	48140M20E00	35 - 9	56271-33400	37 - 5
43700M20E00	30 - 7			56272M31C00	37 - 7
43719M20E00	20 - 8			56274-04700	37 - 4
43718M20E00	30 - 9			56275-34401	37 - 6
43731M20E00	30 - 10			56311M20E00	38 - 1
43980M20E00	31 - 1			56321M20E40	38 - 2
44111M20E00	32 - 1			56321M20E99A	41 - 6
		50000			
44199-20E00	32 - 17	51103M20E00	43	56500M20E00A	37 - 12
44200-39811	32 - 2	51104M20E00	43	56600M20E00A	37 - 13
44236-20E00	32 - 15	51110M20E00	43 - 6	57100-29C02	39 - 2
44257-20E00	32 - 12	51130M20E00-019	43 - 1	57110M29C11	39 - 1
44261M20E00	32 - 9	51140M20E00-019	43 - 2	57211M29C00	39 - 10
44261-36C00	32 - 11	51146M20E00	43 - 7	57315-20E00	39 - 19
44281M29C00	32 - 5	51147M16510	43 - 11	57336-09D00	39 - 15
44292M20E00	32 - 14	51148M41310	43 - 12	57421M03A11	39 - 5
44300-11B01	32 - 20	51153M36A00	43 - 3	57431-29C00	39 - 6
44322-27001	32 - 16	51156M39260	43 - 4	57435-12900	39 - 16
44425-20E00	32 - 24	51171M20E00	43 - 13	57460-17C00	39 - 8
44587-29C00	32 - 8	51173M36A00	43 - 5	57465-17C00	39 - 9
44660-36810	32 - 3	51177M36A00	43 - 8	57470-20E00	39 - 13
45100M20E02	42 - 1	51195M20E00	43 - 10	57511M20E01	39 - 11
45149M20E00	42 - 4	51196M36A00	43 - 9	57621M02420	39 - 12

PART NO.	FIG. NO. REF. NO.	PART NO.	FIG. NO. REF. NO.	PART NO.	FIG. NO. REF. NO.
58300M20E10A	37 - 14	65110M20E00	47 - 15		46 - 17
58510M20E00A	37 - 16	68130M20E99A	41 - 7	01550-06253	13 - 16
58575M20E00	37 - 20	68190M21D99A	41 - 8		46 - 9
58621M20E00	37 - 22	68319M20E60A	41 - 4	01550-08123	4 - 17
59116-20E00	45 - 12	68318M09E01	41 - 2		5 - 23
59121-18410	45 - 10	68332M20E99A	41 - 1		26 - 16
59211-20E00	44 - 13	68611M20E60	41 - 3	01550-08163	30 - 13
59240M20E00	46 - 16	69141-44B02	45 - 8	01570-06123	5 - 22
59245M20E00	46 - 14	69142-45000	45 - 9	01570-08353	43 - 18
59300-20E00	45	69689-49300	46 - 7	01570-10353	47 - 18
59300-20810	45 - 1			01570-10403	47 - 19
59300-20820	45 - 2			01804M06165	28 - 4
59300-20830	45 - 3			02112-03083	10 - 35
59312-36500	45 - 6			02112-03163	10 - 18
59313-36500	45 - 7	90000		02112-04063	10 - 19
59315-20E00	45 - 5	92100-20810	34 - 14	02112-05087	10 - 47
59371-20E00	45 - 4	92100-25840	33 - 13	02112-05103	19 - 3
59421-03A10	44 - 14	92110M20E00	34 - 12	02112-05107	10 - 4
59480-20E00	46 - 13	92112M20E00	34 - 13	02112-05123	5 - 9
59600-03810	46 - 2	92113M47A00	34 - 15	02112-05203	19 - 4
59600-36C00	46 - 1	92210M20E01	27 - 10	02112-05207	39 - 3
59664-48B00	46 - 4	95700-41810	42 - 16	02112-05303	39 - 14
59666-44300	46 - 3	99011M20E52-01A	41 - 5	02112-06103	37 - 21
59667-03A00	46 - 5			02112-06207	39 - 18
59669-36C00	46 - 6			02112-06253	5 - 3
59671-29C00	46 - 8				18 - 15
				02112-06303	11 - 17
				02112-06353	5 - 31
				02112-06403	5 - 4
				02112-06453	5 - 32
		00000			
		01421-06123	13 - 15	02112-06503	4 - 7
		01421-06253	2 - 9	02112-16163	14 - 12
			3 - 5	02112-16203	14 - 14
		01500-06203	9 - 8	02112-16253	14 - 13
		01500-08203	17 - 10	02112-16303	14 - 15
					21 - 13
62100M20E00	47 - 17	01500-10163	4 - 15	02112-34123	18 - 6
63111M20E00A	40 - 1	01550-06103	46 - 15	02112-36163	42 - 17
63211M20E00	40 - 2	01550-06107	26 - 3	02112M74103	22 - 5
63220M20E03	40 - 3	01550-06123	5 - 25	02112-06163	2 - 15
64110-20E00	47 - 1		26 - 18		
64441-11E01	47 - 8				16 - 21
64451-20E00	47 - 9			02122-06253	13 - 2
64492-17B02	47 - 12			02122-06603	37 - 3
64711-28B00	44 - 9	01550M06203	26 - 8	02142-04103	15 - 25
64751-20400	44 - 10		32 - 21	02142-05123	38 - 3

PART NO.	FIG. NO. REF. NO.	PART NO.	FIG. NO. REF. NO.	PART NO.	FIG. NO. REF. NO.
02142-05163	11 - 13 36 - 2	04221-04069 06111-06003	6 - 17 43 - 20	08331-31226 08331-41286	16 - 18 15 - 22
02142-05203	22 - 13		43 - 22	08331-41478	16 - 13
02142-06103	22 - 15 32 - 10	07120-05203 07120-06253	1 - 8 5 - 17	08341-31039 08361-35068	19 - 6 21 - 3
02142-06123	33 - 7	07120-06353	5 - 18	09100-06139	47 - 10
02142-06163	42 - 14 34 - 8 35 - 5 40 - 8	07120-08203 07120-08253 07120-08303 07120-08903	12 - 10 31 - 2 45 - 13 4 - 8	09100-08140 09103-06102 09103-08342	44 - 3 47 - 3 2 - 4 29 - 9
02142-06203	21 - 8	07130-06163	7 - 12	09103-10116	37 - 10
02142-06203	26 - 11	07130-08353	31 - 4	09103-12046	4 - 5
03211-04163	24 - 5	07130-08553	4 - 9		27 - 7
	24 - 10	08110-62030	16 - 19	09106-07015	1 - 3
03211-04203	25 - 8	08113-62017	16 - 11	09106-07017	1 - 5
03212-04169	23 - 12		16 - 12	09106-08084	5 - 30
03241-05163	25 - 11 33 - 5 33 - 11 34 - 11	08133-62017 08221-25353 08310-00123 08313-10063	44 - 7 15 - 27 4 - 6 13 - 17	09108-08163 09108-08222 09111-06041 09111-06066	3 - 3 3 - 4 8 - 5 28 - 2
	35 - 10	08316-10063	2 - 10		28 - 6
03511-05123	23 - 3		3 - 6		40 - 4
03511-05163	38 - 4		26 - 9	09111-10014	29 - 15
03511-14163	24 - 11		27 - 3	09116-06144	35 - 4
03541-04123	23 - 9		32 - 23	09118-08147	12 - 4
	33 - 16 35 - 11 39 - 21		35 - 6 37 - 8 42 - 6	09125-05121 09125-06092 09128-06004	5 - 12 6 - 10 21 - 2
03541-04163	23 - 15 34 - 6		42 - 10 42 - 12	09136-05040 09136-05051	39 - 4 23 - 6
	34 - 10 38 - 5 22 - 10 34 - 16 40 - 9	08316-10103 08316-10123 08319-21057	47 - 11 15 - 30 16 - 4 19 - 5 39 - 17	09136-06002 09137-05004 09139-06083 09139-06091 09140-16005	33 - 10 18 - 15 34 - 4 12 - 9 15 - 11
03541-06163	11 - 18	09319-21068	39 - 7	09140-22008	6 - 18
03541-06203	14 - 16	08319-21168	47 - 14	09140-28004	16 - 3
04111-25158	30 - 6	08319-31087	44 - 5	09148-04024	35 - 12
	30 - 12		47 - 5	09148-05020	25 - 10
04111-30208	29 - 4	08319-31126	27 - 8		33 - 8
04211-11169	2 - 11 3 - 7 5 - 5 5 - 10	08319-31128 08322-01063 08322-01067	44 - 11 21 - 12 42 - 2	09148-05038 09150-05101	33 - 17 35 - 8 25 - 9 37 - 19
04211-13189	4 - 11	08331-31146	17 - 8	09159-08049	2 - 7

PART NO.	FIG. NO. REF. NO.	PART NO.	FIG. NO. REF. NO.	PART NO.	FIG. NO. REF. NO.	PART NO.	FIG. NO. REF. NO.
09159-10058	37 - 11	09181-32019	6 -23-4	09280-24003	18 - 14		
09159-10097	29 - 16	09181-32020	6 -23-5	09280-32006	2 - 14		
09160-05037	23 - 8	09181-32021	6 -23-6	09280-41005	15 - 19		
09160-06028	12 - 5	09181-32022	6 -23-7	09280-54001	13 - 13		
09160-06088	42 - 5	09181-32023	6 -23-8	09283-20054	16 - 8		
09160-06114	40 - 5	09181-32024	6 -23-9	09283-20055	6 - 12		
09160-08043	35 - 7	09181-32025	6 -23-10	09283-25095	6 - 13		
09160-14053	17 - 7	09181-32026	6 -23-11	09283-27010	16 - 17		
09160-16039	47 - 13	09181-32027	6 -23-12	09284-34002	15 - 20		
09161-10009	46 - 12	09181-32028	6 -23-13	09285-18002	44 - 8		
09161-11008	1 - 4	09181-32029	6 -23-14	09289-05011	8 - 18		
09161-14010	17 - 6	09181-32030	6 -23-15	09300-14011	17 - 5		
09164-08020	29 - 8	09181-32031	6 -23-16	09308M27001	32 - 28		
	44 - 4	09181-32032	6 -23-17	09319-10032	5 - 14		
	47 - 4	09181-32033	6 -23-18	09319-12049	27 - 6		
09164-14012	17 - 3	09181-32102	7 - 10	09319-12051	4 - 2		
09164-16005	15 - 12	09200-06057	30 - 5		4 - 4		
09166-26001	43 - 25		30 - 11	09320-07015	23 - 7		
09168-06004	5 - 26	09201-05006	15 - 16	09320M08028	40 - 7		
	9 - 5	09206-08001	2 - 5	09320M08051	12 - 7		
09168-06024	5 - 33	09206-11004	5 - 19	09320-09016	14 - 5		
09168-08008	4 - 21	09206-13016	7 - 2	09320M12058	12 - 8		
	5 - 24	09209-10001	37 - 18	09321-10007	5 - 8		
09168-08015	4 - 18	09250-06004	31 - 5	09321M10011	42 - 8		
09168-08016	4 - 10	09250M07001	27 - 4	09321M10012	29 - 11		
09168-08021	2 - 8	09250M20E99A	27 - 11	09321M10029	29 - 10		
09168-10002	4 - 16	09250-30003	14 - 7	09343-07150	4 - 13		
09168-10007	4 - 23	09259-20008	1 - 10	09352-30503-600	10 - 7		
09169-05012	40 - 11	09261-05005	8 - 6	09352-50823-600	32 - 25		
09169M06032	32 - 22	09261-10003	7 - 6	09360-08011	4 - 20		
09169-06071	34 - 7	09262-15028	15 - 17	09360-10032	4 - 22		
09180-05042	15 - 13	09262-15029	8 - 2	09360-10039	46 - 10		
09180-06069	37 - 7A	09262-20069	16 - 9	09360-10040	46 - 11		
09180-06247	40 - 6	09262-20106	16 - 10	09380-32002	7 - 11		
09180M06154	42 - 3	09262-22027	16 - 16	09381-10004	2 - 3		
09180-06263	14 - 4	09262-25118	6 - 11	09381-14001	6 - 22		
09180M06306	12 - 6	09262-32011	6 - 8	09390-32001	8 - 7		
09180M12078	44 - 6	09263-17042	15 - 18	09401-08401	32 - 27		
09180-12129	15 - 14	09263-28027-0B0	6 - 4	09401-10402	32 - 19		
09180-13009	7 - 3	09263-32008	7 - 9	09401-11403	4 - 14		
09180-19013	6 - 7	09280-00024	5 - 20				
09181-14195	17 - 4	09280-08014	10 - 11	09401-14301	32 - 18		
09181-32016	6 -23-1	09280-13004	13 - 12	09402-38306	11 - 11		
09181-32017	6 -23-2	09280-17003	1 - 11	09402-46208	5 - 35		
09181-32018	6 -23-3	09280M22001	43 - 15	09402-48208	2 - 16		
					5 - 36		

5

5

PART NO.	FIG. NO. REF. NO.	PART NO.	FIG. NO. REF. NO.	PART NO.	FIG. NO. REF. NO.	PART NO.	FIG. NO. REF. NO.	PART NO.	FIG. NO. REF. NO.	PART NO.	FIG. NO. REF. NO.
09402-58208 ✓	11 - 10										
09404-06429 ✗	11 - 12										
09404-06432 ✗	10 - 53										
	10 - 16										
	21 - 17										
09407-14403 ✗	26 - 4										
	26 - 5										
	32 - 13										
09407-25401 ✗	26 - 5										
09408-00012 ✗	26 - 13										
09408-00021 ✗	26 - 14										
09409-06322-5PK ✗	33 - 6										
	34 - 5										
09440-03004 ✓	7 - 7										
09440M07062 ✗	37 - 17										
09440-10012 ✗	32 - 26										
09440-18002 ✗	13 - 14										
09440-30009 ✗	15 - 26										
09443M12036 ✗	29 - 13										
09443M17023 ✓	29 - 5										
09443M21005 ✗	29 - 14										
09448-30016 ✗	17 - 2										
09471M12028 ✗	22 - 8										
09471M12077 ✗	22 - 9										
09471-12081 ✗	23 - 14										
09471-12107 ✗	25 - 6										
09471-12114 ✗	24 - 4										
	24 - 9										
09471-12128 ✗	25 - 3										
09471-12168 ✗	23 - 5										
09481M15001 ✗	26 - 2A										
09482-00456 M	2 - 12-2										
09482-00516 M	2 - 12-1										
09491-23015 ✗	10 - 17										
09491-97003 ✓	10 - 32										
09492-35008 ✓	10 - 30										
09494-00904 ✗	10 - 28										
09800-21007 ✗	40 - 10										