

1577111 1000 1/2001



SUZUKI ***FX110***

PARTS CATALOGUE

2001

FX110



PHOTO : FX110

checked 17/6/2015

PREFACE

When it becomes necessary to replace parts on SUZUKI MOTORCYCLES, always use SUZUKI GENUINE PARTS which have passed a strict inspection which guarantees quality and performance.

This parts catalogue covers the list of all service parts for SUZUKI FD110MST.

INSTRUCTIONS FOR QUOTING THE CATALOGUE

1. DIMENSIONS

Dimension of the parts in this catalogue are indicated in unit millimeters.

2. ABBREVIATIONS

Abbreviations used in this catalogue are as follows:

AR	: As required	NT	: Number
ASSY	: Assembly	OPT	: Optional
E.No.	: Engine number	OS	: Over size
F.No.	: Frame number	STD	: Standard
d	: Diameter of material	T	: Thickness
ID	: Inside diameter	US	: Under size
OD	: Outside diameter	W	: Width
L	: Length		
LH	: Left hand side		
RH	: Right hand side		
~100045	: Up to F.No.BE43A-100045		
100046~	: From F.No.BE43A-100046		

12 X 34 X 5.6 ----- Figures in the description column
show the dimension of parts.

ID OD T(or W,L)

=>12345-56781 (Part No.) : indicates that the parts number was changed to 12345-56781 and the new parts are interchangeable with the former ones but the former ones not interchangeable with new ones.

<-12345-56781 (Part no.) : indicates that the former and new parts are interchangeable with each other and both are usable.

INFORMATION
ILLUSTRATION INDEX

1

ENGINE
TRANSMISSION

2

ELECTRICAL

3

BODY

4

PARTS NUMBER INDEX

5

FIG. 1

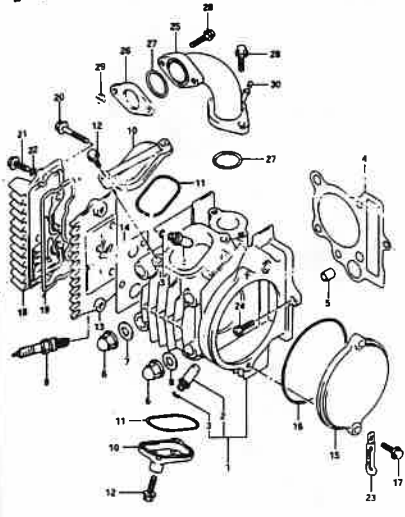

FIG. 2

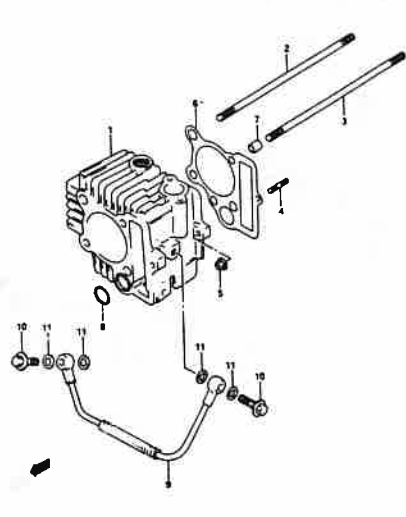

FIG. 3

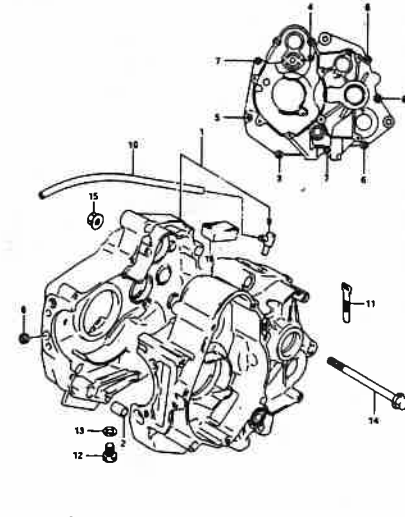

FIG. 4

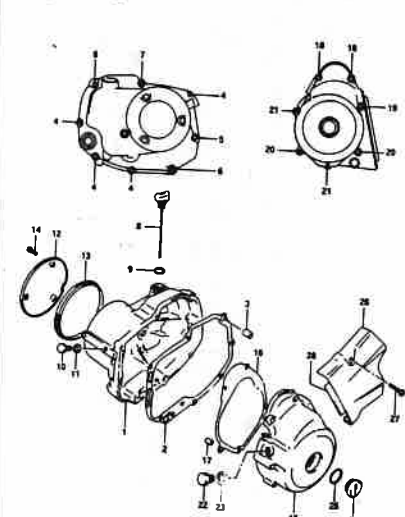

FIG. 5

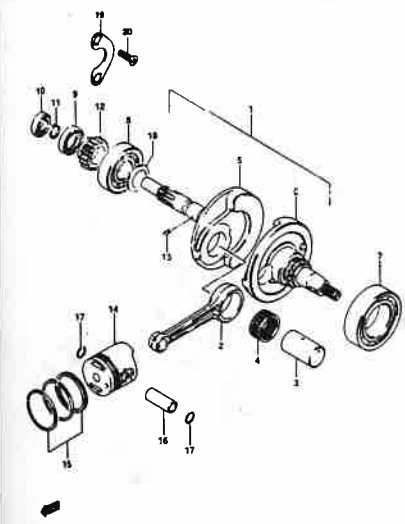

FIG. 6

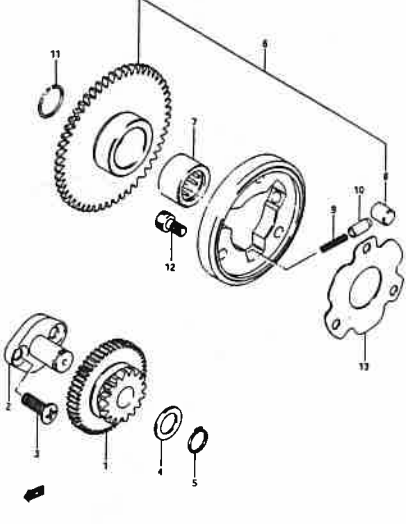

FIG. 7

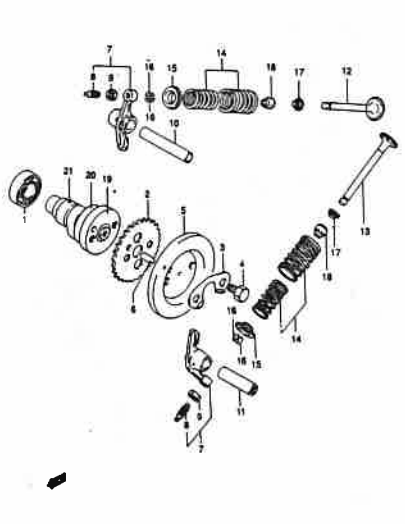

FIG. 8

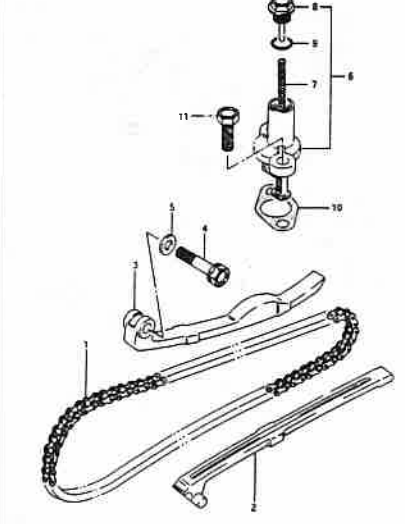

FIG. 9

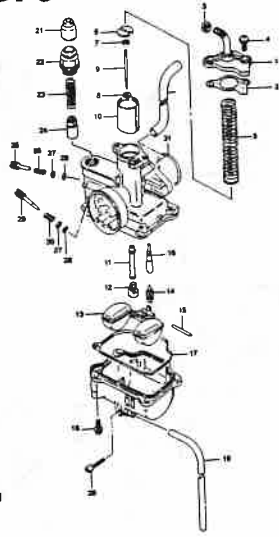

FIG. 10

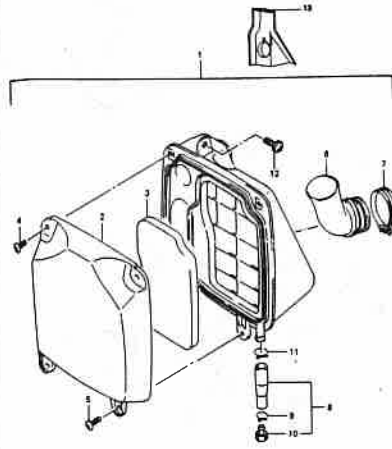

FIG. 11

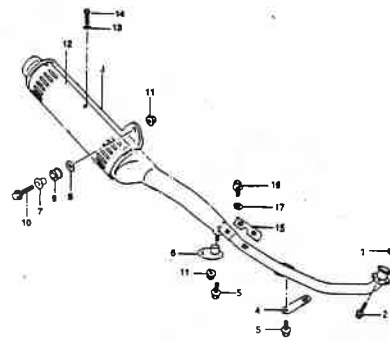

FIG. 12

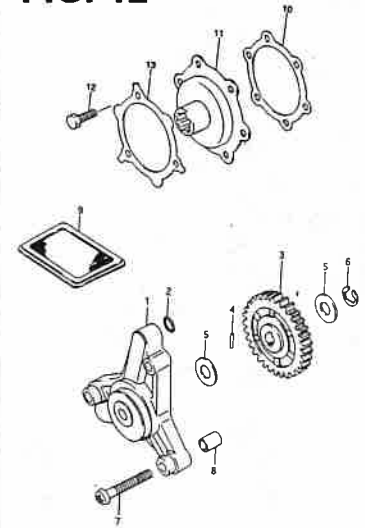

FIG. 13

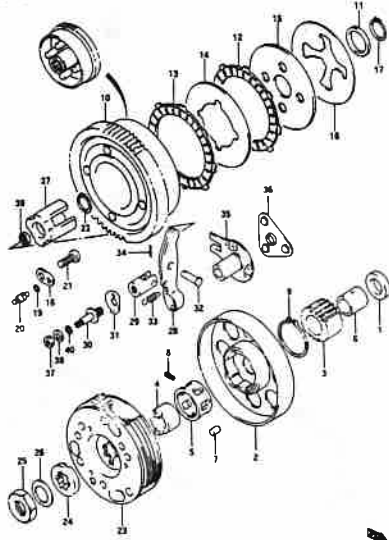

FIG. 14

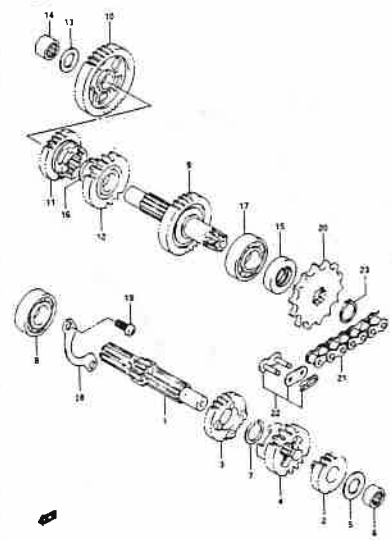

FIG. 15

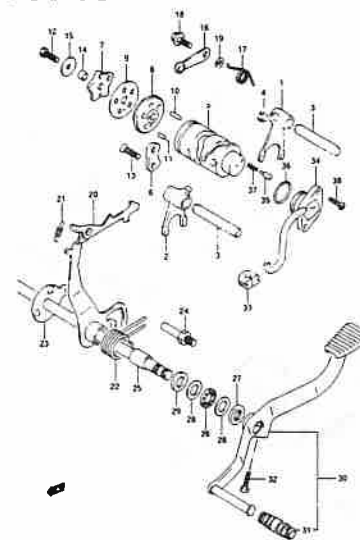

FIG. 16

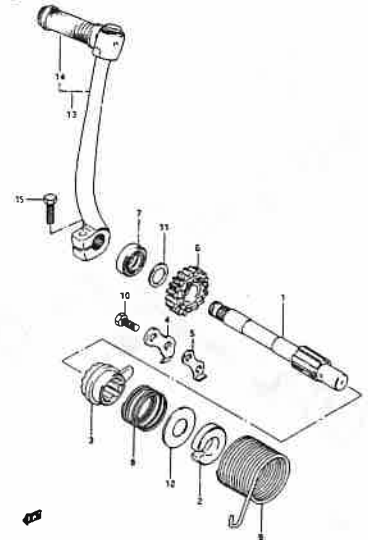

FIG. 17

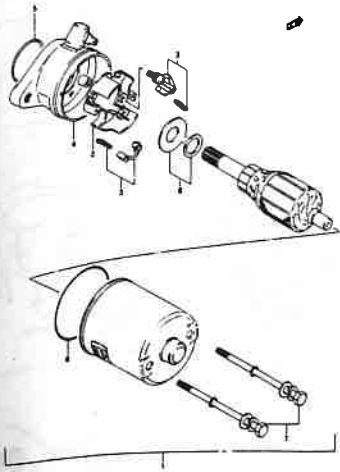

FIG. 18

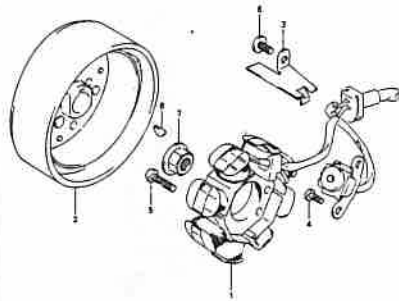

FIG. 19

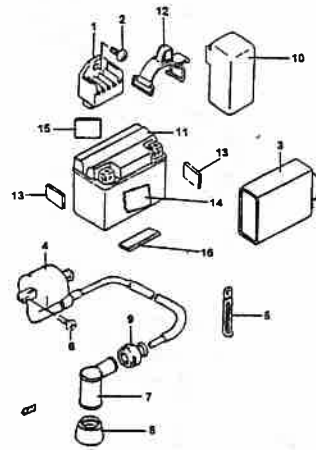

FIG. 20

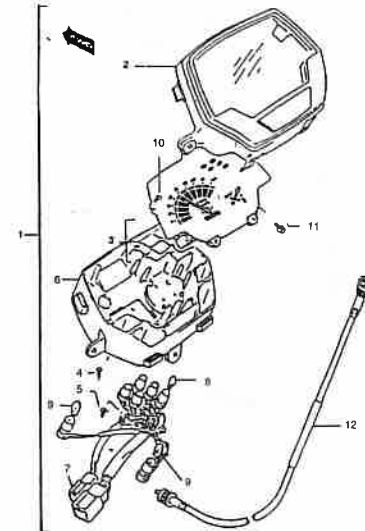

FIG. 21

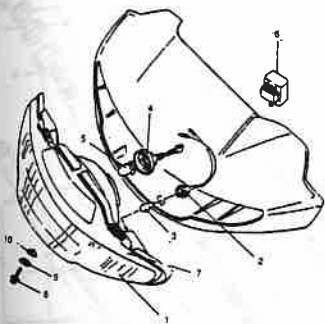

FIG. 22

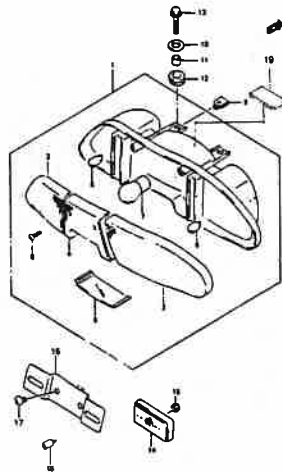

FIG. 23

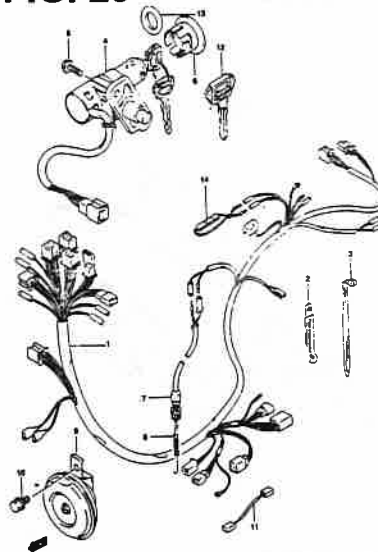

FIG. 24

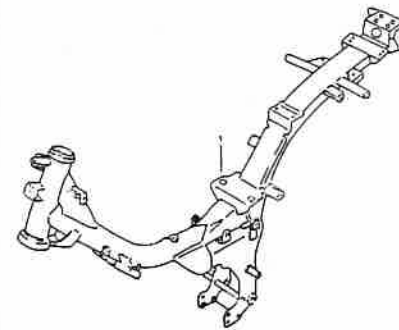

FIG. 33

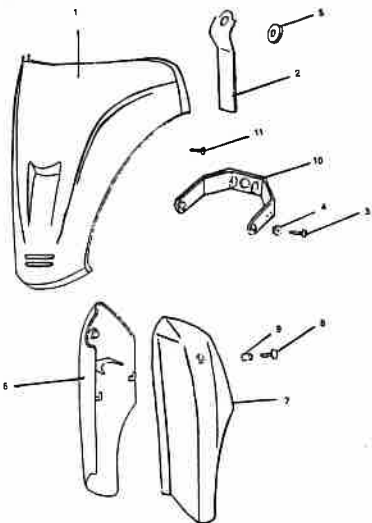

FIG. 34

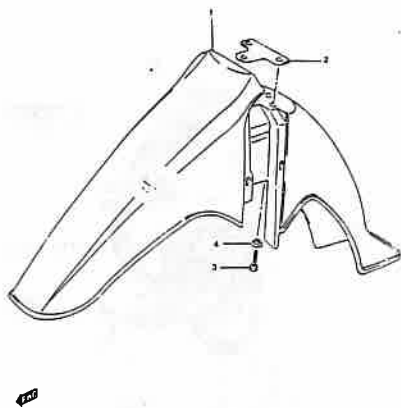

FIG. 35

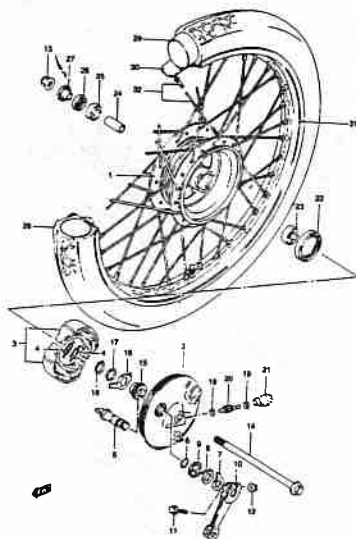

FIG. 36

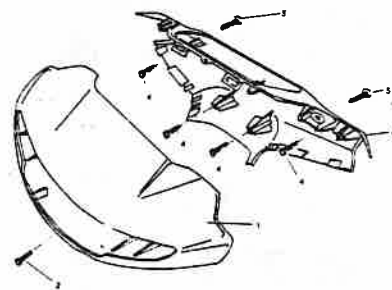

FIG. 37

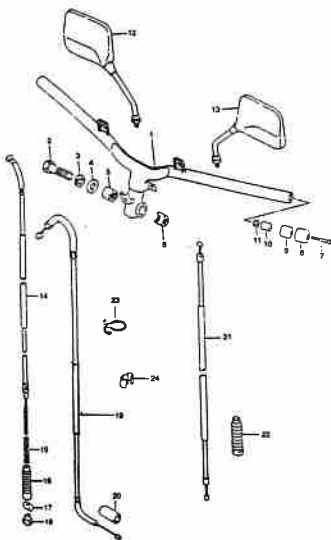
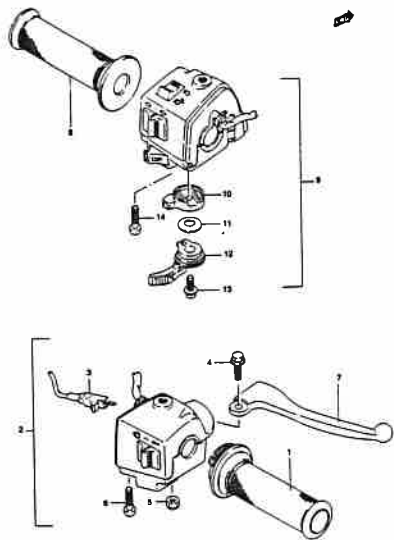

FIG. 38



1

FIG. 41

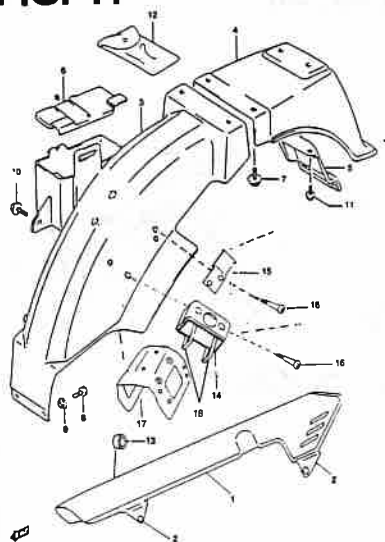

FIG. 42

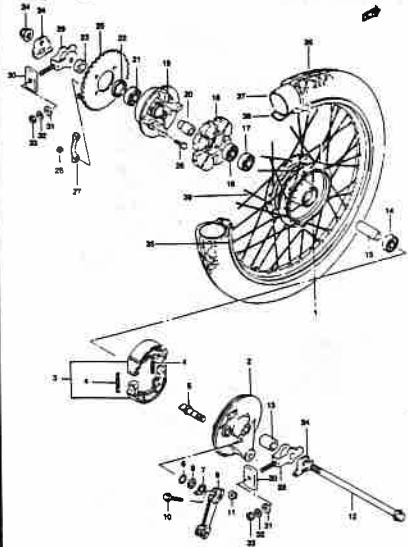

FIG. 43



FIG.



FX

FIG. 1

FIG. 1 (B-2) CYLINDER HEAD

REF. NO.	PART NO.	DESCRIPTIONS	QTY	REMARKS
1	(N) 11110-30D01	HEAD, cylinder	1	11110-30D01
2	(N) 11115-30D70	GUIDE, valve <i>GSX</i>	2	
3	09381-10004	.RING	2	
4	(N) 11141-30D00	GASKET, cylinder head	1	
5	04211-11129	.PIN	2	
6	09159-08049	NUT	4	
7	09168-08021	GASKET	1	
8	09160-08039	WASHER	3	
9	09482M00340	SPARK PLUG	1	
10	11175M09400	CAP, inspection	2	11175-09400
11	09280-50007	O RING	2	
12	01550-06253	BOLT	4	
13	(N) 11134M09D01	COVER, cylinder head (RH)	1	
14	(N) 11135M09D00	GASKET, head cover	1	
15	(N) 11121M30A01	COVER, cylinder head (LH)	1	Discontinued
16	09280-84002	O RING	1	
17	01550-06203	BOLT	2	
18	(N) 11149M09D01	COVER, cyl head cover No.2	1	
19	(N) 11144-09D00	O RING, cyl head cover No.2	1	
20	09103-06143	BOLT, cyl head cover No.2	2	
21	09103-06144	BOLT, cyl head cover No.2	3	
22	09168-06004	WASHER, cyl head cover No.2	1	
23	09404-06429	CLAMP (L:45)	1	
24	09128-06049	BOLT (6x16)	1	
25	(N) 13110-30D00	PIPE, intake	1	13110-30D10
26	(N) 13129-30A00	INSULATOR, carburetor	1	
27	09280-24005	O RING	2	
28	01547-06253	BOLT	4	
29	09140-06023	NUT	2	
30	(N) 13131-30D00	JET, boost hose	1	

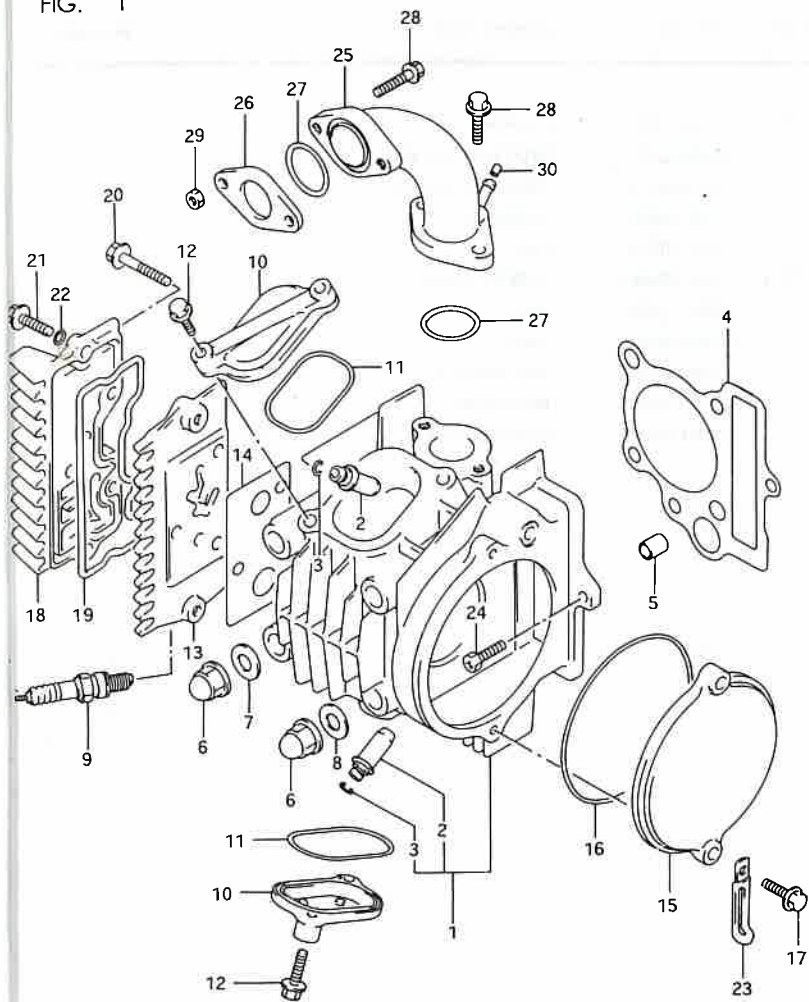

FX110

2

FIG. 2

2

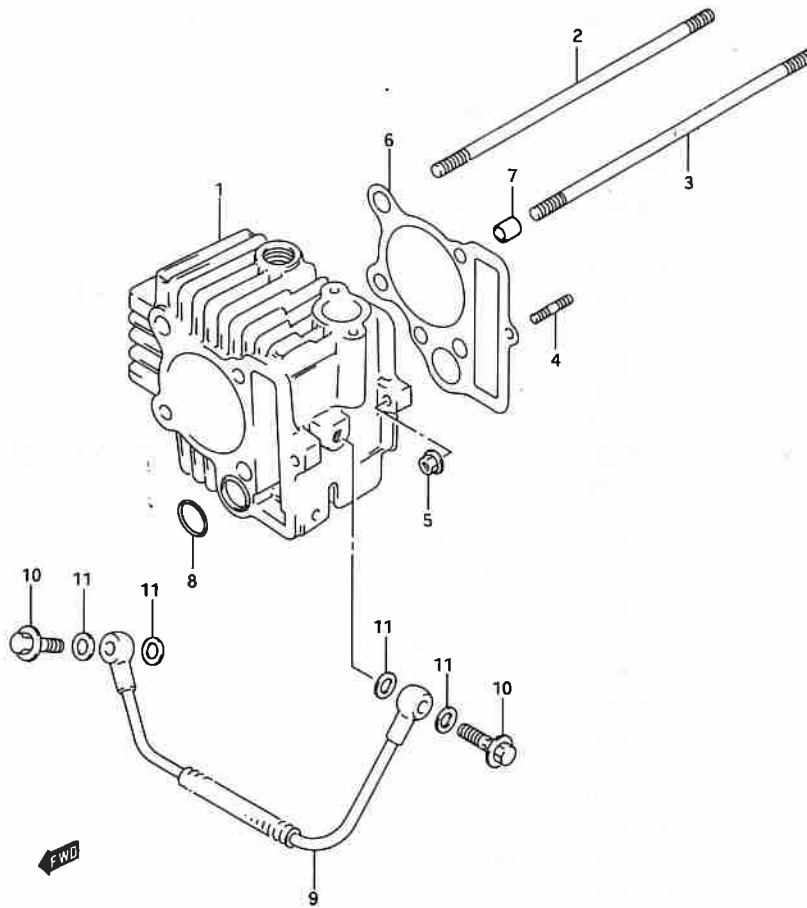

FX110

FIG. 2 (B-3) CYLINDER

REF. NO.	PART NO.	DESCRIPTIONS	QTY	REMARKS
1	11211M30D00-0F0	CYLINDER	1	
2	09108-08171	STUD BOLT (8X192)	2	
3	09108-08172	STUD BOLT (8X197)	2	
4	01421-06208	STUD BOLT	1	
5	08316-10063	NUT	1	
6	11241M30D00	GASKET, cylinder	1	
7	04211-11129	PIN	2	
8	09280-15014	O RING	1	
9	11280-30D00	PIPE, cylinder oil	1	
10	09360-08012	BOLT, union	2	
11	09168-08016	GASKET, oil pipe	4	

FIG. 3

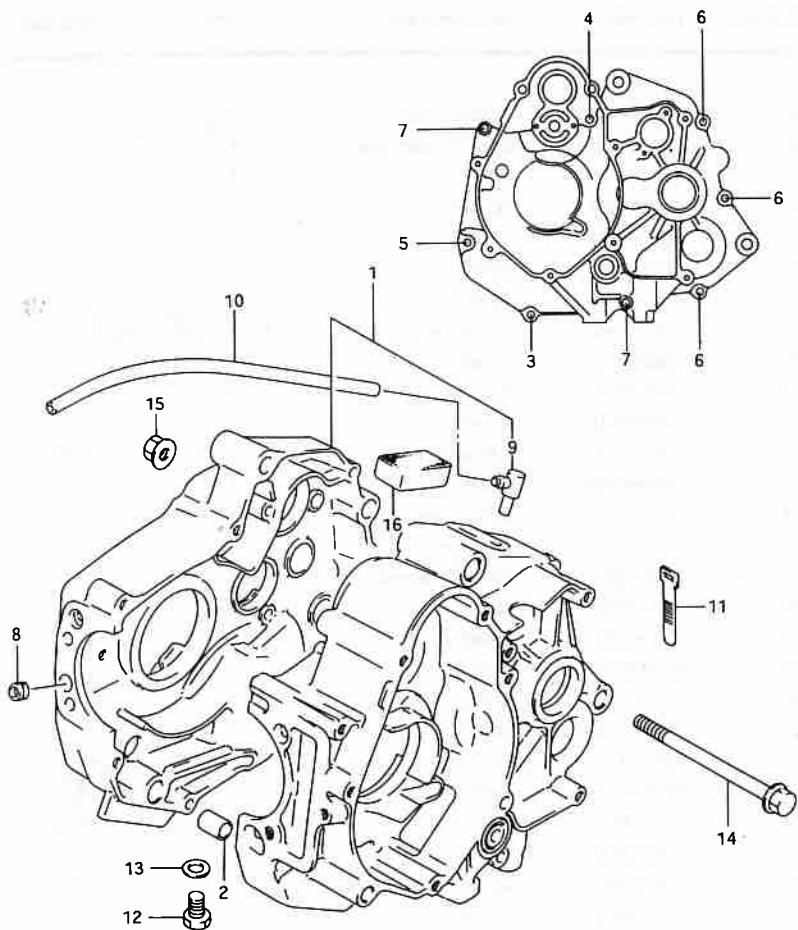

FIG. 3 (B-4) CRANKCASE

REF. NO.	PART NO.	DESCRIPTIONS	Q'TY	REMARKS
X	11300M30D00	CRANKCASE ASSY	1	Electric start (Discontinued) kick start
1	11300M30D00	CRANKCASE ASSY	1	
2	04211-13189	.PIN	2	
3	02112-06303	.SCREW	1	
4	02112-06353	.SCREW	1	
5	02112-06403	.SCREW	1	
6	02112-06503	.SCREW	3	
7	02112-06753	.SCREW	2	
8	11329-30D00	.PLATE, oil jet	1	
9	16910-30D00	.UNION, breather hose	1	
10	09359-50823-600	HOSE	1	
11	09407-08401	CLAMP	1	
12	01500-10163	PLUG, oil drain	1	
13	09168-10002	GASKET	1	
14	09103-10087	BOLT (L:105)	2	
15	08319-31105	NUT	2	
16	11186-30D00	SEPARATOR, oil breather	2	

2

FWD

FX110

FIG. 4

2

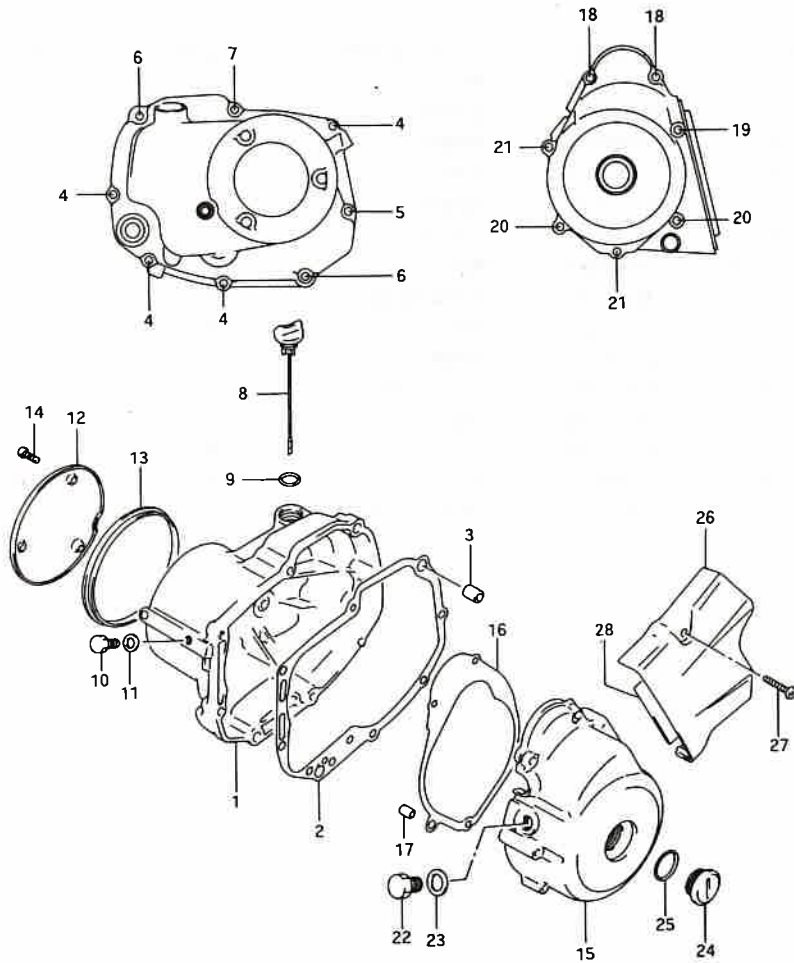

FX110

FIG. 4 (B-5) CRANKCASE COVER

REF. NO.	PART NO.	DESCRIPTIONS	QTY	REMARKS
1	11340M30D10	COVER, clutch	1	
2	11482M30A10	GASKET, clutch cover	1	
3	04211-13189	PIN	2	
4	02112-06253	SCREW	4	
5	02112-06353	SCREW	1	
6	02112-06503	SCREW	2	
7	02112-06553	SCREW	1	
8	11971-09402	GAUGE, oil level	1	GSX/FD 11971-09403
9	09280-17003	O RING	1	
10	01500-08127	PLUG, oil check	1	
11	09168-08015	GASKET	1	
12	11383M30D10A	CAP, clutch cover	1	11383-30D10-20H
13	11389M09D00	CUSHION, CAP	1	
14	02112-05163	SCREW, cap	3	
15	11351M30D10	COVER, magneto	1	
16	11483M30A10	GASKET, magneto cover	1	
17	04211-09129	PIN	2	
18	02112-06853	SCREW	2	
19	02112-06303	SCREW	1	
20	02112-06403	SCREW	2	
21	02112-06503	SCREW	2	
22	09247-12104	PLUG, top	1	
23	09168-12002	GASKET	1	
24	09259-26011	PLUG, hole	1	
25	09280-22008	O RING	1	
26	11361M30D10	COVER, engine sprocket	1	11360-20P10-20
27	02112-06303	SCREW	2	
28	11362M30D00	DAMPER, engine sprkt cover	1	

FIG. 5

FIG. 5 (B-6) CRANKSHAFT

REF. NO.	PART NO.	DESCRIPTIONS	Q'TY	REMARKS
1	12200-30D03	CRANKSHAFT ASSY <i>FC10</i>	1	
2	<i>(W)</i> 12161-30D01-0C0	.ROD, connecting	1	<i>12161-30D01-0C0</i>
3	<i>(W)</i> 12211-09D11-0A0	.PIN, crank	1	
4	<i>(W)</i> 09263-28029-0B0	.BEARING	1	
5	12220-30D02	.CRANKSHAFT, RH <i>FX</i>	1	<i>12220-30D10</i>
6	12260-30D03	.CRANKSHAFT, LH	1	
7	<i>(W)</i> 09262-35021-0A0	BEARING	1	
8	09262-25117	BEARING	1	
9	09282-20005	OIL SEAL	1	
10	<i>(W)</i> 09262-12001	BEARING	1	
11	08331-41286	CIRCLIP, crank brg, r	1	
12	<i>(W)</i> 16321-30A02	GEAR, oil pump drive	1	<i>discarded</i>
13	04221-03059	PIN	1	
14-1	12111M30D03-0F0	PISTON	1	<i>12111-09G10-0FG</i>
14-2	12111M30D03-050	PISTON	1	
14-3	12111M30D03-100	PISTON	1	
15-1	<i>(W)</i> 12140-30D10	RING SET, piston	1	
15-2	12140-30D10-050	RING SET, piston	1	
15-3	12140-30D10-100	RING SET, piston	1	
16	<i>(W)</i> 12151-30D01	PIN, piston	1	
17	09381-14001	CIRCLIP	2	
18-1	<i>(W)</i> 09181-25051	SHIM (T:0.60)	1	
18-2	09181-25052	SHIM (T:0.65)	1	
18-3	09181-25053	SHIM (T:0.70)	1	
18-4	09181-25054	SHIM (T:0.75)	1	
18-5	09181-25055	SHIM (T:0.80)	1	
18-6	09181-25056	SHIM (T:0.85)	1	
18-7	09181-25057	SHIM (T:0.90)	1	
18-8	09181-25058	SHIM (T:0.95)	1	
18-9	09181-25059	SHIM (T:1.00)	1	
18-10	09181-25060	SHIM (T:1.10)	1	
18-11	09181-25061	SHIM (T:1.10)	1	
18-12	09181-25062	SHIM (T:1.15)	1	
18-13	09181-25061	SHIM (T:1.10)	1	

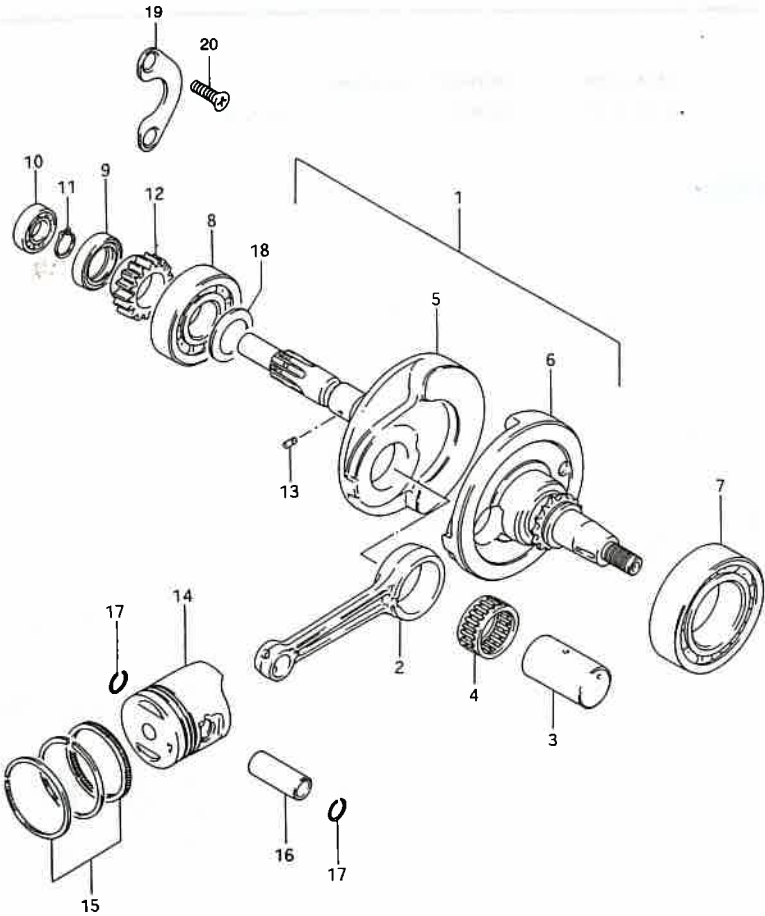

FX110

2

FIG. 5

2

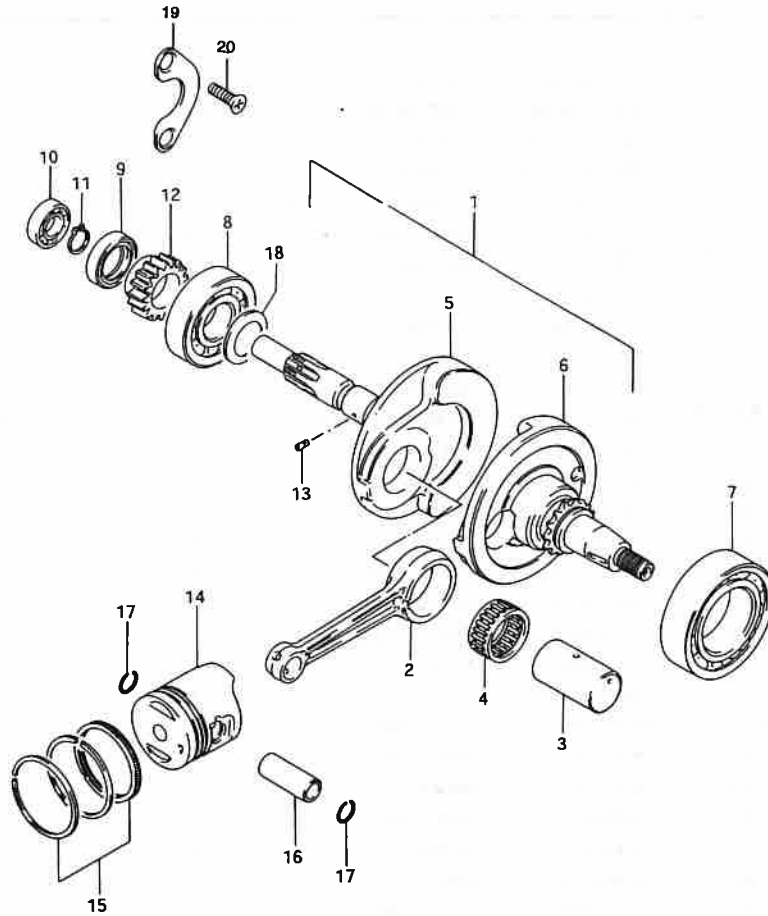

FWD

FX110

FIG. 5 (B-7) CRANKSHAFT

REF. NO.	PART NO.	DESCRIPTIONS	Q'TY	REMARKS
19	12548-09D00	RETAINER, shaft oil seal	1	
20	02122-05123	SCREW	2	

FIG. 6

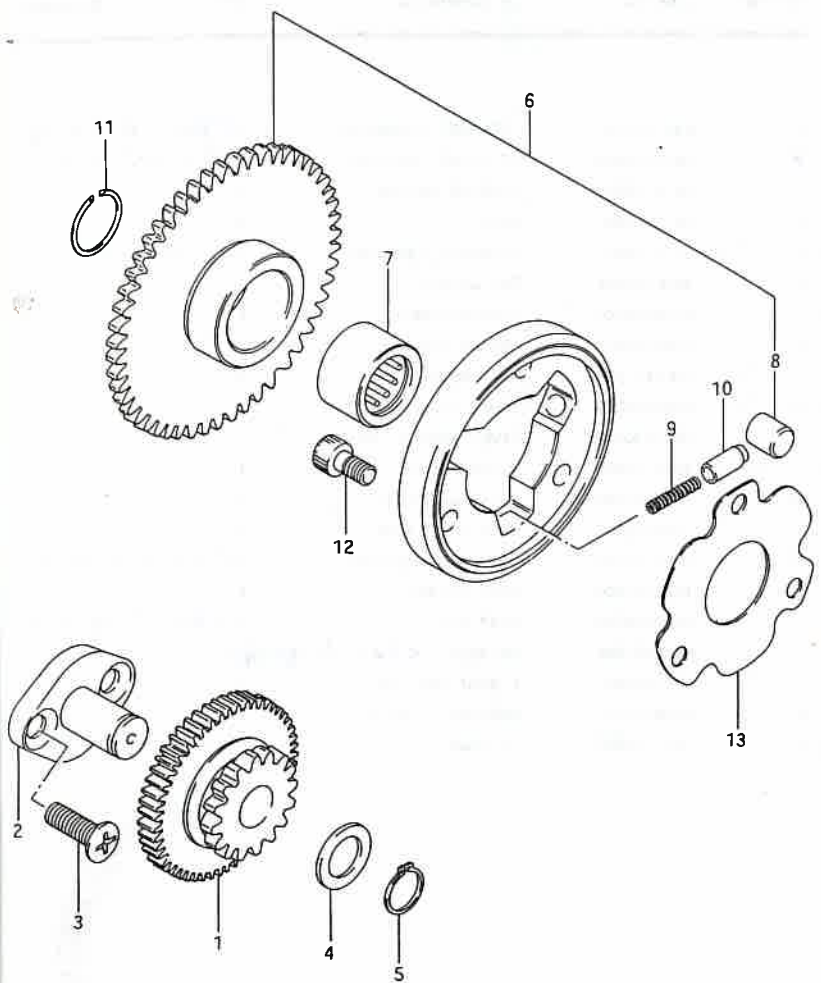

FIG. 6 (B-8) STARTER CLUTCH

REF. NO.	PART NO.	DESCRIPTIONS	Q'TY	REMARKS
1	12611-30A00	GEAR, starter idle (NT:68/14)	1	
2	(N) 12612-09410	SHAFT, starter idle gear	1	
3	02122-06163	SCREW	2	
4	09160-13010	WASHER	1	
5	08331-31136	CIRCLIP	1	
6	12600-30851	Starter Clutch Set	1	12600-30861
7	09263-25040	.BEARING	1	
8	09261-10003	.ROLLER	3	
9	09440-03004	.SPRING	3	
10	(N) 12633-05300	.PIECE, push	3	12633705300
11	09380-25010	CIRCLIP, starter clutch brg	1	
12	07130-06123	BOLT (6X10)	3	
13	(N) 12649-30D00	SHIM, clutch hub	1	

2

FX110

FIG. 7

2

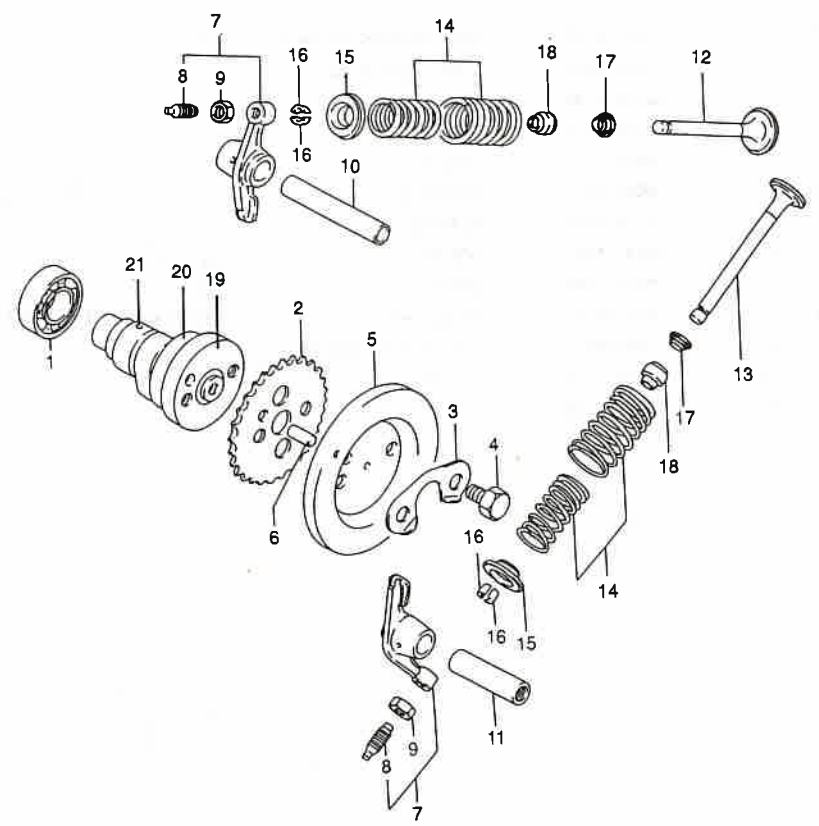

FWD

FX110

FIG. 7 (B-9) CAM SHAFT/VALVE

REF. NO.	PART NO.	DESCRIPTIONS	QTY	REMARKS
1	(N) 09262-15026	.BEARING Camshaft RH	1	09262 A150260
X	12741-30A10	SPROCKET, cam shaft	1	Discontinued
3	12747-30D00	WASHER, sprocket	1	
4	09111-06053	BOLT	2	
5	(N) 12755-30A00	FLYWHEEL, cam shaft	1	12755-09A00
6	09261-05009	PIN, sprocket	1	
7	(N) 12840-09D01	ARM, valve locker	2	
8	12842-49201	.SCREW, adjusting	2	
9	(N) 12843-27A00	.NUT, adjusting	2	
10	(N) 12861-09D00	SHAFT, locker arm IN	1	
11	(N) 12871-30A00	SHAFT, locker arm EX	1	
12	(N) 12911-30D00	VALVE, Intake & SX	1	
13	(N) 12912-30D00	VALVE, exhaust & SX	1	
14	(N) 12920-30A01	SPRING SET, valve	2	
15	(N) 12931-09A00	RETAINER, valve spring	2	12931A09A00H
16	(N) 12932-27A00	COTTER, valve	4	
17	(N) 12933-39E00	SEAT, spring	2	12933D39E00H
18	09289-05008	OIL SEAL 09289B05008H	1	
19	(N) 12713-09401	FLANGE, Camshaft	1	
20	(N) 09262-17037	BEARING, Camshaft L	1	
21	12711-30D00	Camshaft	1	12710-30D00

FIG. 8

REMARKS

50260
9024

8200

400H

9200H

0000

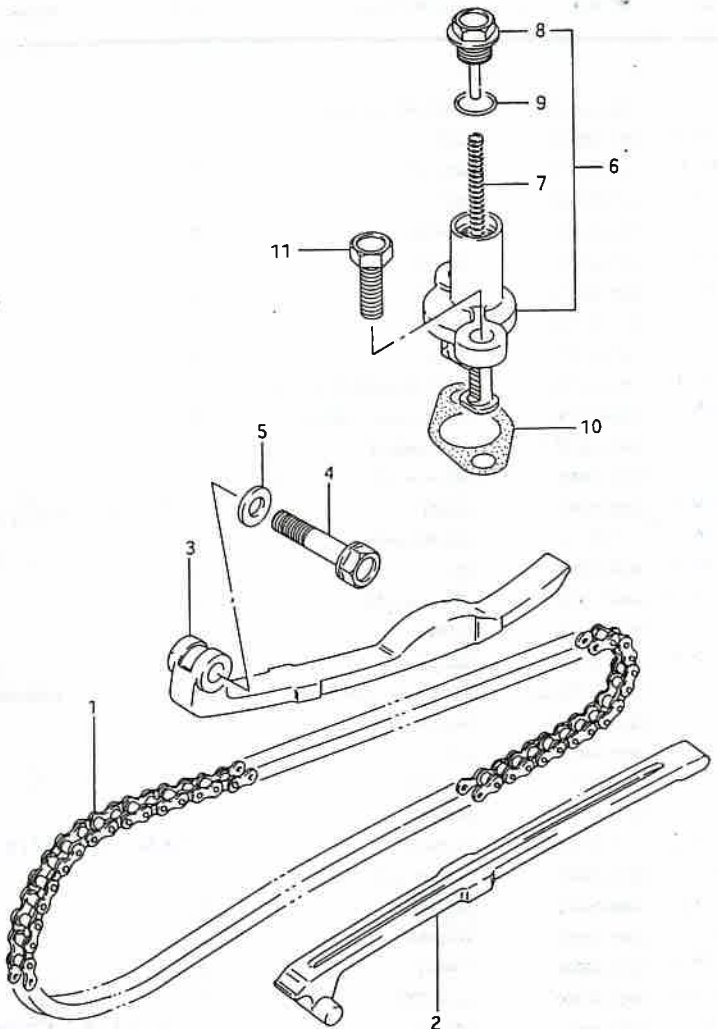

FX110

FIG. 8 (B-10) CAM CHAIN

REF. NO.	PART NO.	DESCRIPTIONS	QTY	REMAR
1	12760-30A10	CHAIN, cam shaft drive	1	
2	(N) 12771-30A04	GUIDE, cam chain 8SX/FX110X	1	
3	(N) 12811-30A02	TENSIONER, cam chain 8SX	1	
4	12812-30A00	BOLT, cam chain tensioner	1	09103-06047
5	09168-06004	GASKET	1	
6	12830-30A01	ADJUSTER ASSY, tensioner	1	
7	(N) 12833-30A01	.SPRING	1	
8	(N) 12834-02A00	.PLUG, adjuster	1	
9	(N) 12832-02A00	.O RING	1	
10	(N) 12837M19B10	GASKET, tensioner adjuster	1	12827-19B10
11	07120-06203	BOLT (6X20)	2	

2

FIG. 9

2

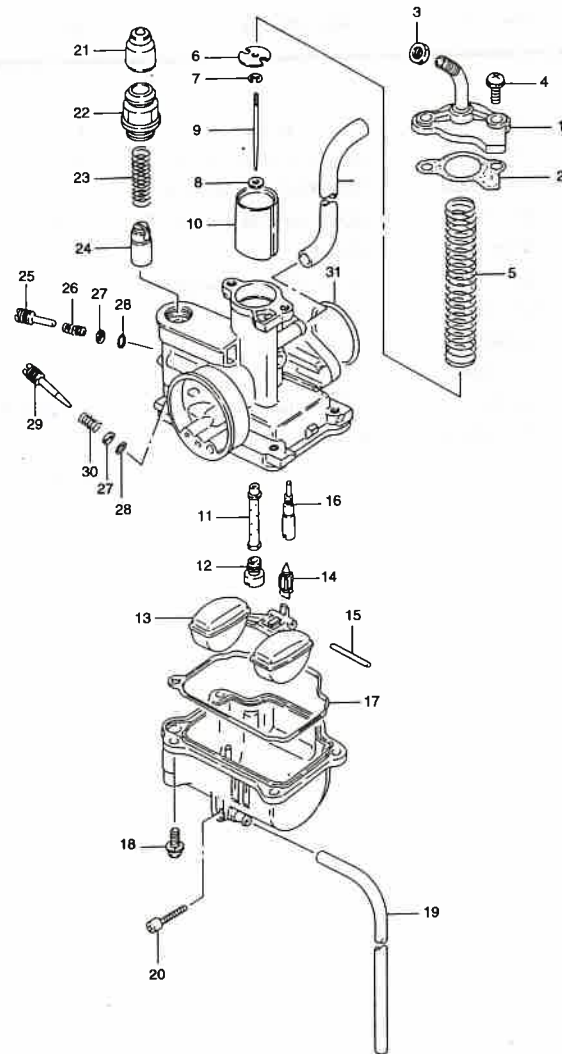

FX110

FIG. 9 (C-2) CARBURETOR

REF. NO.	PART NO.	DESCRIPTIONS	Q'TY	REMARKS
	13200-30D20	CARBURETOR ASSY	1	
1	(N) 13261-30D00	.CAP	1	
2	(N) 13249-30A10	.GASKET	1	
3	(N) 13661-02B00	.NUT	1	
4	(N) 02112-34123	.SCREW	2	
5	(N) 13573-30D00	.SPRING	1	
6	(M) 13447-30A00	.PLATE	1	
7	13394-40D00	.CLIP	1	
8	13615-09400	.PACKING	1	
9	(X) 13383-30D00	.NEEDLE, jet (3DL2-3)	1	
10	(N) 13551-30D00	.VALVE, piston (CA:2.5)	1	
11	09494-00887	.JET, needle (D-9)	1	
12	09491-85005	.JET, main (B5)	1	
13	(X) 13250-16A00	.FLOAT	1	13250-20D50
14	(X) 13370-09D00	.VALVE, needle	1	
15	(X) 13254-20010	.PIN	1	
16	(C) 09492-17012	.JET, pilot (17.5)	1	
17	13258-30A00	.O RING	1	
18	(T) 13601-04148	.SCREW	4	L:600-225
19	09354-25703-600	.HOSE (2.5x7x600)	1	
20	(N) 13247-13A00	.SCREW	1	
21	(N) 13681-04010	.CAP	1	
22	(N) 13418-43410	.HOLDER	1	
23	(N) 13417-01010	.SPRING	1	
24	(X) 13411-01010	.PLUNGER	1	13411B01010N
25	(X) 13267-09400	.SCREW, air (1 3/4)	1	
26	(X) 13494-09410	.SPRING	1	
27	(X) 13291-29900	.WASHER	2	
28	(X) 13295-29900	.O RING	2	
29	(X) 13267-47A00	.ADJUSTER	1	
30	(X) 13268-35010	.SPRING	1	13268B25010N
31	09280-24006	.O RING	1	
32	09352-40703-600	.HOSE (4x7x600)	1	L:600-400

FIG.



FX1

FIG. 10

FIG. 10 (C-3) AIR CLEANER

REMARKS

REF. NO. PART NO. DESCRIPTIONS QTY REMARK

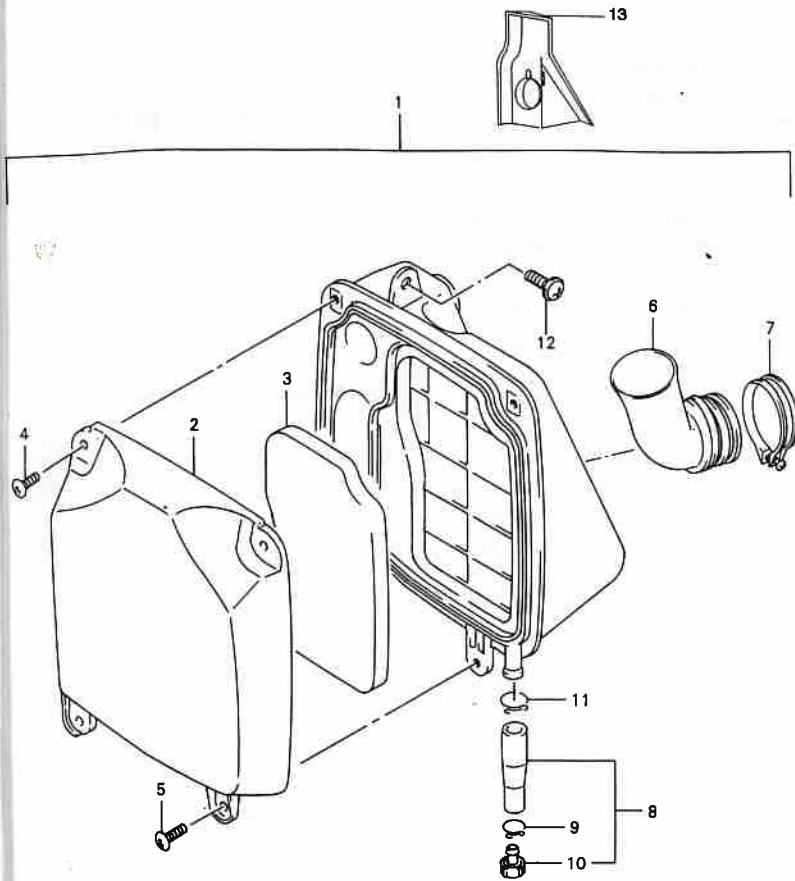

REF. NO.	PART NO.	DESCRIPTIONS	QTY	REMARK
1	13700M30D20	CLEANER ASSY, air	1	Discontinued
2	13741M30D20	.CAP	1	
3	13781M30D20	.FILTER	1	
4	02142-05123	.SCREW	2	
5	02142-05163	.SCREW	2	
6	13881-30D20	.TUBE, outlet	1	
7	09402-40306	.CLAMP	1	
8	13870-11078	.TUBE ASSY, drain	1	
9	09401-11101	.CLIP	1	
10	13877-38A00	.STOPPER	1	
11	09401-13409	.CLIP	1	
12	09136-06017	SCREW	2	
13	13892M30D20	BOOT INLET	1	

2

0050

L:600-225

1010N

35010N

L:800-400

FX110

2

FIG. 11

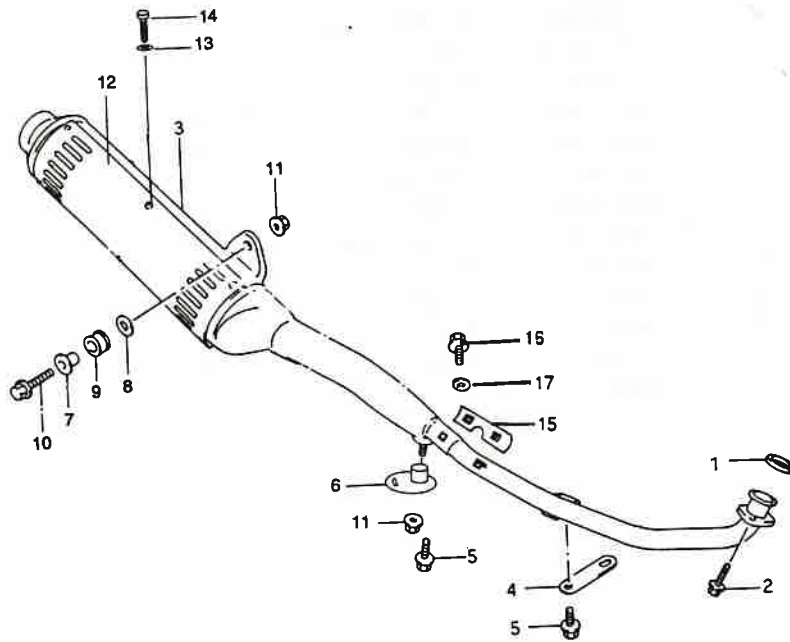

FIG. 11 (C-4) MUFFLER

REF. NO.	PART NO.	DESCRIPTIONS	Q'TY	REMARKS
1	14181M30A10	GASKET, exhaust pipe	1	
2	01570-06203	BOLT	2	
3	14305M30D00	MUFFLER ASSY	1	Discontinued
4	14411M30D00	Bracket, exh sprt	1	
5	01550-08123	BOLT	2	
6	14415M30D99A	Bracket, exh sprt rear No. 1	1	
7	14773M41D00	SPACER, muf sprt	1	
8	09160-08032	WASHER	1	
9	09320012058	CUSHION	1	
10	01550-08353	BOLT	1	
11	08319-31083	NUT	2	
12	14781M30D00A	COVER MUFFLER 14781M30D00B	1	
13	08321M01063	WASHER	6	
14	02142M06087	BOLT	6	
15	14186M30D10	COVER, exhaust pipe	1	
16	02112M06087	SCREW, exh. pipe cover	2	
17	08321M01063	WASHER, exh. pipe cover	2	

FX110

FWD

REMARKS

FIG. 12

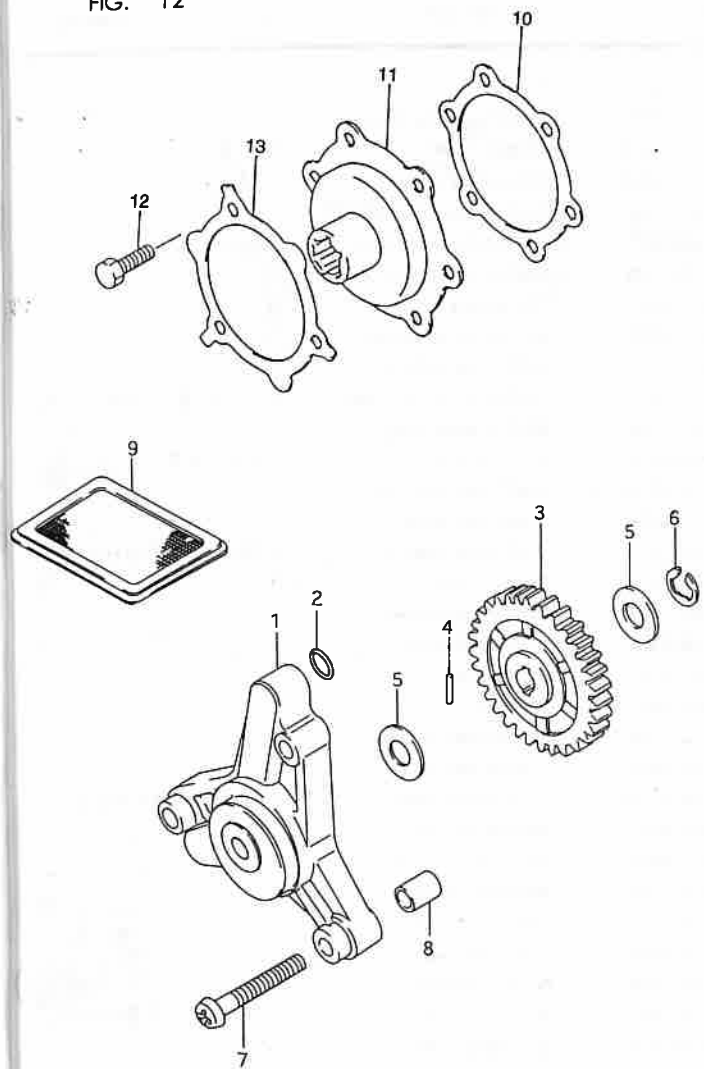

FX110

FIG. 12 (C-5) OIL PUMP

REF. NO.	PART NO.	DESCRIPTIONS	QTY	REMARK
1	16400-09410	PUMP ASSY, engine oil	1	
2	09280-10015	O RING	2	
3	(N) 16331-09420	GEAR, oil pump driven (NT:31)	1	
4	09281-02008	ROLLER	1	
5	08211-08141	WASHER	2	
6	08332-11063	E RING	1	
7	02112-06353	SCREW	3	
8	04211-09129	PIN	2	
9	(N) 16520-30A00	STRAINER, engine oil	1	
10	(N) 16543-30D00	GASKET	1	
11	(N) 16540-30D00	COVER, engine oil filter	1	
12	09100-05019	BOLT	3	
13	(N) 16544-30D00	WASHER, oil filter cover	1	

2

FIG. 13

2

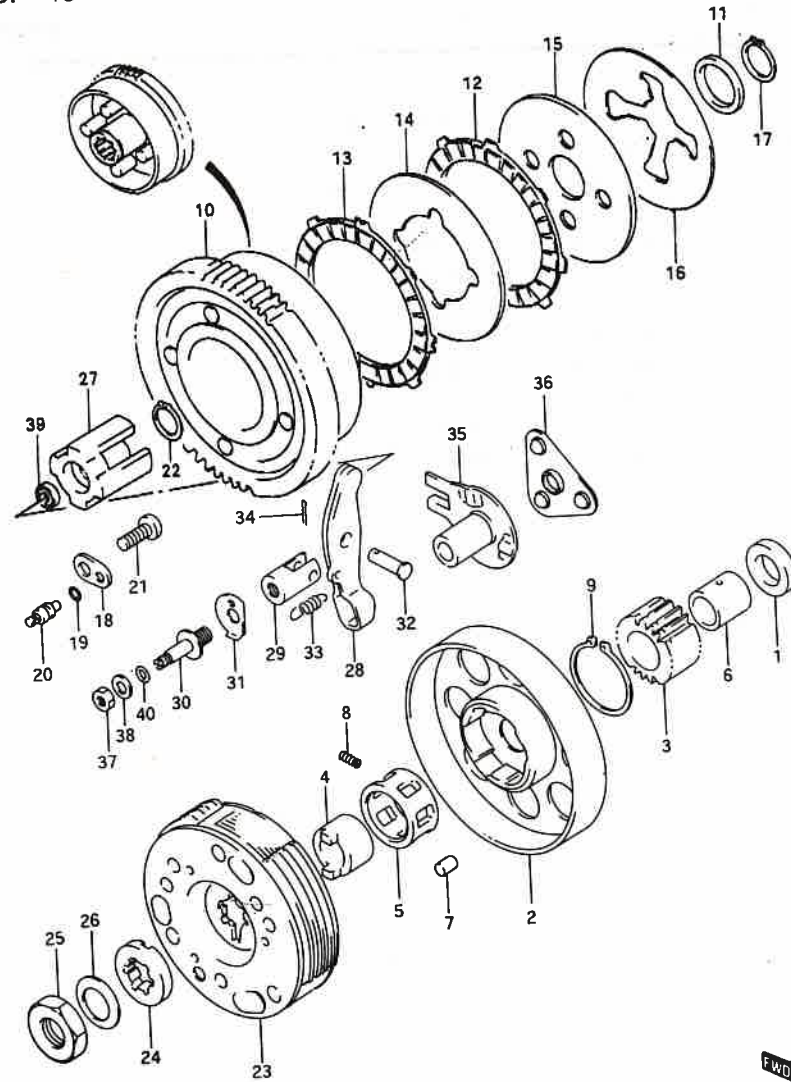

FX110

FIG. 13 (C-6) CLUTCH

REF. NO.	PART NO.	DESCRIPTIONS	Q'TY	REMARKS
1	16325-30D00	SPACER, oil pump drive gear	1	
2	21102-30A10	HOUSING, clutch	1	Auto clutch
3	(N) 21111-09D00	GEAR, primary drive	1	
4	(N) 21631-02A04	RACE, one way clutch INR	1	
5	(N) 21652-30D01	RETAINER, one way clutch	1	GSX/RG
6	09180-16045	SPACER, primary drive gear	1	
7	09261-07006	ROLLER, one way clutch	3	
8	09440-02003	SPRING, one way clutch	1	
9	08331-31346	CIRCLIP, primary drive	1	
10	21200-30D01	GEAR ASSY, primary driven	1	12/1000-30D01
11	21412-30D00	SPACER, clutch spring	1	
12	(N) 21441-21D20	PLATE, clutch drive	1	4/14/20-21D20
13	(N) 21442-21D20	PLATE, clutch driven No.2	1	
14	(N) 21451-30D00	PLATE, clutch driven	1	Discontinued
14	(X) 21461-30D00	PLATE, clutch pressure	1	
16	(N) 21481-21D20	SPRING, clutch	1	
17	08331-31216	CIRCLIP, clutch spring	1	
18	(N) 21499-30D00	RETAINER, clutch oil	1	
19	09280-40004	O RING, clutch oil	1	
20	09493-26007	JET, clutch oil	1	
21	02112-06163	SCREW, clutch oil	1	
22	09380-17010	CIRCLIP, gear shift clutch	1	
23	21501-30D00	CLUTCH ASSY, shoe	1	12/501-30D01
24	(N) 21541-30D00	SPACER, clutch assy shoe	1	
25	09140-16025	NUT, clutch assy shoe	1	
26	09164-16004	WASHER, clutch assy	1	
27	(N) 23121-21D10	PIECE, clutch push	1	
28	(N) 23221-09D01	ARM, clutch release	1	
29	(N) 23222-09D01	BOSS, clutch release	1	
30	(N) 23223-09D00	BOLT, clutch release	1	23223-09D03
31	09169-08046	WASHER, CL release bolt	1	
32	09200-07005	PIN, clutch release arm	1	
33	09443-06053	SPRING, clutch release	1	
34	04111-16208	PIN, clutch release	1	
35	(N) 23230-30D01	GUIDE, release ball outer	1	

FIG. 13

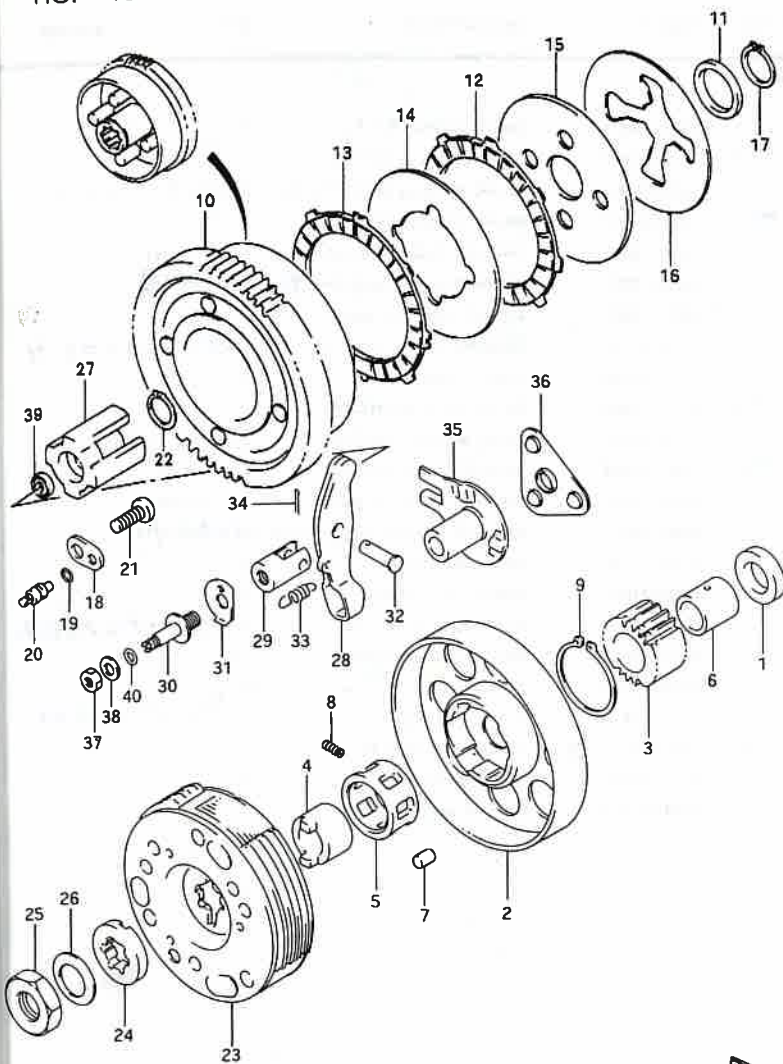

FX110

FIG. 13 (C-7) CLUTCH

REF. NO.	PART NO.	DESCRIPTIONS	Q'TY	REMARKS
36	23250-35402	BALL, clutch release	1	
37	09140-08019	NUT, clutch release	1	
38	09160-08092	WASHER, clutch release	1	
39	09266-16002	BEARING, PUSH, piece thrust	1	
40	09280-08012	O RING, release bolt	1	

REMARKS

30D02

11A20

00ed

0A01

09D03

2

2

FIG. 14

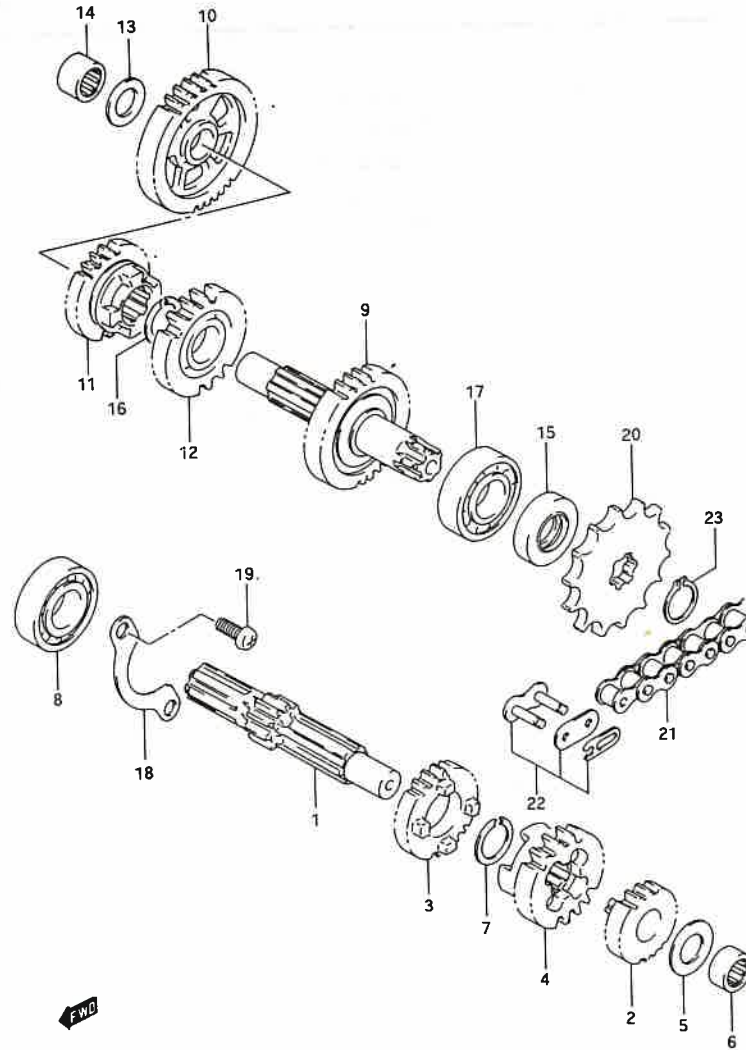

FX110

FIG. 14 (C-8) TRANSMISSION

REF. NO.	PART NO.	DESCRIPTIONS	QTY	REMARK
1	24121-35511	SHAFT, counter <i>65X/AC</i>	1	
2	24221-35422	GEAR, 2ND drive (NT:18)	1	
3	24231-30A10	GEAR, 3RD drive (NT:19) <i>65X/FPX</i>	1	<i>JK031-30A30</i>
4	24241-30A10	GEAR, 4TH drive (NT:19)	1	
5	09160-13006	WASHER, 2ND drive thrust	1	13x24x1
6	09263-13001	BEARING, counter shaft LH <i>09263-13001</i>	1	13x19x12
7	09380-17007	CIRCLIP, 3RD drive gear	1	
8	08110-62030	BEARING, counter shaft RH	1	<i>08110D62030H</i>
9	24130-30A20	SHAFT, drive <i>65X</i>	1	
10	24310-30A10	GEAR, 1ST driven (NT:33)	1	
11	24331-30A10	GEAR, 3RD driven (NT:26)	1	<i>JK331-30A30</i>
12	24341-35420	GEAR, 4TH driven (NT:20)	1	
13	09160-13006	WASHER, 1ST driven gear	1	13x24x1
14	09263-13001	BEARING, drive shaft RH <i>09263-13001</i>	1	13x19x12
15	09283-17025	SEAL, drive shaft oil	1	
16	09380-17007	CIRCLIP, 4TH driven gear	1	
17	08110-62030	BEARING, drive shaft LH	1	<i>08110D62030H</i>
18	24741-09401	RETAINER, counter shaft	1	
19	02112-06103	SCREW	2	
20	27511-26400	SPROCKET, engine (NT:14)	1	<i>07511M26400</i>
21	27600M20910-098	CHAIN ASSY, drive 98L	1	
22	27620-20910	.JOINT, drive	1	
23	08331-31166	CIRCLIP, engine sprocket	1	

FIG. 15

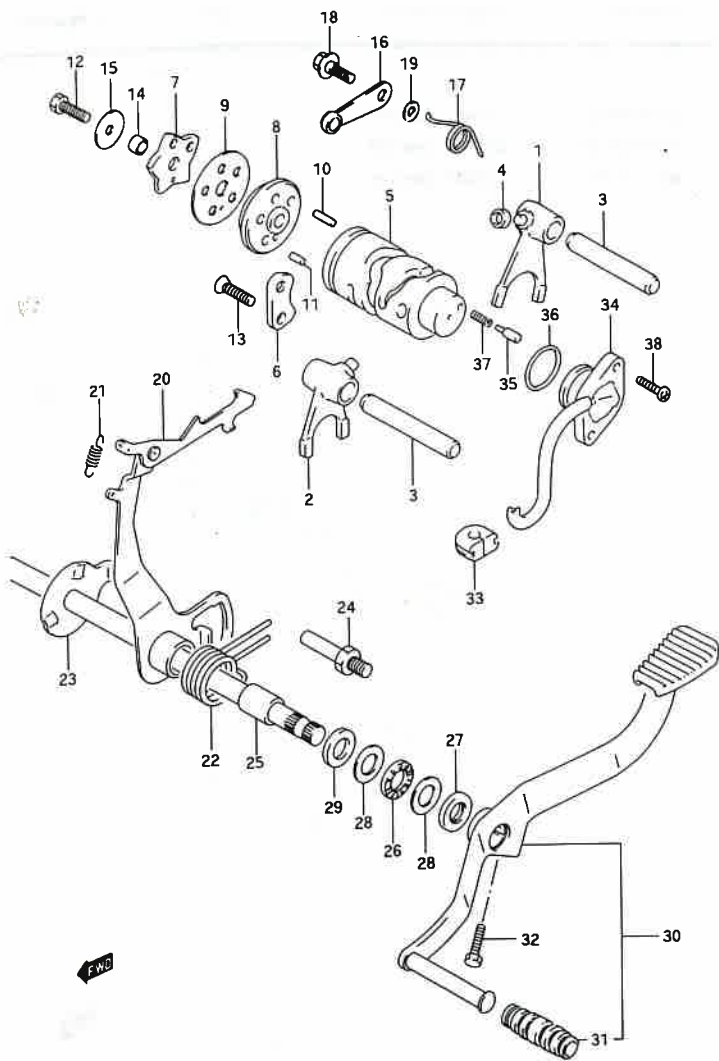

FIG. 15 (C-9) GEAR SHIFTING

REF. NO.	PART NO.	DESCRIPTIONS	QTY	REMARK
1	(N) 25210-30A10	FORK, gear shift No.1	1	
2	(N) 25220-30A10	FORK, gear shift No.2	1	
3	25421-35403	SHAFT, shift fork	2	
4	09180-06086	SPACER, shift fork No.1	1	
5	(N) 25310-30A40	CAM, gear shift	1	
6	(N) 25341-09400	RETAINER, shift cam	1	
7	(N) 25381-30A20	PLATE, shift cam stopper	1	
8	(N) 25382-30A30	PLATE, shift cam No.2	1	
9	(N) 25382M35411	GUIDE, GR SHF cam	1	2538J-35411
10	09261-04002	PIN, shift cam	2	
11	09261-04012	PIN, shift cam	2	
12	01500-06303	BOLT, shift cam pin	1	
13	02122-06163	SCREW, shift cam retainer	2	
14	04211-09109	PIN, stopper plate	1	
15	08211-08221	STOPPER, shift cam pin	1	
16	(N) 25350-09D00	STOPPER, shift cam	1	
17	(N) 25355-09400	SPRING, shift cam	1	
18	09111-06041	BOLT, shift cam	1	
19	08211-06121	WASHER, shift cam	1	
20	(N) 25520-09D03	ARM, gear shift	1	25520-09D00
21	09443-05019	SPRING, shift PAWL	1	
22	09444-25002	SPRING, shift arm return	1	
23	(N) 25510-30D00	SHAFT, gear shift	1	
24	(N) 25671-31C00	STOPPER, shift arm	1	
25	09180-12036	SPACER, shift arm	1	
26	09263-12019	BEARING, gear shift arm	1	
27	09285-12002	SEAL, shift shaft oil	1	
28	08211-12261	WASHER, shift shaft	1	
29	08211-20264	WASHER, shift shaft	1	
30	(N) 25610M30D00	LEVER ASSY, gear shift	1	GSX/FR110
31	(N) 25652M16500	.RUBBER, gear pedal	1	
32	09100M06091	BOLT, shift lever	1	
33	(N) 31482-47000	GROMMET, position SW	1	
34	37720-30D00	BASE ASSY, gear shift	1	FDXC/FR
35	09209-05011	CONTACT, gear position	1	09209B05011N000

REMARK

A30

030H

A30

2030H

16450

FX110

2

FIG. 15

2

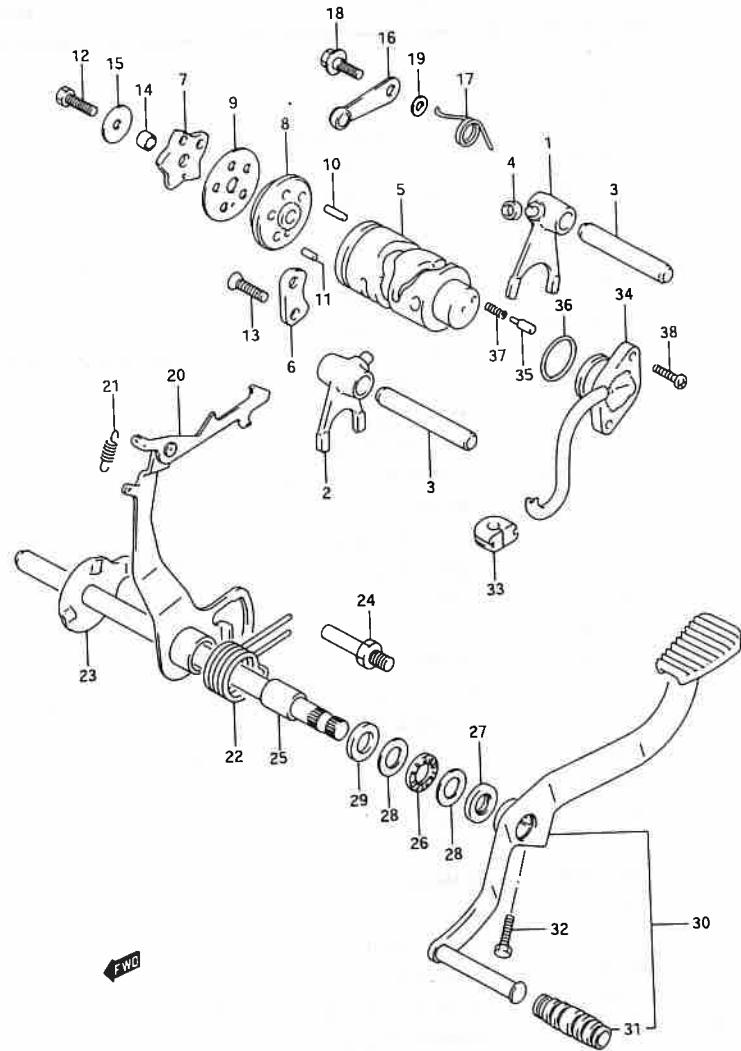

FX110

FIG. 15 (C-10) GEAR SHIFTING

REF. NO.	PART NO.	DESCRIPTIONS	Q'TY	REMARK
36	09280-21008	O RING, gear shift	1	
37	09440-04010	SPRING, gear shift	1	
38	02112-05163	SCREW, gear shift	2	

FIG. 16

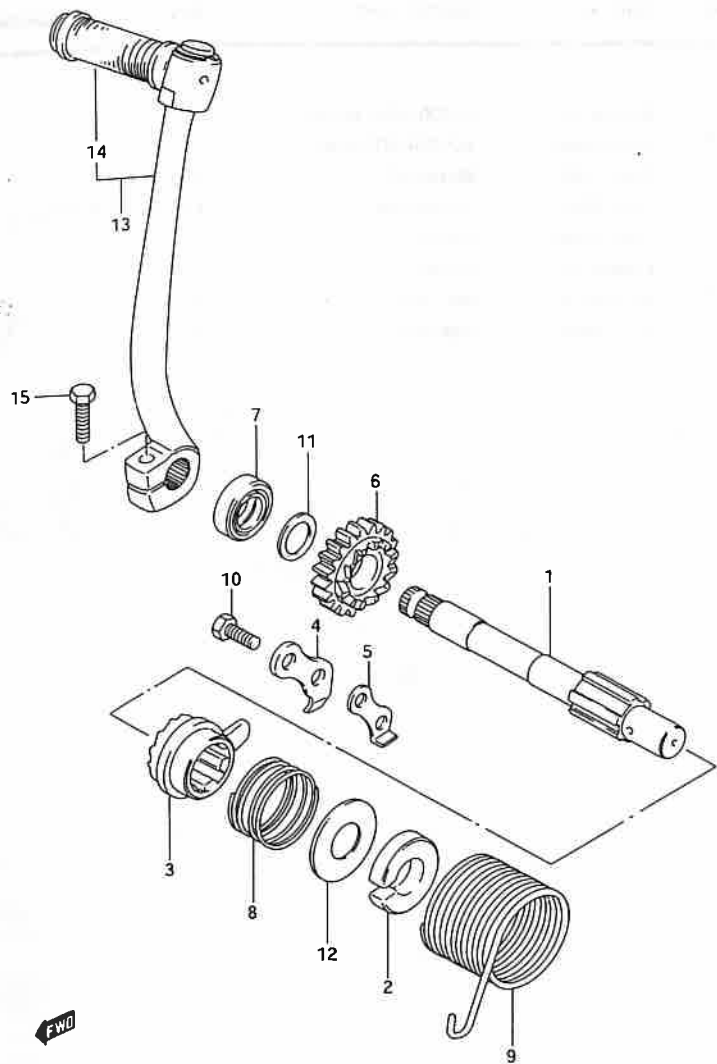

FIG. 16 (C-11) KICK STARTER

REF. NO.	PART NO.	DESCRIPTIONS	Q'TY	REMARK
1	(N) 26211-09410	SHAFT, kick starter	1	
2	(N) 26221M30A00	GUIDE, kick starter SPR	1	
3	26231-09401	STARTER, kick	1	
4	(N) 26232-09401	GUIDE, kick starter	1	
5	(N) 26233-09400	STOPPER, kick starter	1	
6	(N) 26241-09410	GEAR, kick starter drive	1	
7	09285-14001	SEAL, kick starter	1	
8	09440-30007	SPRING, kick starter	1	
9	09448-38004	SPRING, kick shaft return	1	
10	01500-06123	BOLT, kick starter stopper	2	
11	08211-14221	WASHER, kick drive gear	1	
12	08211-14321	PLATE, kick starter SPR	1	
13	26300M30A21	LEVER ASSY, kick starter	1	
14	(N) 26352M01000	RUBBER, kick pedal	1	
15	01107M06235	BOLT, kick pedal	1	

2

Discontin

FWD

FX110

FIG. 17

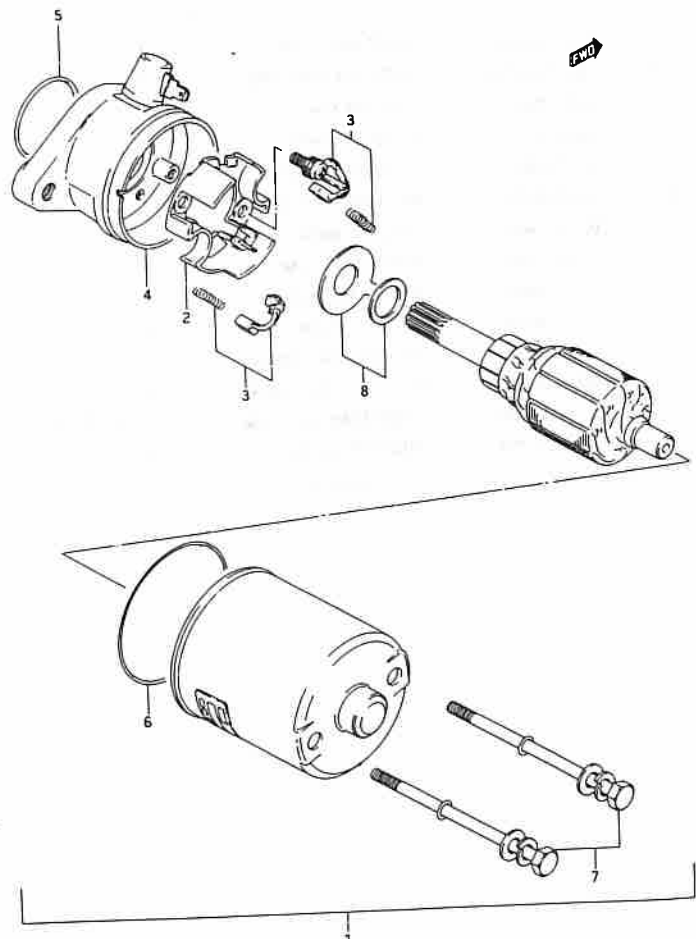

3

FIG. 17 (D-2) STARTER MOTOR

REF. NO.	PART NO.	DESCRIPTIONS	QTY	REMARK
1	31100-30D00	MOTOR ASSY, starting	1	
2	(X) 31130-35400	.HOLDER SET, brush	1	
3	(X) 31131-35400	.BRUSH SET	1	
4	31151-30D00	.HOUSING SET	1	31151-30D01
5	09280-25004	.O RING	1	
6	(N) 31158-35400	.O RING	1	
7	(N) 31280-31C00	.BOLT SET	1	
8	(X) 31170-43400	.SHIM SET	1	

FX110

FIG. 18

FIG. 18 (D-3) MAGNETO

REMARK

REF. NO.	PART NO.	DESCRIPTIONS	QTY	REMARK
1	32101-30D00	STATOR ASSY	1	
2	32102-30D00	ROTOR ϕ 5X	1	
3 (✓)	32371-30D00	CLAMP, MAGNETO LEAD	1	
4	02112-05103	SCREW, sensor	2	
5	02112-06203	SCREW, mangneto stator	2	
6	02142-06103	SCREW, magneto lead clamp	1	
7	08316-10123	NUT, magneto rotor	1	
8	08341-31039	KEY, magneto rotor	1	

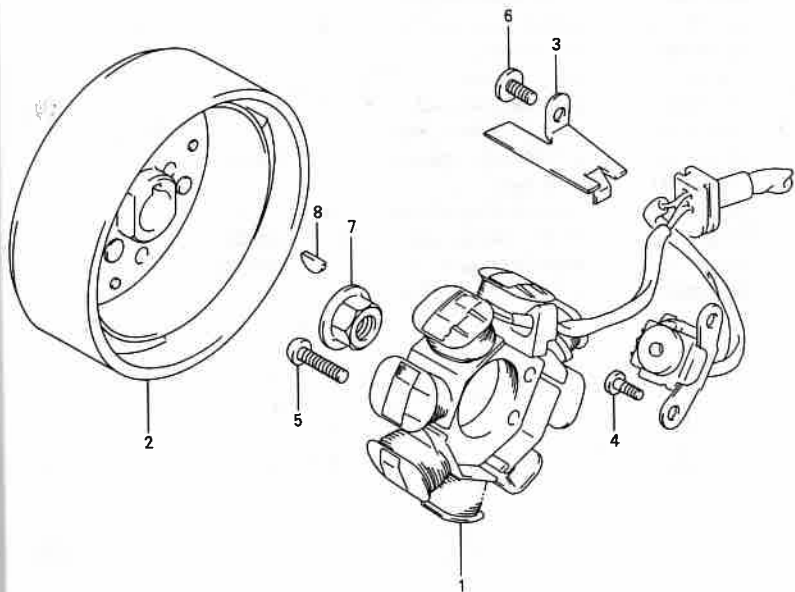

201

3

FX110

FIG. 19

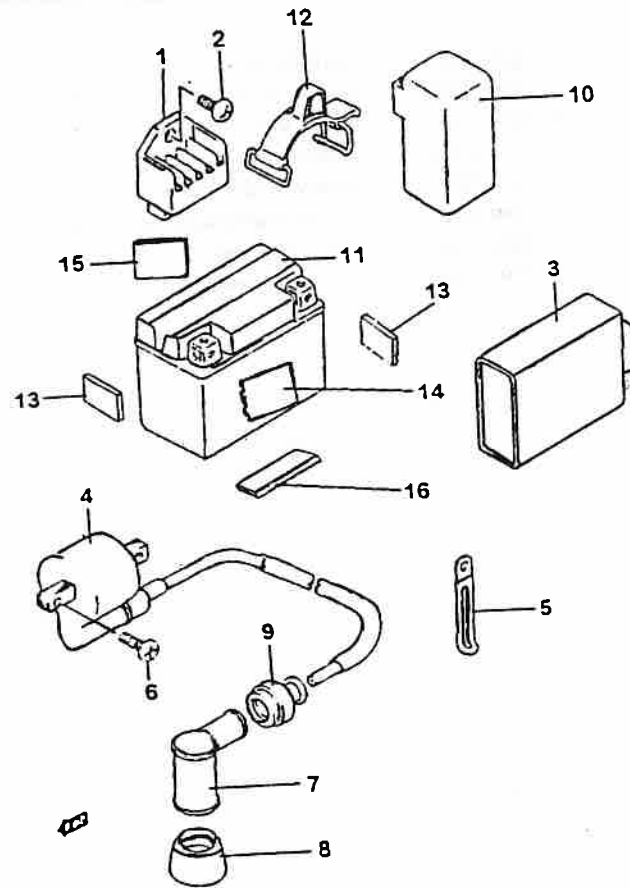

FIG. 19A (D-4) ELECTRICAL (FOR MODEL FX110 KS)

REF. NO.	PART NO.	DESCRIPTION	Q'TY	REMARKS
1	32800-43E00	RECTIFIER ASSY	1	
2	02112-06123	SCREW	1	
3	32900-30D00	CDI UNIT	1	32900 M30A80
4	33410-30D00	COIL ASSY, ignition	1	
5	09404-06429	CLAMP, high tension cord	1	
6	02112-06163	SCREW, ignition coil	2	
7	33510-22010	CAP, spark plug	1	
8	33541-24510	SEAL, spark plug	1	
9	33542-38B00	SEAL, high tension cord	1	3,800-19D01
10	31800-19D00	RELAY ASSY, starting motor	1	
11	33610M31C00	BATTERY ASSY (12V, 3AH)	1	YB3LB (KICK START)
12	33651M31C01	BAND, Battery	1	
13	33652M31C10	PROTECTOR, battery side	2	
14	33652M31C00A	PROTECTOR, battery B	1	(30X40X10)
15	33652M41D00	PROTECTOR, battery A	1	(25X40X2)
16	33652M30D00A	CUSHION, battery bottom	1	

FIG. 19

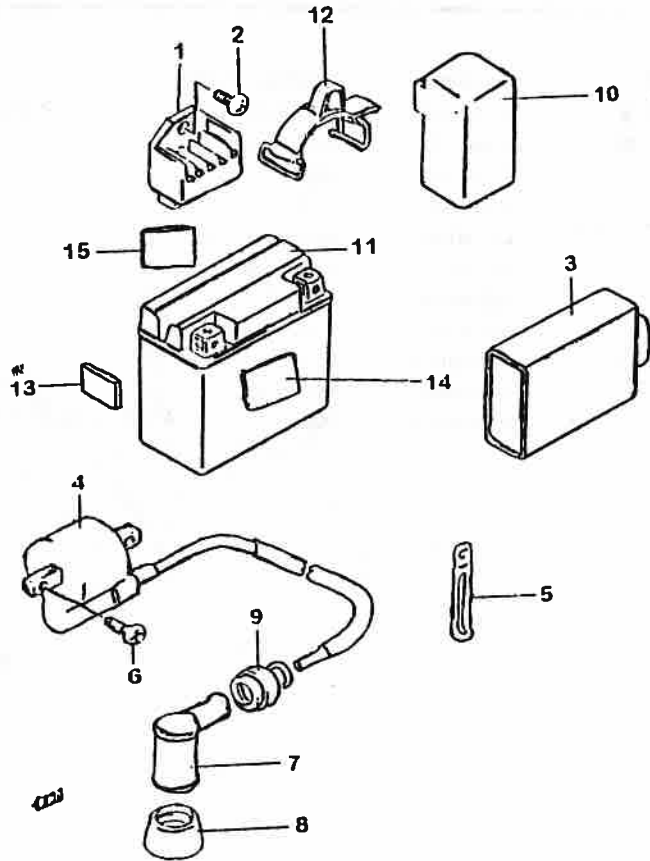

FIG. 19B (D-4) ELECTRICAL (FOR MODEL FX110 MS)

REF. NO.	PART NO.	DESCRIPTION	QTY	REMARKS
1	32800-43E00	RECTIFIER ASSY	1	
2	02112-06123	SCREW	1	
3	32900-30D00	CDI UNIT	1	32900-30D80
4	33410-30D00	COIL ASSY, ignition ϕ 8x / ϕ c	1	
5	09404-06429	CLAMP, high tension cord	1	
6	02112-06163	SCREW, ignition coil	2	
7	(N) 33510-22010	CAP, spark plug	1	
8	(N) 33541-24510	SEAL, spark plug	1	
9	(N) 33542-38B00	SEAL, high tension cord	1	
10	(N) 31800-19D00	RELAY ASSY, starting motor	1	31800-19D01
11	33610M35400	BATTERY ASSY (12V5AH3-WET)	1	YB5AH (ELECTRIC START)
12	33651M31C01	BAND, Battery	1	
13	33652M31C10	PROTECTOR, battery side	1	
14	33652M31C00A	PROTECTOR, battery B	1	(30X40X10)
15	33652M41D00	PROTECTOR, battery A	1	(25X40X2)

3

FIG. 20

3

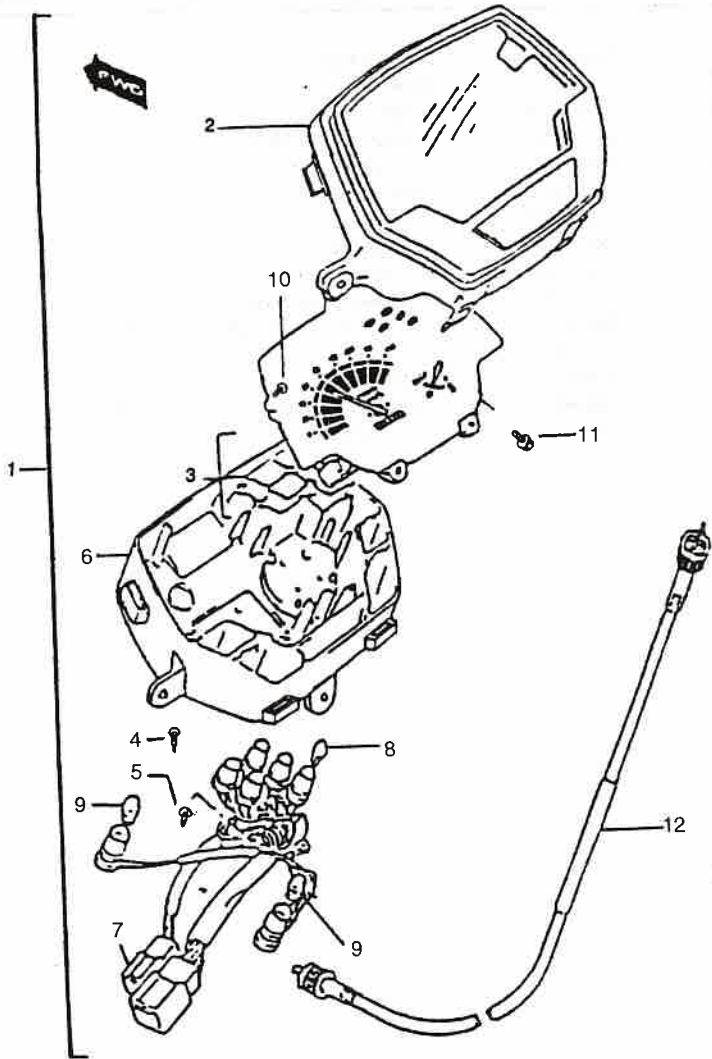

FIG. 20 (D-10) SPEEDOMETER

REF. NO.	PART NO.	DESCRIPTIONS	QTY	REMARKS
1	34100M30D20A	SPEEDOMETER ASSY	1	
X	34112M30D20	.CASE, meter upper	1	Discontinued
X	35300M31831	.LENS SET, pilot	1	X
4	02112-73103	.SCREW	1	
5	341B2M12B00	.SCREW	1	
6	(N) 34111M31C00	.CASE, meter lower	1	
7	34170M31C00	.SOCKET, meter	1	X
8	09471M2100	.BULB (12V, 1.7W)	5	
9	09471M2077	.BULB (12V, 1.7W)		
10	34148M31C00	.SCREW, dial plate		
11	03541-04163	.SCREW, spacer		
12	(N) 34910M31C00 A	CABLE A		34910M31C00A000

FIG. 21

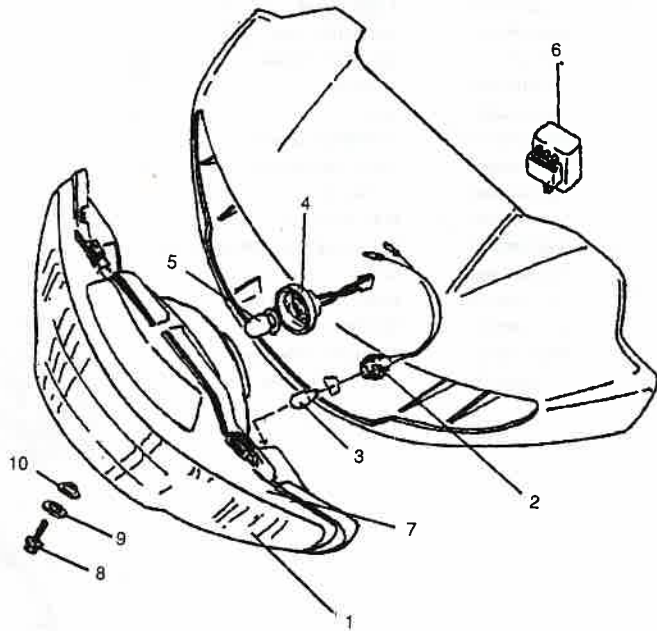

FIG. 21 (D-6) FRONT TURN SIGNAL LAMP/HEADLAMP

REF. NO.	PART NO.	DESCRIPTION	Q'TY	REMARKS
X	35120R31C99A	UNIT COMP, headlamp/turnsignal	1	DISCONTINUED
2 (X)	35618R30D10	SOCKET COMP, front turnsignal	2	
3	09471R30D10	BULB , front turnsignal lamp (orange)	2	
4 (X)	35171R30D10	SOCKET COMP, head lamp	1	
5	09471-12013	BULB, headlamp (12V, 25/25W)	1	
	38610-09410	RELAY ASSY, turnsignal/buzzer	1	38610-83549-14000
7 (X)	35120M30D95A	CUSHION, headlamp	1	
8	01104R04206	SCREW, headlamp adjust (M4X20)	1	
9	35120M30D97A	WASHER, h/l adj.	1	
10	08322R21047	SPACER, headlamp adjust	1	

3

FIG. 22

3

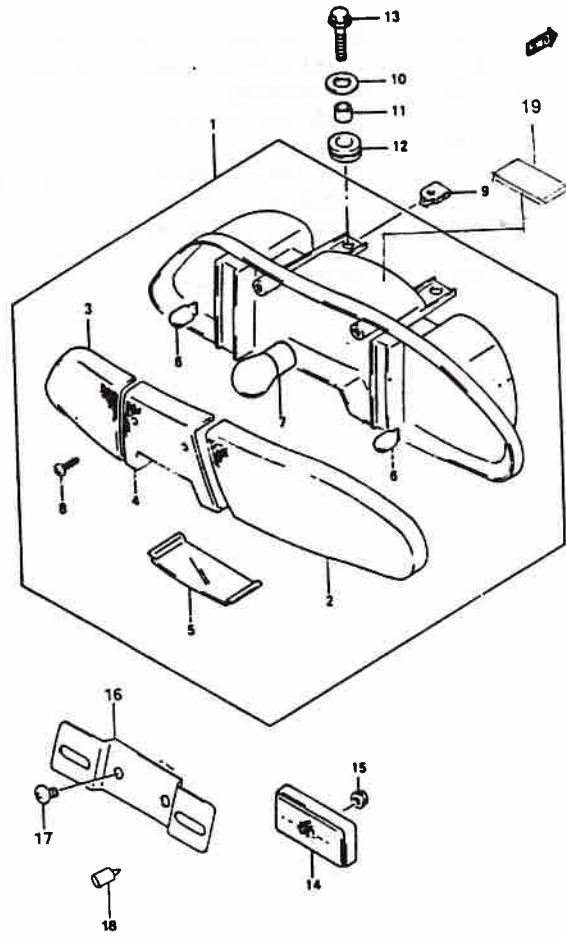

FIG. 22 (D-7) REAR COMBINATION LAMP

REF. NO.	PART NO.	DESCRIPTION	QTY	REMARKS
1	35710M47E10	LAMP ASSY, rear comb	1	
2	(N) 35652M47E10	.LENS, turn RH	1	
3	(N) 35672M47E10	.LENS, turn LH	1	
4	(N) 35712M47E10	.LENS, tail & stop	1	
5	(N) 35912M47E10	.LENS, licence	1	
6	09471M12114	.BULB (12V, 10W)	2	
7	09471M12119	.BULB (12V, 18/5W)	1	
8	03511M04163	.SCREW	2	
9	09148-05004	NUT	2	
10	09160M30D99A	WASHER (6.5x16x1)	2	
11	09160M06248	SPACER (6.1x8x9.5)	2	
12	09320M08048	CUSHION	2	
13	01550M06163	BOLT, rear lamp	2	
14	(N) 35970M05F00	REFLEX REFLECTOR ASSY, RR	1	
15	08316M10053	NUT	1	
16	(N) 35927M36510	BRACKET, licence plate	1	
17	02142-06103	SCREW	2	
18	09321-06013	CUSHION, licence plate	1	
19	35711M30D99A	CUSHION, rr comb. lamp	1	

FIG. 23

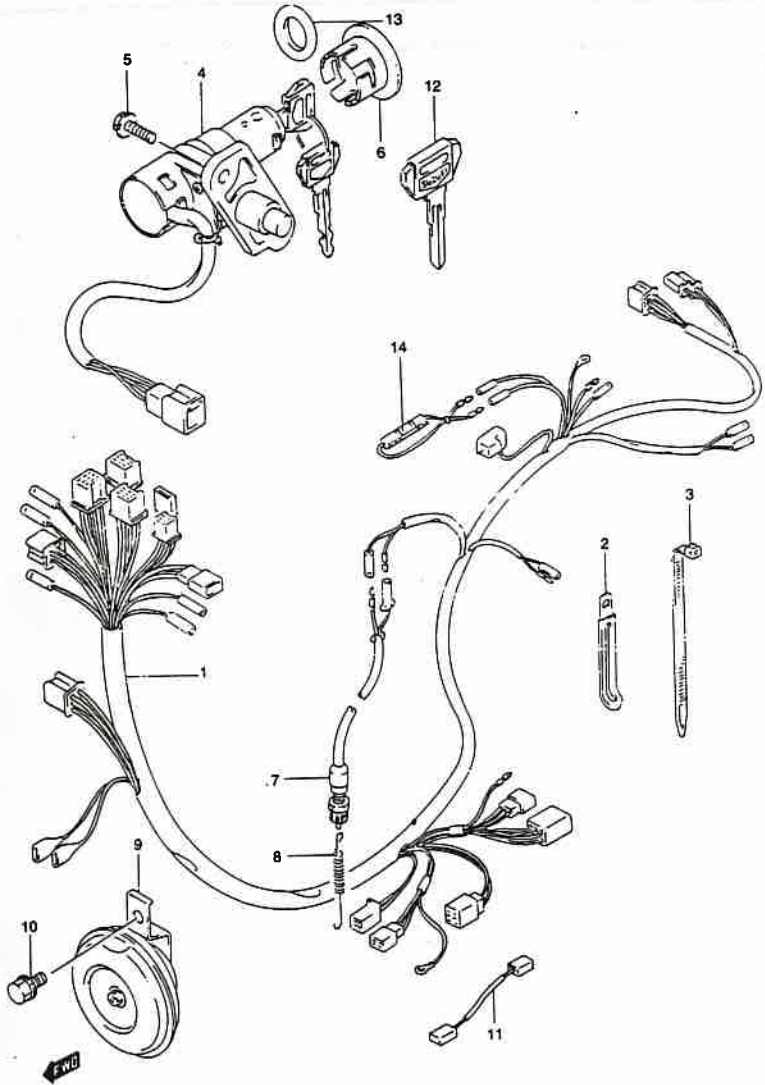

FIG. 23 (D-8) WIRING HARNESS

REF. NO.	PART NO.	DESCRIPTIONS	Q'TY	REMARKS
X (X)	36610M30D90A	HARNESS WIRING	1	36610M30D90A
2	09404-06429	CLAMP (L:60)	2	
3	09407-25401	CLAMP (L:235)	5	
4	37100-30D20	SWITCH ASSY, ignition	1	37100-30D01
5	01550-06163	SCREW	2	
6 (X)	37155M31C00	CAP, steering lock	1	
7	37740-48071	SWTICH ASSY, stop lamp	1	
8	09443-06083	SPRING	1	
9 (X)	38500-31C01	HORN ASSY	1	
10	01570-08163	BOLT, hom	1	
X (X)	33810M30D00B	WIRE, starter motor	1	Discontinued
12-1	37146-03A00	KEY, blank	1	OPT, TYPE
12-2	37146-03A10	KEY, blank	1	OPT, TYPE
12-3	37146-03A20	KEY, blank	1	OPT, TYPE
12-4	37146-03A30	KEY, blank	1	OPT, TYPE
13	37155M31C99A	SPACER	1	
14	09481M10001	FUSE (10A)	1	

3

FIG. 24

FIG. 24 (D-2) FRAME

REF. NO.	PART NO.	DESCRIPTION	Q'TY	REMARKS
X 1	41100M30D10	FRAME (Black)		Discontinued

4

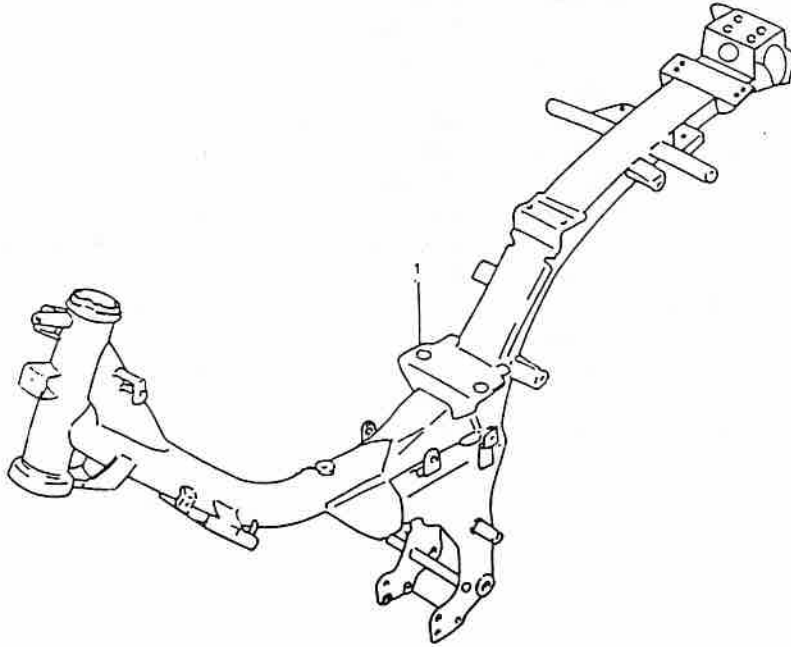

FXC

FIG. 25

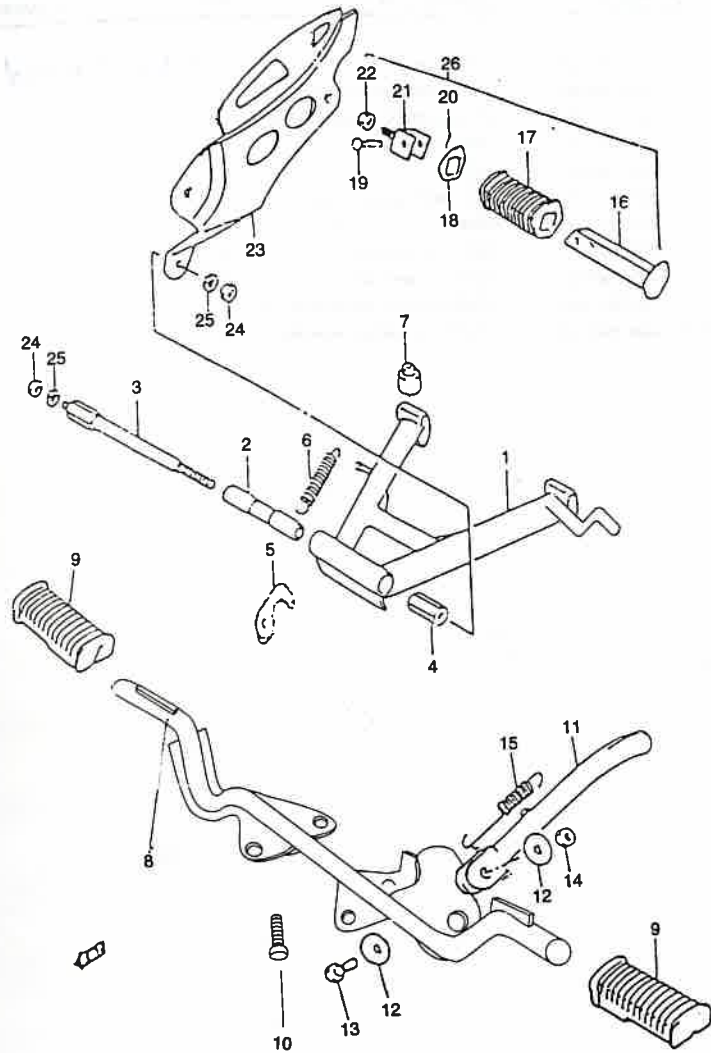

FIG. 25 STAND-FOOTREST

REF. NO.	PART NO.	DESCRIPTIONS	Q'TY	REMARKS
1	42100M35400A	STAND, center	1	42100-35400-019
2	42211M03001	SPACER, center stand	1	42211-03001
3	42221-31C10	BOLT, center stand	1	42221-31C11
4	42231-09000	NUT, center stand	1	
5	42251M03003	HOOK, center stand spring	1	
6	09443-16007	SPRING, center stand	1	
7	09321M10001	CUSHION, center stand	1	
8	43510M30D00B	BAR COMP, front footrest	1	43510M30D00B019
9	43551M39110	RUBBER, front footrest	2	
10	01550-08163	BOLT, front footrest bar	4	
X (N)	42310M30DA0B	STAND, comp-prop	1	Discontinued
12	09160M10048	WASHER	2	
13	09100M10007	BOLT, prop. stand	1	
14	09140-10043	NUT, prop. stand	1	
15	09443-14022	SPRING, prop. stand	1	
X	43610M39310	BAR, pillion footrest RH	1	Discontinued
X	43620M39310	BAR, pillion footrest LH	1	Discontinued
X	43612M30D00B	RUBBER, pillion footrest	2	Discontinued
X	43631M39310	WASHER, pillion footrest	2	Discontinued
19	09200M06033	PIN, pillion footrest	2	
20	04111-20158	PIN, cotter	2	
21	4362031C99A	HOLDER COMP, pillion footrest	2	
22	09140-10043	NUT, pillion footrest	2	
X (N)	43660M30D00D	PLATE COMP, pillion footrest RH	1	43660M30D00D019
X (N)	43760M31D20D	PLATE COMP, pillion footrest LH	1	43760M31D20D019
24	09140M10043	NUT, pillion footrest, LWR	2	
25	08321-01103	WASHER, pillion footrest, LWR	2	
26-1	43600M39310	FOOTREST ASSY, pillion RH	1	43600M39310
26-2	43700M39310	FOOTREST ASSY, pillion LH	1	43700M39310

4

FIG. 26

4

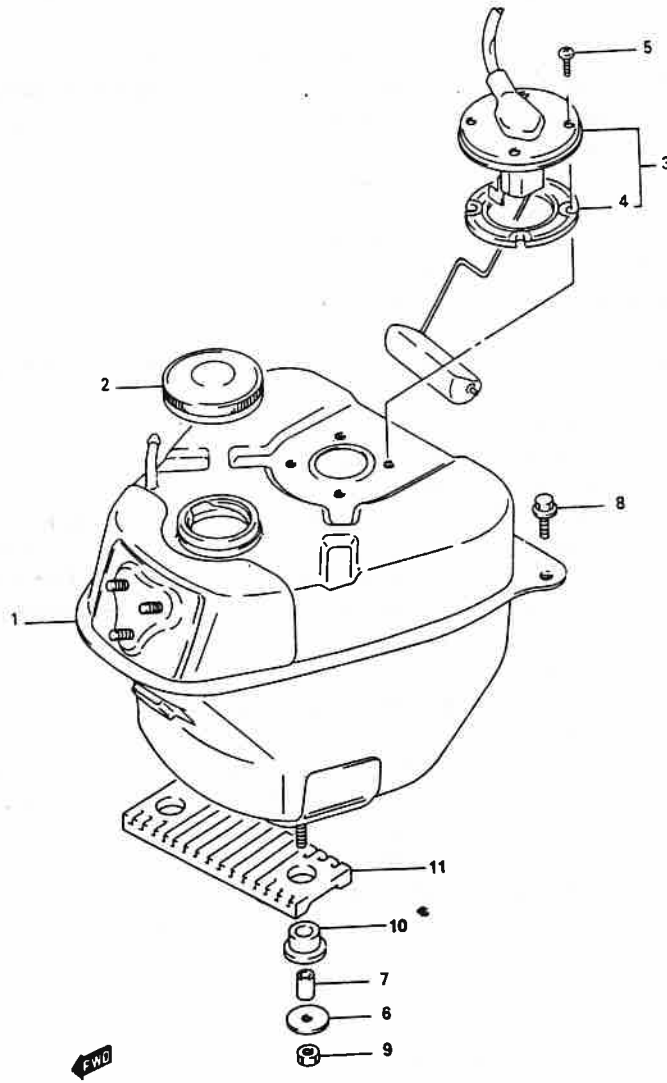

FX110

FIG. 26 (E-4) FUEL TANK

REF. NO.	PART NO.	DESCRIPTION	Q'TY	REMARKS
X	44110M31C00	TANK, fuel	1	Discontinued
2	44210-24D10	CAP COMP, fuel tank filler	1	
3	34810-31C00	GUAGE ASSY, fuel level sender	1	
4	34825-02100	GASKET	1	
5	02112-35123	SCREW	4	
6	09160-06114	WASHER, fuel tank lower	2	
7	09180-06169	SPACER, fuel tank lower	2	
8	01550-06163	BOLT, fuel tank rear	2	
9	08310-00063	NUT, fuel tank lower	2	
10	09320M10022	CUSHION, fuel tank lower No. 2	2	
11	44542M31C00	CUSHION, fuel tank lower No. 1	2	

FIG. 27

MARKS

2d

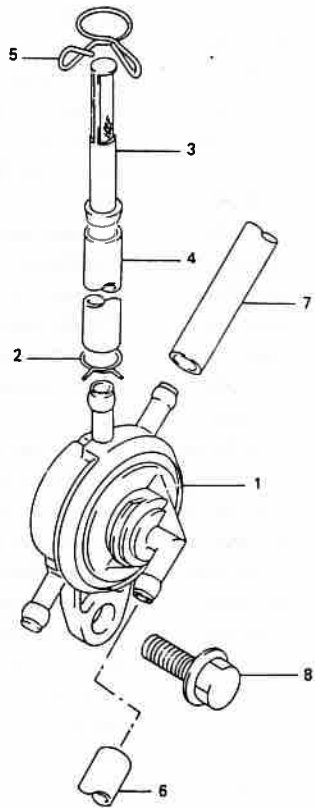

FIG. 27 (E-5) FUEL COCK

REF. NO.	PART NO.	DESCRIPTION	QTY	REMARKS
1	44300-11B01	COCK ASSY, fuel	1	
2	09401-08401	CLIP, fuel hose	7	
3 (X)	44322-27001	FILTER, fuel	1	
4	09359-50822-600	HOSE, fuel ON	1	
5	09401-10403	CLIP, fuel ON	1	
6	09352-50823-360	HOSE, fuel	1	
7	09352-50823-550	HOSE, breather	1	
8	01550-06163	BOLT	1	

4

FIG. 28

4

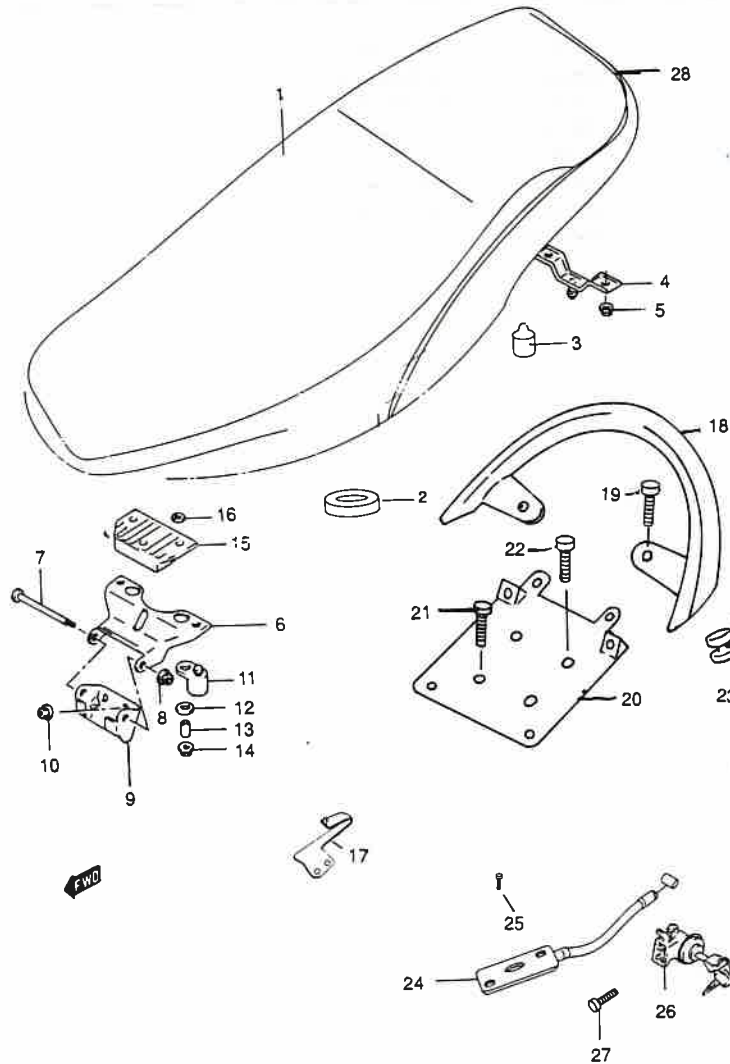

FX110

FIG. 28 SEAT

REF. NO.	PART NO.	DESCRIPTIONS	Q'TY	REMARKS
X	45100M30D10	SEAT ASSY	1	Discontinued
2	09321M14005	CUSHION, front	2	
3	45149M35410	CUSHION, rear	4	
4 (N)	45210-35420	STRIKER, comp seat lock	1	
5	08316-20063	NUT, striker	2	
6	45285M31CD0A	BRACKET, seal support front	1	
7	09111-06001	BOLT	1	
8	08361-35066	NUT, seat support frt.	1	
9 (N)	45260M31C00	HOLDER, seat	1	45260-31C00
10	08316-20063	NUT, seat holder	3	
11	45148M31CD0A	CUSHION, seat hinge twr	1	
12	09160-06039	WASHER, seat brkt lwr	2	
13	09180-06035	SPACER, seat blk lr.	2	
14	08316-20063	NUT		
15	45149M31CDOB	CUSHION, seat hinge upper	1	
16	08322-01063	WASHER, seat sprt brkt upper	2	
X	95721M30D00B	HOLDER, helmet	1	Discontinued
X (N)	46211M05F00-214	HANDLE COMP, pillion rider	1	Discontinued
19	01517M08283	BOLT, pillion rider dhl	2	
20 (N)	46220M30D10	BRACKET, comp pillion rider hdl	1	46220M30D10-BLK
21	01550M06163	BOLT, brkt pillion rider hdl frt	2	
22	01517M08163	BOLT, brkt pillion rider hdl rear	2	
23 (N)	47115M05F00	CUSHION, pillion	2	
24 (N)	45220M31C01A	BRACKET, comp seat support rear	1	
25	02122-06253	SCREW	2	
26	95700-31C00	LOCK, seat	1	95709-31C00
27	02112-75103	SCREW	2	
28 (N)	45160M30D10	Cover Comp, seat (PVC)	1	

FIG 29

FIG. 29 (D-9) TAIL COVER

REF. NO.	PART NO.	DESCRIPTION	QTY	REMARKS
1	47341M31C00B	COVER, upper	1	
2	01550M06253	BOLT, upper cov. rear	2	
3	09169-06041	WASHER, upper cover rear	2	
4	09180M06082	SPACER, upper cover rear	2	
5	09169-06041	WASHER, upper cover front	2	
6	47341M30D99A	CUSHION, cover upper side	2	

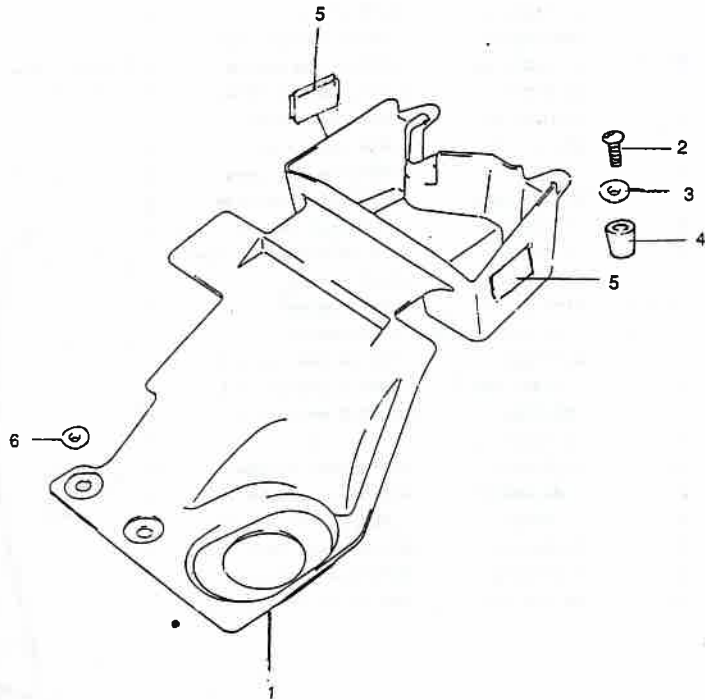

MARKS

ved

COO

ved
ved

D10-BLK

COO

4

FIG. 30

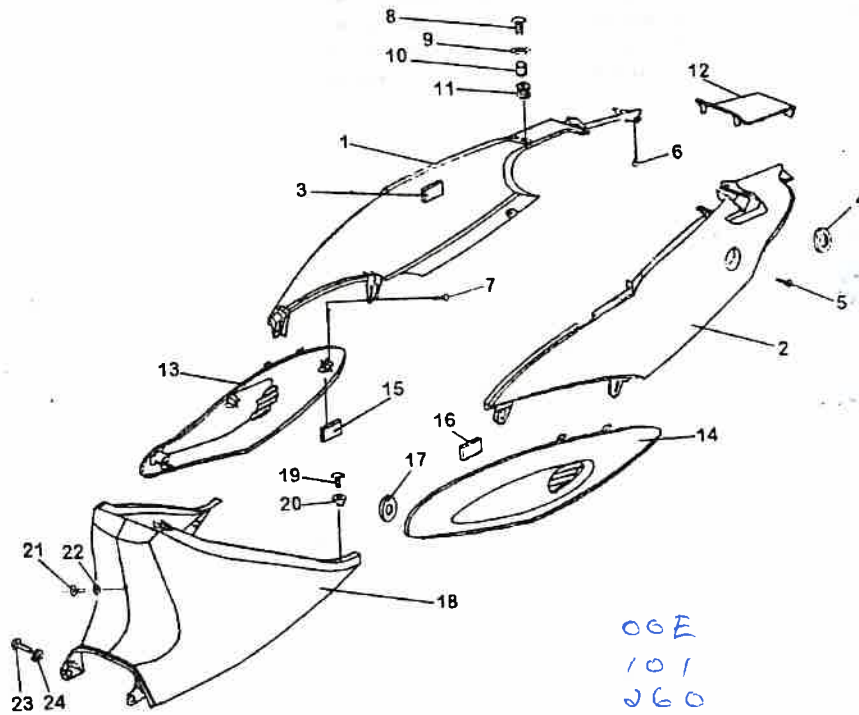

00E
101
260
260
270
800
880

FIG. 30 (D-10) FRAME COVER

REF. NO.	PART NO.	DESCRIPTION	QTY	REMARKS
1	(X) 47111M30D10	COVER SIDE, R	1	
2	47211M30D10	COVER SIDE, L	1	
3	44261M29C00	CUSHION, bolt rr abs. upper	2	
4	X (X) 45522M30D00A	GROMMET, seat lock hole	1	Discontinued
5	03241-05163	SCREW, side cover RR lower	2	
6	03541M14123	SCREW, cover seat tail	4	
7	03541M14123	SCREW, side cov. low. in.	4	
8	02142M06163	SCREW, side cover, center	2	
9	09160M30D99A	WASHER, side cover, center	2	
10	09180M06011A	SPACER, legshield lower	2	
11	09320M09026	CUSHION, brce legshield lower	2	
12	(X) 45511M30D10	COVER, seat tail	2	
13	(X) 47131M30D10 - S/L	COVER, side low-R	1	
14	(X) 47231M30D10 - S/L	COVER, side low-L	1	
15	47131M30D99A	CUSHION, cover side lwr R	1	
16	47231M30D99A	CUSHION, cover side lwr L	1	
17	09320M08028	CUSHION, side cover lwr	2	
18	(X) 47311M30D10	COVER, center	1	
19	02142-06126	SCREW, center cov. upper	2	
20	09169M06071A	WASHER, ctr cov upper	2	
21	02142M05123	SCREW, center cover	1	
22	09169-05012	WASHER, center cover	1	
23	02142M06163	SCREW, center cov. lower	2	
24	09160M30D99A	WASHER, center cov. lower	2	

FIG. 31

FIG. 31 (D-11) LEG SHIELD

REMARKS

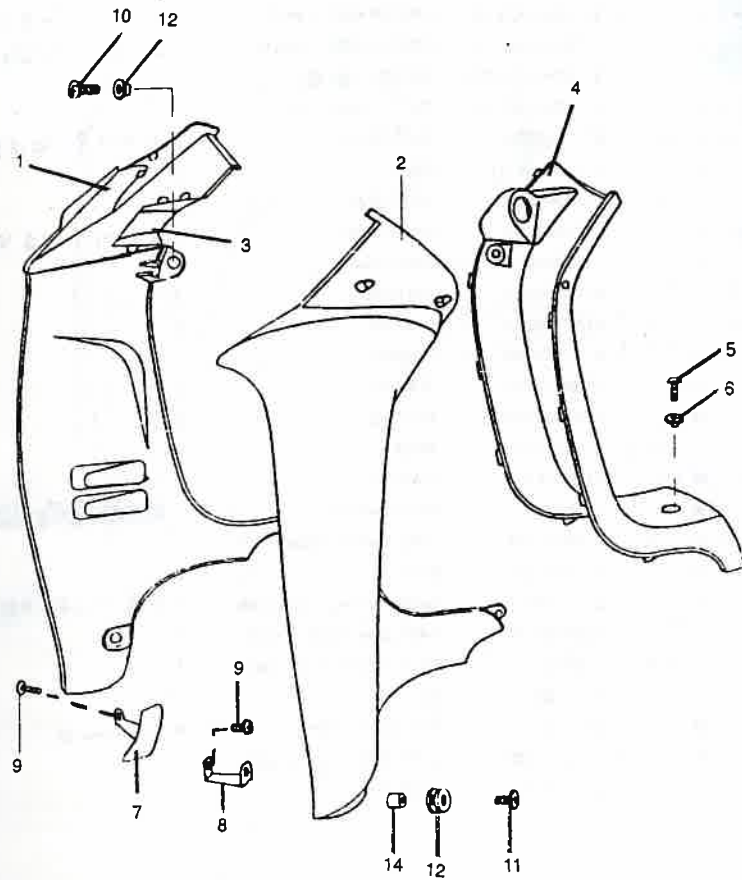

REF. NO.	PART NO.	DESCRIPTION	QTY	REMARKS
1	(N) 48111M30D10	SHIELDLEG, R	1	88111M30D10
2	(N) 48121M30D10	SHIELDLEG, L	1	
3	(N) 48272M30D10	COVER, main switch	1	
4	48131M30D10	SHIELD LEG CENTER	1	
5	02142M06205	SCREW, leg shield center	1	
6	09169M06071A	WASHER, center	1	
X	48140M30D99B	BRACE, comp. leg shield, R	1	Discontinued
X	48150M30D00A	BRACE, comp. leg shield, L	1	Discontinued
9	02112-36163	SCREW, leg shield brace	2	
10	09125-06100	SCREW, leg shield front	2	
11	09136-06009	SCREW, leg shield lower	2	
12	09169M06071A	WASHER, shield leg centre	2	
13	09320M09026	Cushion, Brace Leg Shield Lower	2	
14	09180M06011A	Spacer Leg Shield Lower	2	

4

FIG. 32

4

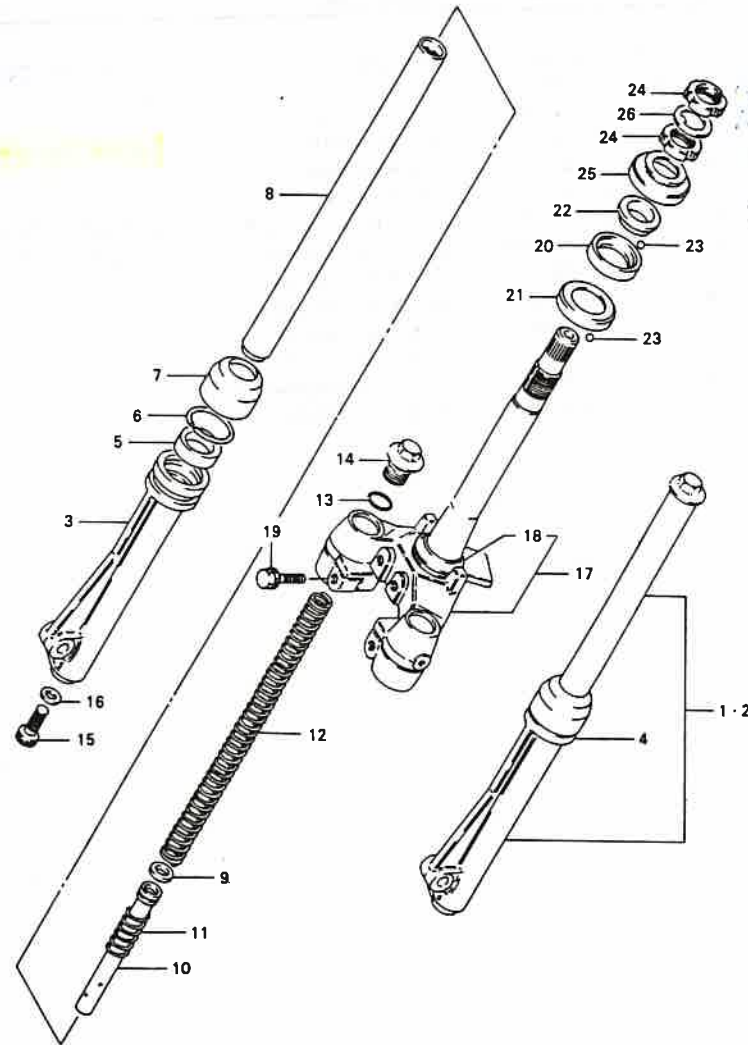

FIG. 32 (F-2) FRONT FORK

REF. NO.	PART NO.	DESCRIPTION	QTY	REMARKS
1	51103M35420-126	DAMPER ASSY, front RH	1	51103 M35420-126
2	51104M35420-126	DAMPER ASSY, front LH	1	51104 M35420-126
3	51130M35400-126	.OUTER TUBE, RH	1	
4	51140M35400-126	.OUTER TUBER, LH	1	
5	(N) 51153M02501	.OIL SEAL	2	51153-02501
6	51156M43010	.RING	2	
7	(N) 51173M43210	.DUST SEAL	2	
8	51111M35400	.INNER TUBE	2	51111-35400
9	51196M39140	.RING, piston	2	
10	(N) 51146M35420	.CYLINDER	2	
11	(N) 51177M35400	.SPRING	2	
12	(N) 51171M35400	.SPRING	2	
13	09280M15007	.O RING	2	
14	51351M03A00	.BOLT. cap	2	
15	(N) 51147M16510	.BOLT	2	
16	(N) 51148M41310	.GASKET	2	
17	(N) 51410-31C01	STEM, steering	1	51410-31C01
18	(N) 51622-35400	.RACE, steering outer, lower	1	
19	01570-08307	BOLT	2	
20	51611-2002	RACE, steering inner, upper	1	51611-2002
21	51612-35100	RACE, steering inner, lower	1	
22	(N) 51621-25000	RACE, steering outer, upper	1	
23	06111-06003	BALL	49	
24	(N) 51631-05000	NUT, steering stem	2	
25	(N) 51643M06001	DUST SEAL, steering, upper	1	
26	09166-24001	WASHER	1	

FIG. 33

FIG. 33 (E-3) FRONT FORK COVER

RKS

06-12
00-12
11
0

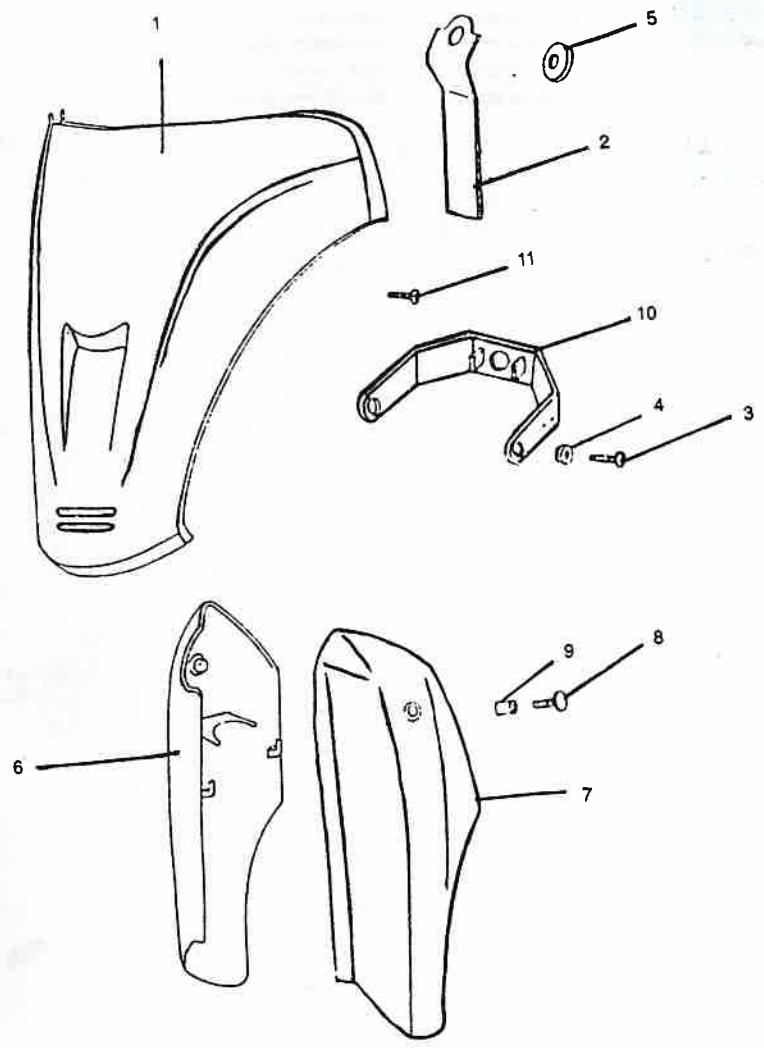

REF. NO.	PART NO.	DESCRIPTION	QTY	REMARKS
1	51871M30D10	COVER, frame head	1	
2	51862M30D10	PLATE COMP, frame head cover No. 2	1	
3	02142M06167	SCREW, frame head cover	2	
4	09169-06010	WASHER, frame head cover	2	
5	09320-08028	CUSHION, head cover	1	
6	51881M30D10	COVER, front fork side RH	1	
7	51882M30D10	COVER, front fork side LH	1	
8	02142M06167	SCREW	2	
9	09180M06089	SPACER	2	
X (X)	51860M30D00A	PLATE COMP, frame head cover	1	discontinued
11	03541M04168	SCREW, frame head cover upper	4	

00E
101
260
262
272
828
888

4

FIG. 34

FIG. 34 (E-4) FRONT FENDER

REF. NO.	PART NO.	DESCRIPTION	QTY	REMARKS
1	53111M30D10	FENDER, front	1	
2	53124M35400	REINFORCEMENT, front fender	1	
3	01104M06166	BOLT, front fender	3	
4	09169-06060	SPACER, front fender	3	

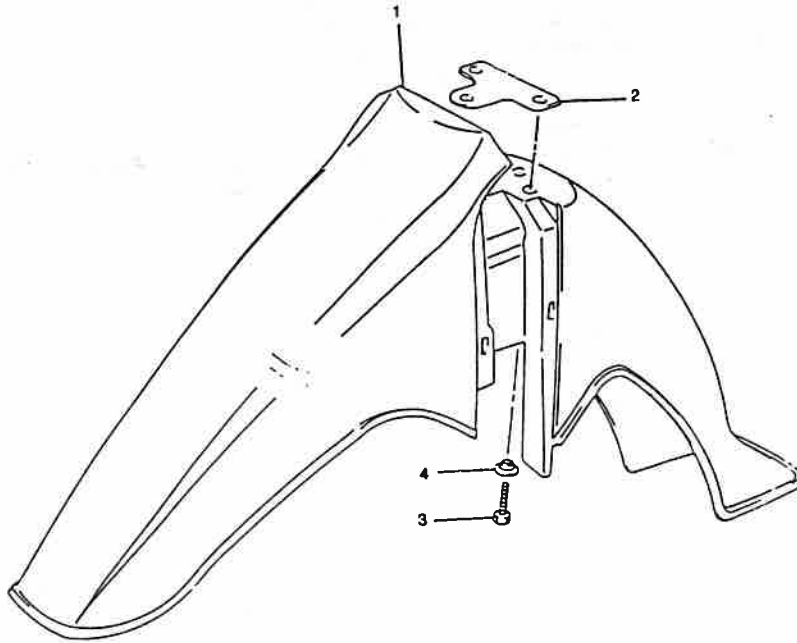

4

FWC

FIG. 35

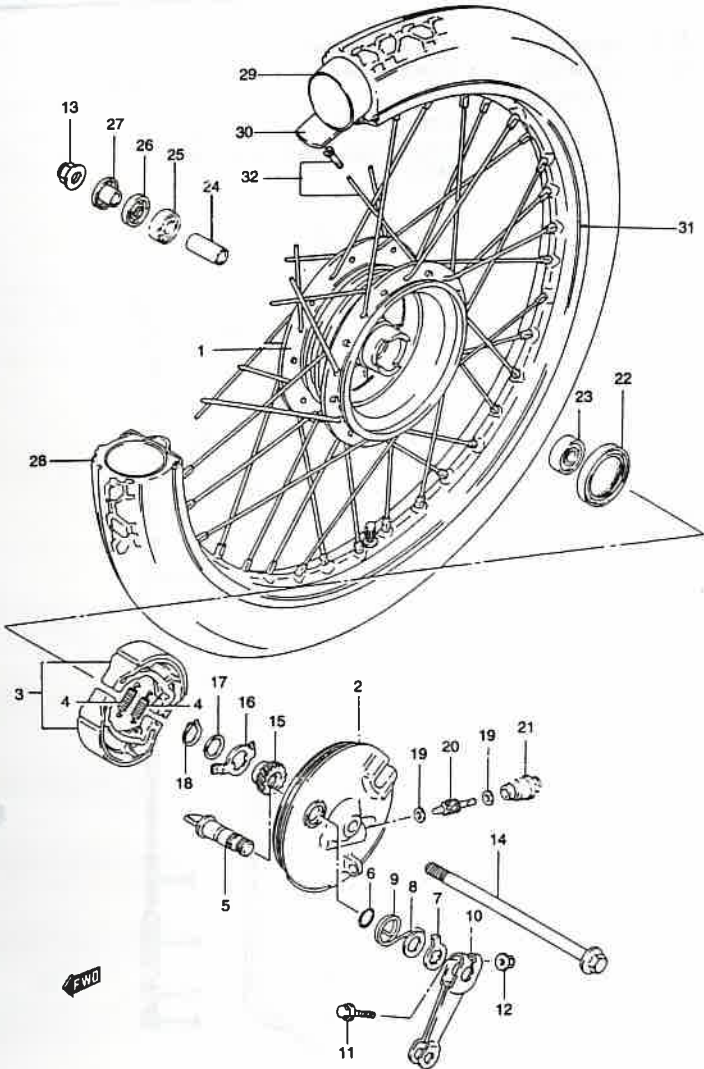

FIG. 35 (E-5) FRONT WHEEL

REF. NO.	PART NO.	DESCRIPTIONS	Q'TY	REMARKS
1	54110M35400	HUB, front wheel	1	54110-35400-102
2 (N)	54210M35400	PANEL, front hub	1	54210-35400-102
3	54410M35060	SHOE, brake	2	
4	09443-07025	SPRING	2	
5 (N)	54441-16D00	SHAFT, brake cam	1	
6	09280-14011	O RING	1	
7	54492-35100	PLATE, brake lining	1	X
8	09160-14054	WASHER	1	
9	09448-30009	SPRING	1	
10 (N)	54451-35100	LEVEL, brake cam	1	54451-35400
11	09103-06045	BOLT	1	
12	08316-10063	NUT	1	
13	08319-31107	NUT	1	
14 (N)	54711-35411	AXLE, front	1	
15 (N)	54611-03601	GEAR, speedometer (NT:23)	1	
16 (N)	54661-03000	DRIVER, speedometer gear	1	
17	09160-16005	WASHER, 16X22X1	1	
18	08331-31156	CIRCLIP	1	
19	09160-05001	WASHER, 5.1X8X0.4	2	
20 (N)	54621-39202	PINION, speedometer (NT:9)	1	
21 (N)	54632-02201	BUSHING, driven gear outer	1	
22	09285-43001	OIL SEAL	1	
23	08143M63007	BEARING, LH	1	
24	09180M10091	SPACER, bearing	1	
25	08123M62007	BEARING, RH	1	
26	09284-15001	OIL SEAL	1	
27 (N)	54740-26101	SPACER, axle RH	1	
28	55100M09401A	TIRE, front, 2.50-17	1	
29	55200M01011	TUBE, Inner	1	
30	55261M01010	PROTECTOR, Inner tube	1	
31	55311M01021A	RIM, wheel 1.40x17	1	
32 (N)	55320M01012	SPOKE ASSY, front	1	55320-01012

4

FIG. 36

FIG. 36 (E-7) HANDLE COVER

REF. NO.	PART NO.	DESCRIPTION	QTY	REMARKS
1	(N) 56311M30D10	COVER, handle front	1	
2	(N) 56321M30D10	COVER, handle rear	1	
3	02142M05125	SCREW, front	1	
4	03541-05203	SCREW, rear	4	
5	03541M04163	SCREW, handle cover FR & RR (M4X16)	2	

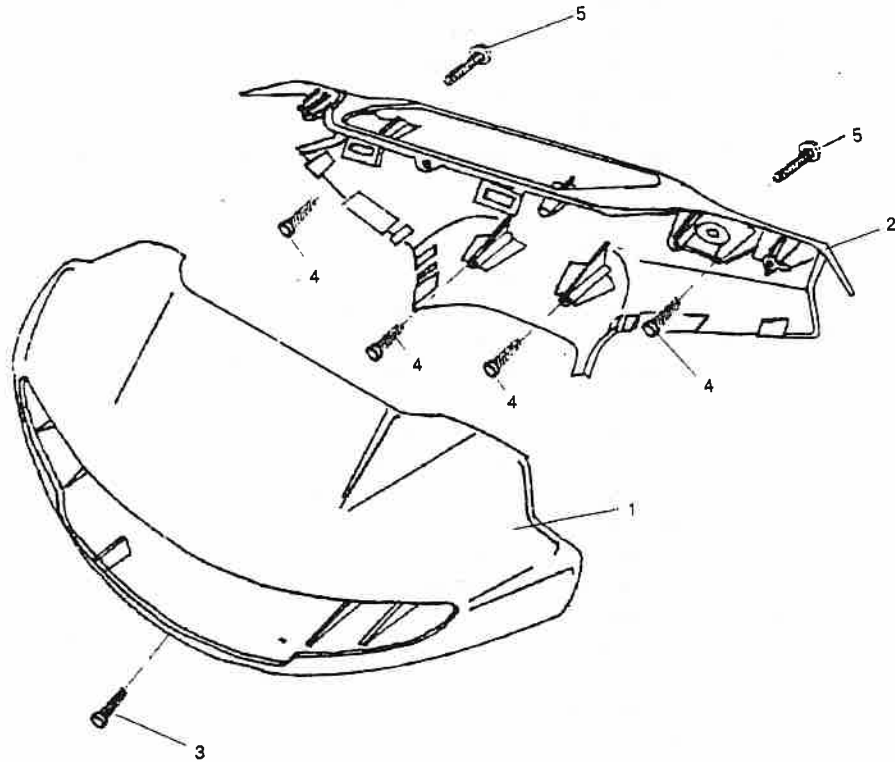

4

FIG. 37

REMARKS

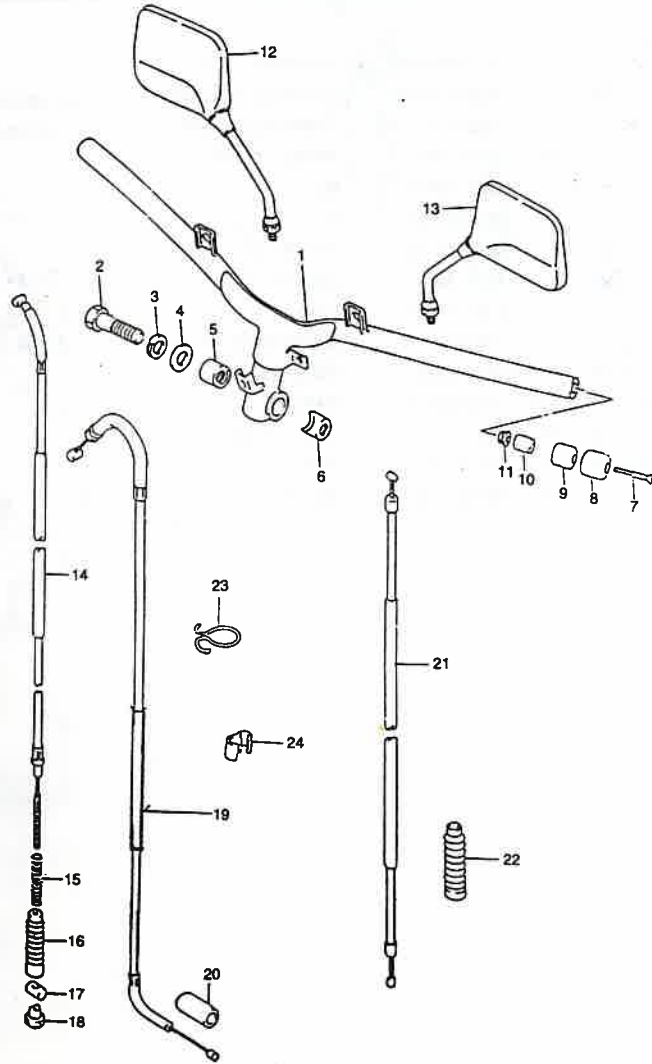

FIG. 37 (E-8) HANDLEBAR

REF. NO.	PART NO.	DESCRIPTION	QTY	REMAR
X	56110M31C10B	HANDLEBAR COMP	1	GSX/FC DISCONTINUED
2	09100-12061	BOLT	1	
3	083210-01123	LOCK WASHER	1	
4	08322M01123	WASHER	1	
5 (N)	51358-35420	STOPPER NO. 1	1	
6 (N)	51359-35410	STOPPER NO. 2	1	
7	02122-06803	SCREW	2	
8 (N)	56278M32E00A	BALANCER	2	
9 (N)	56272M31C00	EXPANDER	2	
10	09180-06069	SPACER	2	
11	08316M10063	NUT	2	
12 (N)	56500M09C00	MIRROR ASSY, rear view RH	1	56500M30099A
13 (N)	56600M09C00	MIRROR ASSY, rear view, LH	1	56600M30099A
14 (N)	58110M35411	CABLE ASSY, front brake	1	
15	09440-06003	SPRING	1	
16	09287M07002	DUST SEAL	1	
17	09209-10001	PIN	1	
18	09150-05101	NUT	1	
19 (N)	58300M30DA0B	CABLE ASSY, throttle	1	
20	09287M07002	DUST SEAL	1	
21 (N)	58410M30D00A	CABLE ASSY, starter	1	
22	58333-35400	DUST SEAL	1	
23	58621-35400	GUIDE, cable	1	
24	09408-00002	CLIP, cable	1	

4

FIG. 38

FIG. 38 (E-9) HANDLE SWITCH

REF. NO.	PART NO.	DESCRIPTIONS	QTY	REMARKS
1	57110M30D00C	Grip, throttle <i>FX</i>	1	
X	57300M35417A	LEVER HOLDER & SWITCH ASSY-	1	(DOMESTIC - W/STOPPER HDL) <i>AS AV.</i>
X 2-2	57300M35471B	LEVER HOLDER & SWITCH ASSY-	1	(OVERSEAS) <i>electric start (overseas)</i>
3 <i>(FX)</i>	57460-10B01	SWITCH <i>RC/B</i>	1	
4	57431-02910	BOLT	1	
5	08319-21055	NUT	1	
6 <i>(FX)</i>	09125-05065	SCREW	1	
X <i>(FX)</i>	57421M35410	LEVER, brake <i>RC/ASX</i>	1	<i>Discontinued</i>
8	57211M35400	GRIP, LH	1	<i>57211M30D00A</i>
9	37400M35400	SWITCH ASSY, LH	1	<i>37400-35401T</i>
10	58711-13201	BODY, choke lever	1	
11 <i>(FX)</i>	58722-03011	WASHER	1	
12 <i>(FX)</i>	58721-35400	LEVER, choke	1	
13 <i>(FX)</i>	37574-49440	SCREW	1	
14 <i>(FX)</i>	09125-05065	SCREW	1	

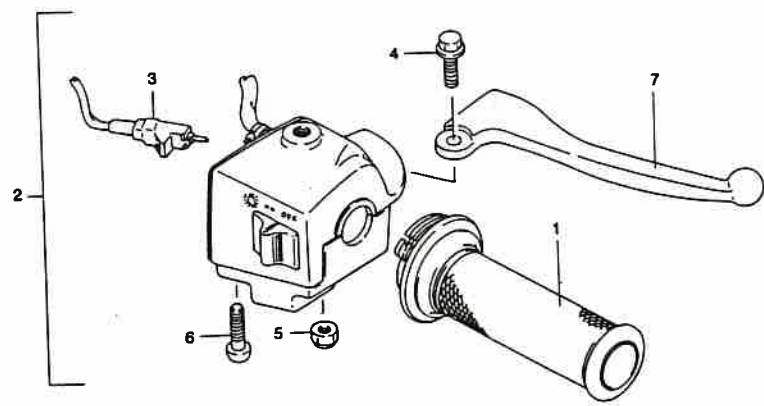
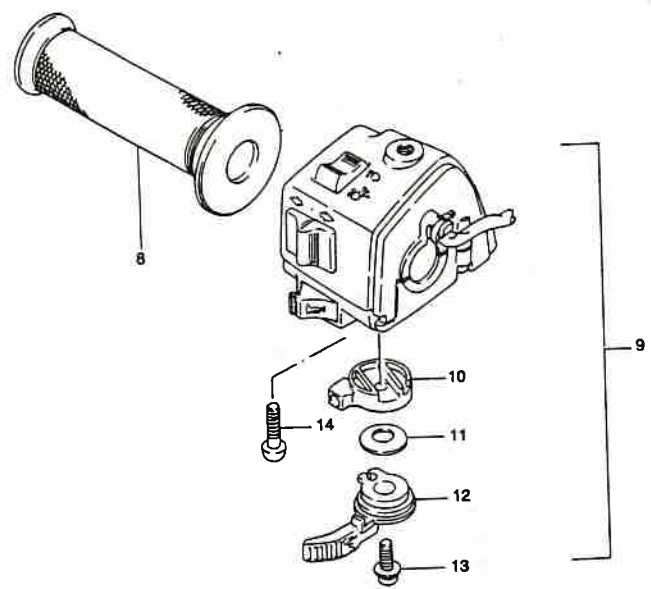

4

REMARKS

PER HDL) MSAV
 ric start
 2/28/97

ved
 3D 00X
 54017

FIG. 39

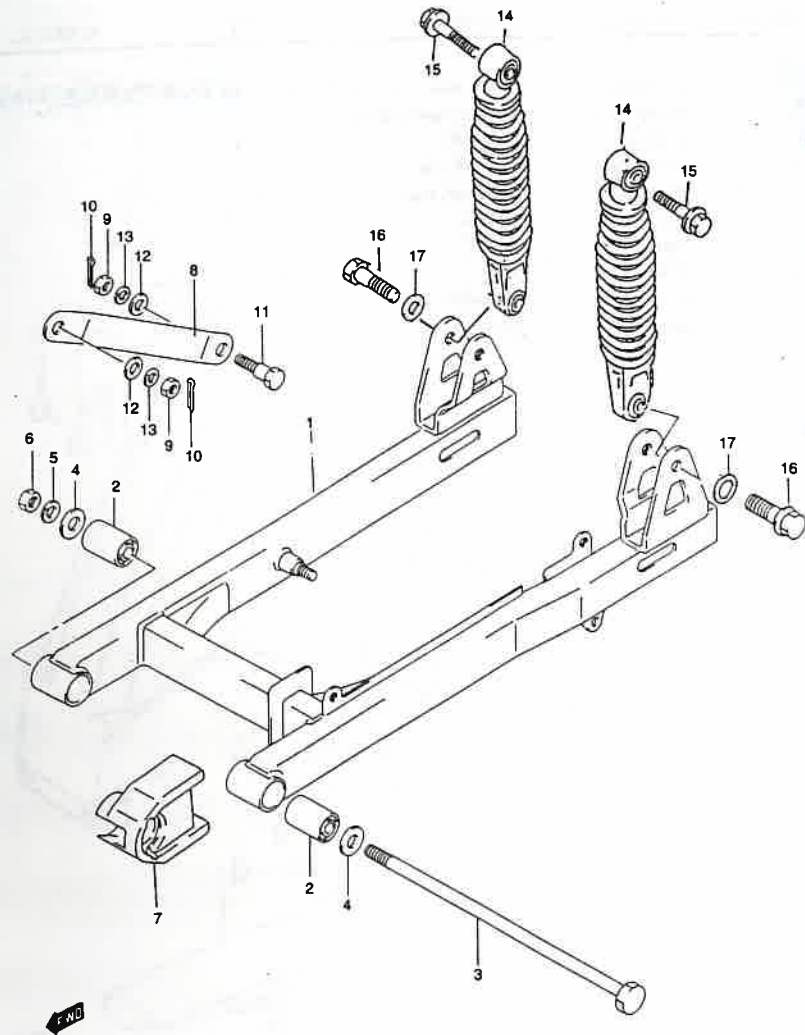

FIG. 39 (F-4) REAR SWINGING ARM

REF. NO.	PART NO.	DESCRIPTION	QTY	REMARKS
1 (N)	61100M31C20A	SWINGING ARM, rear	1	FSX
2 (N)	09319-10009	BUSHING	2	
3	61211-31C00	SHAFT, rear swinging arm	1	
4	08322-01107	WASHER	2	
5	09162-10008	LOCK WASHER	1	
6	08310-00107	NUT	1	
7 (N)	61273M31C10	BUFFER, chain touch defense	1	
8	64311M31C10	TORQUE LINK, rear	1	64311-31C10
9	09140-08008	NUT	2	
10	04111-20208	COTTER PIN	2	
11	09111-08016	BOLT	1	
12	08322-01083	WASHER	2	
13 (N)	09162-08008	LOCK WASHER	2	
14 (N)	62100M30D00B	ABSORBER ASSY, rear shock	2	Discontinued
15	09116M10022	BOLT, shock absorber upper	2	
16	01550M10353	BOLT, shock absorber lower	2	
17	08322M21108	WASHER	2	

4

FIG. 40

4

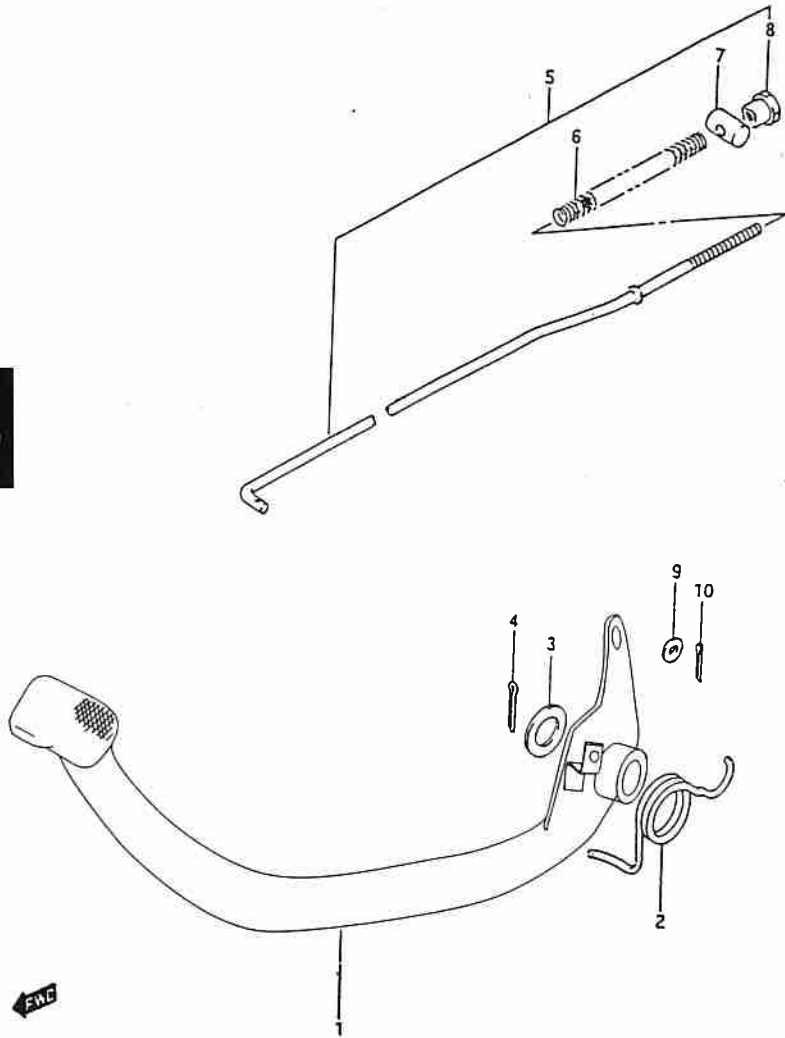

FX110

FIG. 40 (E-11) REAR BRAKE

REF. NO.	PART NO.	DESCRIPTION	QTY	REMARKS
X (N)	43110M30D00A	PEDAL, brake 6Sx/FO110X	1	Discontinued
2	09448M31016	SPRING, brake pedal return	1	
3	09160-15002	WASHER	1	
4	04111-30308	.COTTER PIN	1	
5 (N)	43300-31C10	ROD ASSY, brake	1	
6	09440-09004	.SPRING	1	
7	09209-11002	.PIN	1	
8	09150-06009	.NUT	1	
9	08322-01053	.WASHER	1	
10	04111-20208	.COTTER PIN	1	

FIG. 41

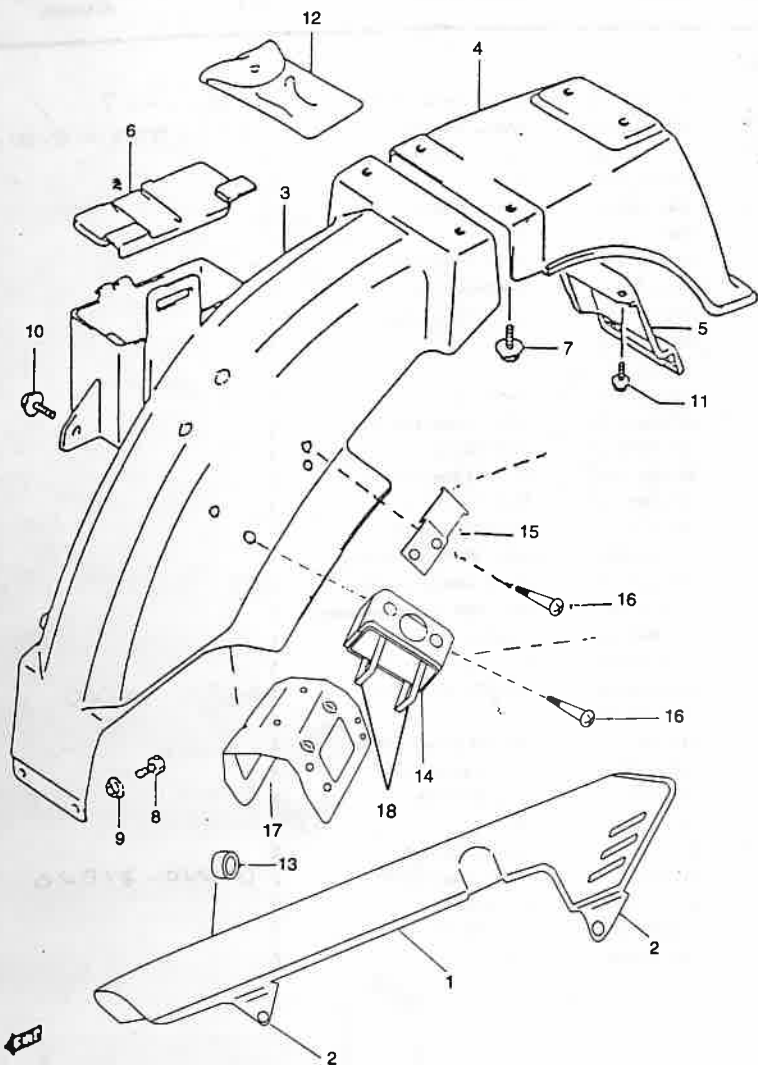

FIG. 41 (F-4) REAR FENDER

REF. NO.	PART NO.	DESCRIPTION	QTY	REMARKS
1	(2) 61311M31C00A	CASE, chain <i>RR sport</i>	1	
2	01517M06105	SCREW, chain case	2	
3	63112M31C00D	FENDER RR FRONT	1 <i>z</i>	
4	63113M30D10	BODY REAR FENDER RR	1	
5	(2) 63120M31C00A	REINFORCEMENT, rear fender	1 <i>63120-31C00</i>	
6	41576M31C00A	COVER, battery	1 <i>x</i>	
7	09116-06168	BOLT, center (6x16)	2	
8	01500-06123	BOLT, front (6x12)	2	
9	09169-06060	WASHER	2	
10	09116-06167	BOLT, front (6x20)	1	
11	01550M06163	BOLT, rear	2	
<i>x</i> 12	09800-21004	TOOL ASSY	1	
13	61375M31C20A	CUSHION, chain case	1 <i>x</i>	
14	32931M30D00A	BRKT CDI UNIT	1 <i>x</i>	
15	31891M30D00A	BRKT, stg mtr rly	1 <i>x</i>	
16	05013M04109A	RIVET	6	
17	(2) 63112M30D99B	BRACE, Fender Rear Fr	1	
18	32980M30D20	CUSHION CDI Unit	1 <i>x</i>	

FX110

4

FIG. 42

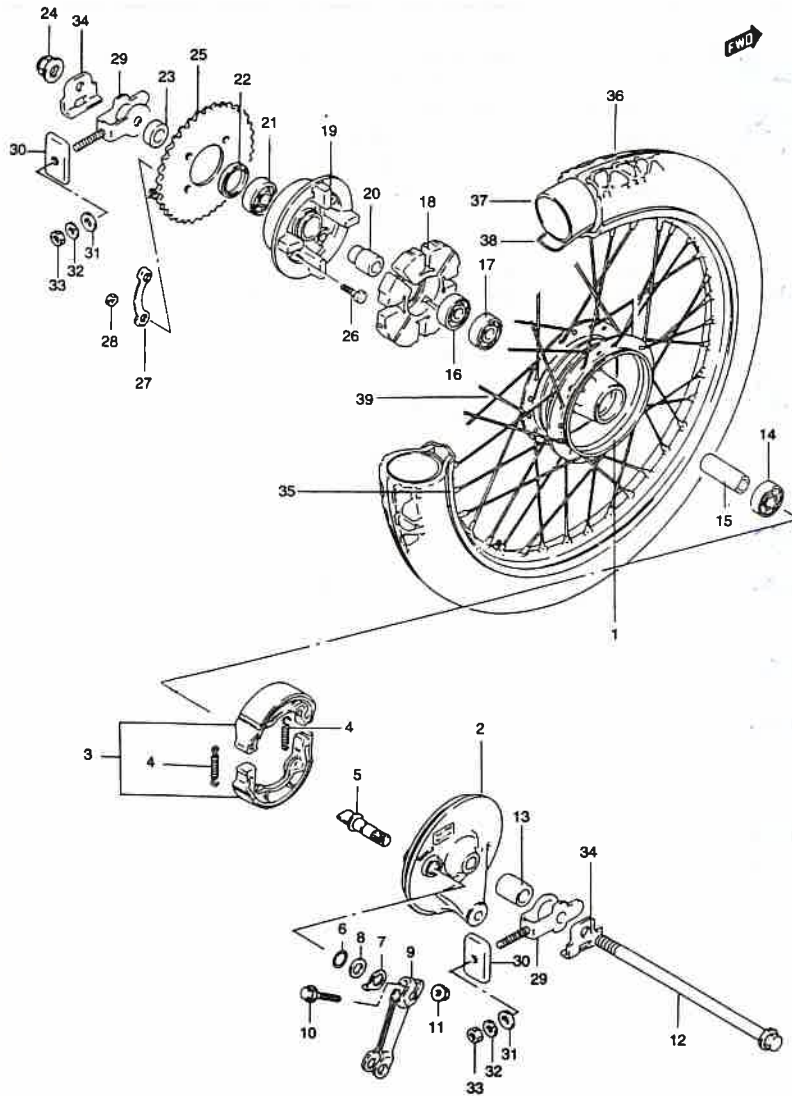

FX110

FIG. 42 (F-7) FRONT FORK

REF. NO.	PART NO.	DESCRIPTIONS	Q'TY	REMARKS
1	64110M35300	DRUM, rear hub	1	7A25/7K 64110-0960J
2	64210M46005	PANEL, rear hub	1	64210M46003-S/L
3	54410M35060	SHOE, set brake	1	
4	09443M35060	SPRING	2	
5	54441-29305	SHAFT, brake cam	1	
6	09280-14011	O-Ring	1	
7	54492-35400	PLATE, brake lining	1	X
8	09160-14054	WASHER	1	
9	64451-43020	LEVEL, brake cam	1	
10	09103-06045	BOLT	1	
11	08316-10063	NUT	1	
12	64711-31C20	AXLE, rear	1	
13	64731M31C20	SPACER, rear, axle, RH	1	
14	08143M63017	BEARING, RH	1	
15	09180M12084	SPACER, rear, axle, RH	1	
16	08143M62017	BEARING, LH	1	
17	08113M62017	BEARING, inner LH	1	
18	64651M01001	ABSORBER, rear hub shock	1	
19	64611M01001	DRUM, sprocket mounting	1	X
20	64733-43000	RETAINER, sprocket mounting	1	
21	08113M62037	BEARING	1	
22	09285-25003	OIL SEAL	1	
23	64721M35500	SPACER, rear, axle, LH	1	64721-35500
24	08319-31128	NUT	1	
25	64511M31C40	SPROCKET, rear (NT-37)	1	
26	64541-30D00	BOLT, rear sprocket	4	X
27	09169M08011	LOCK WASHER	2	
28	08310-00083	NUT	4	
29	61410-35500	ADJUSTER, chain	2	
30	61420M31C20	GUIDE, chain adjuster	2	61420-31C20
31	08322-01083	WASHER	2	
32	09162-08008	WASHER, lock	2	
33	08310-00083	NUT	2	

FIG. 42

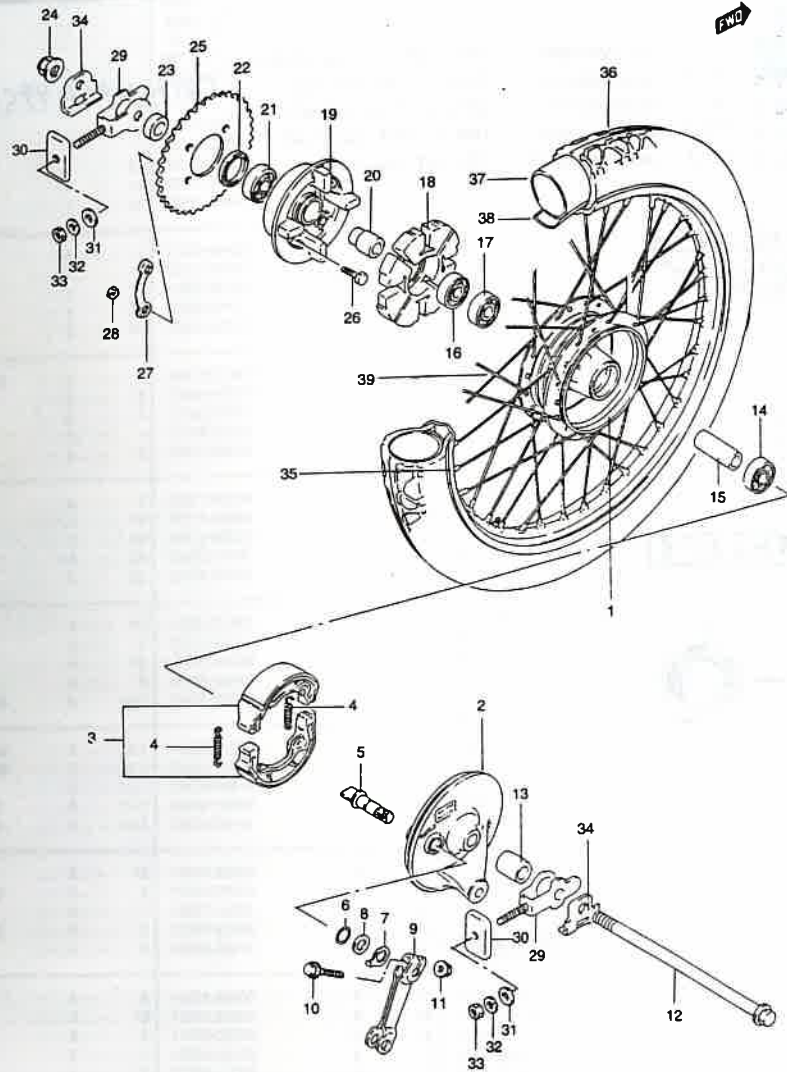

FIG. 42 (F-7) REAR WHEEL

REF. NO.	PART NO.	DESCRIPTION	Q'TY	REMAR
34	64712M20900	WASHER, adjust guide	2	64712-20900
34	65311M46730	RIM, wheel (1 60x17)	1	Discontinued
36	65110M31C00A	TIRE (2 75-17-4PR) IRC1	1	
37	55200M03600	TUBE ASSY, inner	1	
38	55261M01010	PROTECTOR, inner tube	1	X
39	65320M03021	SPOKE SET, rear wheel	1	X

4

FIG. 43

FIG. 43 (F-7) GRAPHIC DESIGN

REF. NO.	PART NO.	DESCRIPTIONS	Q'TY	REMARKS
1	68310M30D99A	TAPE 'SUZUKI' COVER CENTER	2	
2	68190M30D99A/B	EMBLEM, cover frame head	1	68190M30D99C000
3	68280M30D99A	TAPE 'FX110' SPEEDOMETER	1	
4	68320M30D99A	TAPE '4 STROKE CLEAN AIR'	1	
5	68131M30D99A/B	TAPE SET, cover side F/L	1	

4

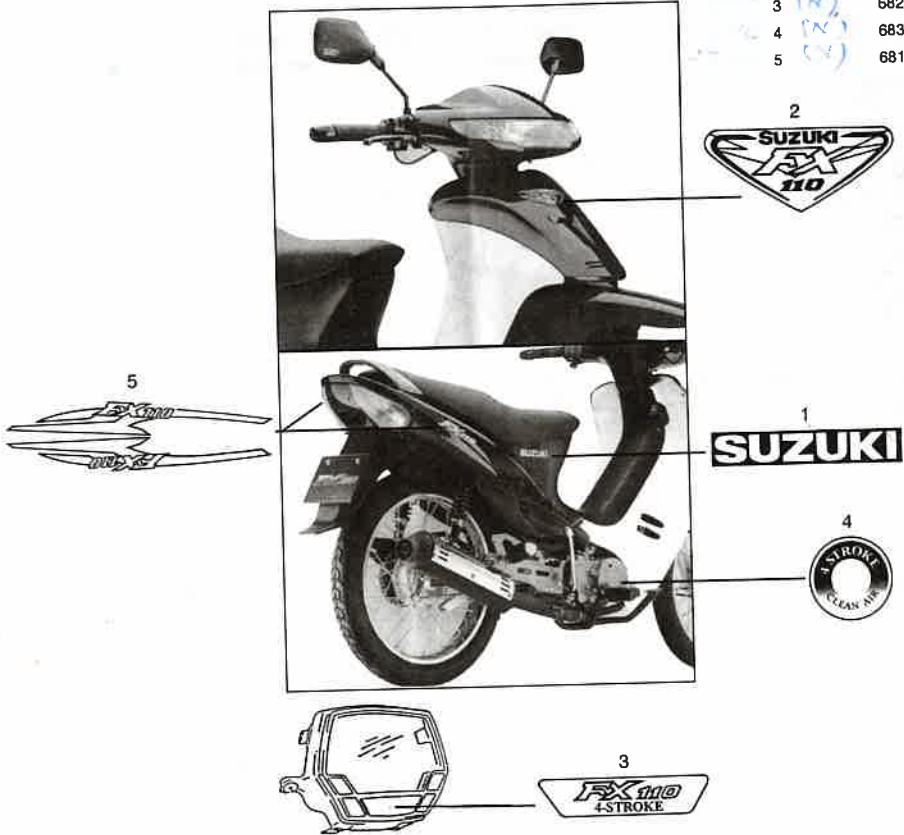

PART NO.	DESCRIPTIONS	Q'TY	REMARKS
100			
11110-3			
11115-3			
11121M			
11134M			
11135M			
11141-3			
11144-0			
11149M			
11175M			
11186-3			
11211M			
11241M			
11280-3			
11300M			
11329-3			
11340M			
11351M			
11361M			
11362M			
11383M			
11389M			
11482M			
11483M			
11971M			
12111M			
12111M			
12140-3			
12140-3			
12140-3			
12151M			
12161M			
12200M			
12211M			
12220M			
12260M			
12548M			
12600M			
12611M			
12612M			

PART NO.	FIG. NO.	REF. NO.	PART NO.	FIG. NO.	REF. NO.	PART NO.	FIG. NO.	REF. NO.
10000			12633-05300	6	10	13411-01010	9	24
			12649-30D00	6	13	13417-01010	9	23
			12711-30D00	7	21	13418-43410	9	22
			12713-09401	7	19	13447-30A00	9	6
			12741-30A10	7	2	13494-09410	9	26
			12747-30D00	7	3	13551-30D00	9	10
			12755-30A00	7	5	13573-30D00	9	5
			12760-30A10	8	1	13601-04148	9	18
			12771-30A04	8	2	13615-09400	9	8
			12811-30A02	8	3	13661-02B00	9	3
		12812-30A00	8	4	13681-04010	9	21	
		12830-30A01	8	6	13700M30D20	10	1	
		12832-02A00	8	9	13741M30D20	10	2	
		12833-30A01	8	7	13781M30D20	10	3	
		12834-02A00	8	8	13870-11078	10	8	
		12837M19B10	8	10	13877-38A00	10	10	
		12840-09D01	7	7	13881-30D20	10	6	
		12842-49201	7	8	13892M30D20	10	13	
		12843-27A00	7	9	14181M30A10	11	1	
		12861-09D00	7	10	14186M30D10	11	15	
		12871-30A00	7	11	14310M30D10	11	3	
		12911-30D00	7	12	14411M30D00	11	4	
		12912-30D00	7	13	14415M30D99A	11	6	
		12920-30A01	7	14	14773M30D00A	22	15	
		12931-09400	7	15	14773M41D00	11	7	
		12933-27A00	7	16	14781M30D00B	11	12	
		12933-39E00	7	17	16321-30A02	5	12	
		13110-30D00	1	25	16325-30D00	13	1	
		13129-30A00	1	26	16331-09420	12	3	
		13131-30D00	1	30	16400-09410	12	1	
		13200-30D20	9		16520-30A00	12	9	
		13427-13A00	9	20	16540-30D00	12	11	
		13429-30A10	9	2	16543-30D00	12	10	
		13250-16A00	9	13	16544-30D00	12	3	
		13254-20010	9	15	16910-30D00	3	9	
		13528-30A00	9	17				
		13261-30D00	9	1				
		13267-09400	9	25				
		13267-47A00	9	29				
		13268-35010	9	30				
		13291-29900	9	27	21102-30A10	13	2	
		13295-29900	9	28	21111-09D00	13	3	
		13370-09D00	9	14	21200-30D01	13	10	
		13383-30D00	9	9	21412-30D00	13	11	
		13394-40D00	9	7	21441-21D20	13	12	

20000

PART NO.	FIG. NO.	REF. NO.	PART NO.	FIG. NO.	REF. NO.	PART NO.	FIG. NO.	REF. NO.
21442-21D20	13	13	26300M30A21	16	13	34182M12B00	20	5
21451-30D00	13	14	25352M01000	16	14	34810-31C00	26	3
21461-30D00	13	15	27511-26400	14	20	34825-02100	26	4
21481-21D20	13	16	27600M20910-098	14	21	34910M31C00	20	12
21499-30D00	13	18	27620-20910	14	22	35120M30D95A	21	7
21501-30D00	13	23				35120M30D97A	21	10
21541-30D00	13	24				35120R31C99A	21	1
21631-02A04	13	4				35171R30D10	21	4
21652-30D01	13	5				35618M30D10	21	2
23121-21D10	13	27				35652M47E10	22	2
23221-09D01	13	28	31100-30D00	17	1	35672M47E10	22	3
23222-09D01	13	29	31130-35400	17	2	35710M47E10	22	1
23223-09D00	13	30	31131-35400	17	3	35711M30D99A	22	19
23230-30D01	13	35	31151-30D00	17	4	35712M47E10	22	4
23250-35402	13	36	31158-35400	17	6	35912M47E10	22	5
24121-35511	14	1	31170-43400	17	8	35927M36510	22	16
24130-30A20	14	9	31280-31C00	17	7	35970M05F00	22	14
24221-35422	14	2	31482-47000	15	33	36300M31831	20	3
24231-30A10	14	3	31800-19D00	19	10	36610M30D90A	23	1
24241-30A10	14	4	31891M30D00A	41	15	37100-30D20	23	4
24310-30A10	14	10	32101-30D00	18	1	37146-03A00	23	12-1.
24331-30A10	14	11	32102-30D00	18	2	37146-03A10	23	12-2.
24341-35420	14	12	32371-30D00	18	3	37146-03A20	23	12-3.
24741-09401	14	18	32800-43E00	19	1	37146-03A30	23	12-4.
25210-30A10	15	1	32900-30D00	19	3	37155M31C00	23	6
25220-30A10	15	2	32931M30D00A	41	14	37155M31C99A	23	13
25310-30A40	15	5	32980M30D20	41	18	37400M35400	38	9
25341-09400	15	6	33410-30D00	19	4	37574-49440	38	13
25350-09D00	15	16	33510-22010	19	7	37720-30D00	15	34
25355-09400	15	17	33541-24510	19	8	37740-48071	23	7
25381-30A20	15	7	33542-38B00	19	9	38500-31C01	23	9
25382-30A30	15	8	33610M31C00	19A	11	38610-09410	21	6
25382M35411	15	9	33610M35400	19B	11			
25421-35403	15	3	33651M31C01	19	12			
25510-30D00	15	23	33652M30D00A	19	16			
25520-09D03	15	20	33652M31C00A	19	14			
25610M30D00	15	30	33652M31C10	19	13			
25652M16500	15	31	33652M41D00	19	15			
25671-31C00	15	24	33810M30D00B	23	11			
26211-09410	16	1	34100M30D00A	20	1			
26221M30A00	16	2	34111M31C00	20	6	41100M30D10	24	1
26231-09401	16	3	34112M30D20	20	2	41576M31C00A	41	6
26232-09401	16	4	34148M31C00	20	10	42100M35400A	25	1
26233-09400	16	5	34170M31C00	20	7	42211M03001	25	2
26241-09410	16	6				42221-31C10	25	3

30000

40000

5

5

PART NO.	FIG. NO.	REF. NO.	PART NO.	FIG. NO.	REF. NO.	PART NO.	FIG. NO.	REF. NO.
42231-09000	25	- 4	48111M30D10	31	- 1	53124M35400	34	- 2
42251M03003	25	- 5	48121M30D10	31	- 2	54110M35400	35	- 1
42310M30DA0B	25	- 11	48131M30D10	31	- 4	54210M35400	35	- 2
43110M30D00A	40	- 1	48140M30D99B	31	- 7	54410M35060	35	- 3
43300-31C10	40	- 5	48150M30D00A	31	- 8	54410M35060	42	- 3
43510M30D00B	25	- 8	48272M30D10	31	- 3	54441-16D00	35	- 5
43551M39110	25	- 9				54441-29305	42	- 5
43600M39310	25	- 26-1				54451-35400	35	- 10
43610M39310	25	- 16-1				54492-35400	35	- 7
43612M30D00B	25	- 17				54492-35400	42	- 7
43620M31C99A	25	- 21				54611-03601	35	- 15
43620M39310	25	- 16-2				54621-39202	35	- 20
43631M39310	25	- 18				54632-02201	35	- 21
43660M30D00D	25	- 23-1				54661-03000	35	- 16
43700M39310	25	- 26-2	50000			54711-35411	35	- 14
43670M31D20D	25	- 23-2	51103M35420-126	32	- 1	54740-26101	36	- 27
44110M31C00	26	- 1	51104M35420-126	32	- 2	55100M09401A	35	- 28
44210-24D10	26	- 2	51111M35400	32	- 8	55200M01011	35	- 29
44281M29C00	30	- 3	51130M35400-126	32	- 3	55200M03600	42	- 37
44300-11B01	27	- 1	51140M35400-126	32	- 4	55261M01010	35	- 30
44322-27001	27	- 3	51146M35420	32	- 10	55261M01010	42	- 38
44542M31C00	26	- 11	51147M16510	32	- 15	55311M01021A	35	- 31
45100M30D10	28	- 1	51148M41310	32	- 16	55320M01012	35	- 32
45148M31C00A	28	- 11	51153M02501	32	- 5	56110M31C10B	37	- 1
45149M31C00B	28	- 15	51156M43010	32	- 6	56272M31C00	37	- 9
45149M35410	28	- 3	51171M35100	32	- 12	56278M32E00A	37	- 8
45160M30D10	28	- 28	51173M43210	32	- 17	56311M30D10	36	- 1
45210-35420	28	- 4	51177M35400	32	- 11	56321M30D10	36	- 2
45220M31C01A	28	- 24	51196M39140	32	- 9	56500M09C00	37	- 12
45260M31C00	28	- 9	51351M03A00	32	- 14	56600M09C00	37	- 13
45285M31C00A	28	- 6	51358-35420	37	- 5	57110M30D00C	38	- 1
45511M30D10	30	- 12	51359-35410	37	- 6	57211M30D00A	38	- 8
45522M30D00A	30	- 4	51410-31C01	37	- 17	57300M35471A	38	- 2-1
46211M05F00	28	- 18	51611-20002	32	- 20	57300M35471B	38	- 2-2
46220M30D10	28	- 20	51612-35400	32	- 21	57421M35410	38	- 7
47111M30D10	30	- 1	51621-25000	32	- 22	57431-02910	38	- 4
47115M05F00	28	- 23	51622-35400	32	- 18	57460-10B01	38	- 3
47131M30D10	30	- 13	51631-05000	32	- 24	58110M35411	37	- 14
47131M30D99A	30	- 15	51643M06001	32	- 25	58300M30DA0B	37	- 19
47211M30D10	30	- 2	51860M30D00A	33	- 10	58333-35400	37	- 22
47231M30D10	30	- 14	51862M30D10	33	- 2	58410M30D00A	37	- 21
47231M30D99A	30	- 16	51871M30D10	33	- 1	58621-35400	37	- 23
47311M30D10	30	- 18	51881M30D10	33	- 6	58711-13201	38	- 10
47341M30D99A	29	- 6	51882M30D10	33	- 7	58721-35400	38	- 12
47341M31C00B	29	- 1	53111M30D10	34	- 1	58722-03011	38	- 11

PART NO.	FIG. NO.	REF. NO.	PART NO.	FIG. NO.	REF. NO.	PART NO.	FIG. NO.	REF. NO.
60000						90000		
61100M31C20A	39	- 1	95700-31C00	28	- 26	02112-05163	15	- 38
61211-31C00	39	- 3	95721M30D00B	28	- 17	02112-05163	4	- 14
61273M31C10	39	- 7				02112-06103	14	- 19
61311M31C00A	41	- 1				02112-06123	19	- 2
61375M31C20A	41	- 13				02112-06163	19	- 6
61410-35500	42	- 29				02112-06163	13	- 21
61420M31C20	42	- 30				02112-06203	18	- 5
62100M30D00B	39	- 14				02112-06253	4	- 4
63112M30D99B	41	- 17				02112-06303	4	- 27
63112M31C00D	41	- 3				02112-06303	4	- 19
6311M30D10	41	- 4				02112-06303	3	- 9
63120M31C00A	41	- 5				02112-06353	4	- 5
64110M35300	42	- 1				02112-06353	12	- 7
64210M46005	42	- 2				02112-06353	3	- 4
64311M31C10	39	- 8				02112-06403	4	- 20
64451-43020	42	- 9				02112-06403	3	- 5
64511M31C40	42	- 25				02112-06503	3	- 6
64541-30D00	42	- 26				02112-06503	4	- 6
64611M01001	42	- 19				02112-06503	4	- 21
64651M01001	42	- 18				02112-06553	4	- 7
64711-31C20	42	- 12				01104M06166	34	- 3
64712M20900	42	- 34				01104R04206	21	- 8
64721M35500	42	- 23				01107M06235	16	- 15
64731M31C20	42	- 13				01421-06208	2	- 4
64733-43000	42	- 20				01500-06123	16	- 10
65110M31C00A	42	- 36				01500-06123	34	- 3
65311M46730	42	- 35				01500-06303	15	- 12
65320M03021	42	- 39				01500-08127	4	- 10
68131M30D99A / B	43	- 5				01500-10163	3	- 12
68190M30D99A / B	43	- 2				01517M06105	41	- 2
68280M30D99A	43	- 3				01517M08163	28	- 22
68310M30D99A	43	- 1				01517M08283	28	- 19
68320M30D99A	43	- 4				01547-06253	1	- 28
						01550-06163	27	- 8
						01550-06163	26	- 8
						01550-06163	23	- 5
						01550-06203	1	- 17
						01550-06253	1	- 12
						01550-08123	11	- 5
						01550-08163	25	- 10
						01550-08353	11	- 10
						01550M06163	28	- 21
						01550M06163	22	- 13
						01550M06163	41	- 11
						01550M06163	29	- 2
						01550M10353	39	- 16
						01570-06203	11	- 2
						01570-08163	23	- 10
						01570-08307	32	- 19
						02112-05103	18	- 4
						02112-06103	22	- 17
						02142-06103	18	- 16
						02142-06126	30	- 19
						02142M05123	30	- 21
						02142M05125	36	- 3
						02142M06087	11	- 14
						02142M06163	30	- 23
						02142M06163	30	- 8
						02142M06167	33	- 3
						02142M06167	33	- 8

REF. NO.	PART NO.	FIG. NO.	REF. NO.	PART NO.	FIG. NO.	REF. NO.	PART NO.	FIG. NO.	REF. NO.
38	02142M06205	31	5	08316-10063	2	5	09108-08172	2	3
14	03241-05163	30	5	08316-10063	42	11	09111-06001	28	7
19	03511M04163	22	8	08316-10063	35	12	09111-06041	15	18
2	03541-04163	20	11	08316-10123	18	7	09111-06053	7	4
6	03541-05203	36	4	08316-20063	28	5	09111-08Q16	39	11
21	03541M04163	36	5	08316-20063	28	10	09116-06167	41	10
5	03541M04168	33	11	08316-20063	28	14	09116-06168	41	7
4	03541M14123	30	6	08316M10053	22	15	09116M10022	39	15
27	03541M14123	30	7	08316M10063	37	11	09125-05065	38	6
19	04111-16208	13	34	08319-21055	38	5	09125-05065	38	14
9	04111-20158	25	20	08319-31083	11	11	09125-06100	31	10
5	04111-20208	40	10	08319-31105	3	15	09126-06049	1	24
7	04111-20208	39	10	08319-31107	35	13	09136-06009	31	11
4	04111-30308	40	4	08319-31128	42	24	09136-06017	10	12
20	04211-09109	15	14	08321-01103	25	25	09140-06023	1	29
5	04211-09129	4	17	08321-01123	37	3	09140-08008	39	9
6	04211-09129	12	8	08321M01063	11	13	09140-08019	13	37
6	04211-11129	1	5	08321M01063	11	17	09140-10043	25	14
21	04211-11129	2	7	08322-01053	40	9	09140-10043	25	22
7	04211-13189	3	2	08322-01063	28	16	09140-16025	13	25
7	04211-13189	4	3	08322-01083	42	31	09140M10043	25	24
18	04221-03059	5	13	08322-01083	39	12	09148-05504	22	9
4	05013M04109A	41	16	08322-01107	39	4	09150-05101	37	18
5	06111-06003	32	23	08322M01123	37	4	09150-06009	40	8
9	07120-06203	8	11	08322M21108	39	17	09159-08049	1	6
4	07130-06123	6	12	08322R21047	21	9	09160-05001	35	19
27	08110-62030	14	8	08331-31136	6	5	09160-06039	28	12
16	08110-62030	14	17	08331-31156	35	18	09160-06114	26	6
20	08113M62017	42	17	08331-31166	14	23	09160-08032	11	8
13	08113M62037	42	21	08331-31216	13	17	09160-08039	1	8
17	08123M62007	35	25	08331-31346	13	9	09160-08092	13	38
25	08143M62017	42	16	08331-41286	5	11	09160-13006	14	5
7	08143M63007	35	23	08332-11063	12	6	09160-13006	14	13
4	08143M63017	42	14	08341-31039	18	8	09160-13010	6	4
5	08211-06121	15	19	08361-35066	28	8	09160-14054	35	8
17	08211-06221	15	15	09100-05019	12	12	09160-14054	42	8
16	08211-08141	12	15	09100M06091	15	32	09160-15002	40	3
19	08211-12261	15	28	09100M10007	25	3	09160-16005	35	17
21	08211-14221	16	11	09100M12061	37	2	09160M10048	25	12
3	08211-14321	16	12	09103-06045	35	11	09160M30D99A	30	9
14	08211-20264	15	29	09103-06045	42	10	09160M30D99A	30	24
23	08310-00063	26	9	09103-06143	1	20	09160M30D99A	22	10
8	08310-00083	42	28	09103-06144	1	21	09162-08008	39	13
3	08310-00083	42	33	09103-10087	3	14	09162-08008	42	3
8	08310-00107	39	6	09108-08171	2	2	09162-10008	39	5

PART NO.	FIG. NO.	REF. NO.	PART NO.	FIG. NO.	REF. NO.	PART NO.	FIG. NO.	REF. NO.
09164-16004	13	26	09181-25061	5	18-11	09285-12002	15	17
09166-24001	32	26	09181-25061	5	18-13	09285-14001	16	7
09168-06004	1	22	09181-25062	5	18-12	09285-25003	42	22
09168-06004	8	5	09200-07005	13	32	09285-43001	35	22
09168-08015	4	11	09200M06033	25	19	09287M07002	37	16
09168-08016	2	11	09209-05011	15	35	09287M07002	37	20
09168-08021	1	7	09209-10001	37	17	09289-05008	7	18
09168-10002	3	13	09209-11002	40	7	09319-10009	39	2
09168-12002	4	23	09247-12104	4	22	09320-08028	33	5
09169-05012	30	22	09259-26011	4	24	09320M08028	30	17
09169-06010	33	4	09261-02008	12	4	09320M08048	22	12
09169-06041	29	3	09261-04002	15	10	09320M09026	30	11
09169-06041	29	5	09261-04012	15	11	09320M09026	31	13
09169-06060	41	9	09261-05009	7	6	09320M10022	26	10
09169-06060	34	4	09261-07006	13	7	09320M12058	11	9
09169-06060	41	9	09261-10033	6	8	09321-06013	22	18
09169M06071A	31	12	09261-12001	5	10	09321M10001	25	7
09169-08046	13	31	09262-15026	7	1	09321M14005	28	2
09169M06052	31	13	09262-17037	7	20	09352-40703-600	9	32
09169M06071A	30	20	09262-25117	5	8	09352-50823-360	27	6
09169M06071A	31	6	09262-35021-OA0	5	7	09352-50823-550	27	7
09169M08011	42	27	09263-12019	15	26	09354-25703-600	9	19
09180-06035	28	13	09263-13001	14	6	09359-50822-600	27	4
09180-06069	37	10	09263-13001	14	14	09359-50823-600	3	10
09180-06086	15	4	09263-25040	6	7	09360-08012	2	10
09180-06169	26	7	09263-28029-0B0	5	4	09380-17007	14	16
09180-12036	15	25	09266-16002	13	39	09380-17007	14	7
09180-16045	13	6	09280-08012	13	40	09380-17010	13	22
09180M06011A	30	10	09280-10015	12	2	09380-25010	6	11
09180M06011A	31	14	09280-14011	35	6	09380-10004	1	3
09180M06082	29	4	09280-14011	42	6	09381-14001	5	17
09180M06089	33	9	09280M15007	32	13	09401-08401	27	2
09180M06248	22	11	09280-15014	2	8	09401-10403	27	5
09180M10091	35	24	09280-17003	4	9	09401-11101	10	9
09180M12084	42	15	09280-21008	15	36	09401-13409	10	11
09181-25051	5	18-1	09280-22008	4	25	09402-40306	10	7
09181-25052	5	18-2	09280-24005	1	27	09404-06429	23	2
09181-25053	5	18-3	09280-24006	9	31	09404-06429	1	23
09181-25054	5	18-4	09280-25004	17	5	09404-06429	19	5
09181-25055	5	18-5	09280-40004	13	19	09407-08401	3	11
09181-25056	5	18-6	09280-50007	1	11	09407-25401	23	3
09181-25057	5	18-7	09280-84002	1	16	09408-00002	37	24
09181-25058	5	18-8	09280-20005	5	9	09440-02003	13	8
09181-25059	5	18-9	09283-17025	14	15	09440-03004	6	9
09181-25060	5	18-10	09284-15001	35	26	09440-04010	15	37

5

